





Hilsons are pleased to present a lovely three bedroom apartment within an ideally located location in the sought after area of Isleworth, TW7! The property comprises a spacious hallway, three well sized bedrooms, large living room, kitchen and family bathroom. There is private parking available with residents first come first serve parking, double glazing, and communal gardens. Local shops and amenities are close by. Within easy reach is West Middlesex Hospital, Hounslow and Osterley Underground and West Thames College. A Brilliant Opportunity for Commuters, First-Time Buyers and Investors!!! Viewings Highly Recommended!! Call us NOW to BOOK! Not to be missed!

Brilliant Three bedroom apartment, chain-free, short walk of Isleworth Station!

Off street private parking available, double glazing and communal gardens.

Local shops and amenities are close by

West Middlesex Hospital, Hounslow and Osterley Underground, and West Thames College are within easy

A brilliant Opportunity for Commuters, First-time Buyers and INVESTORS!!!



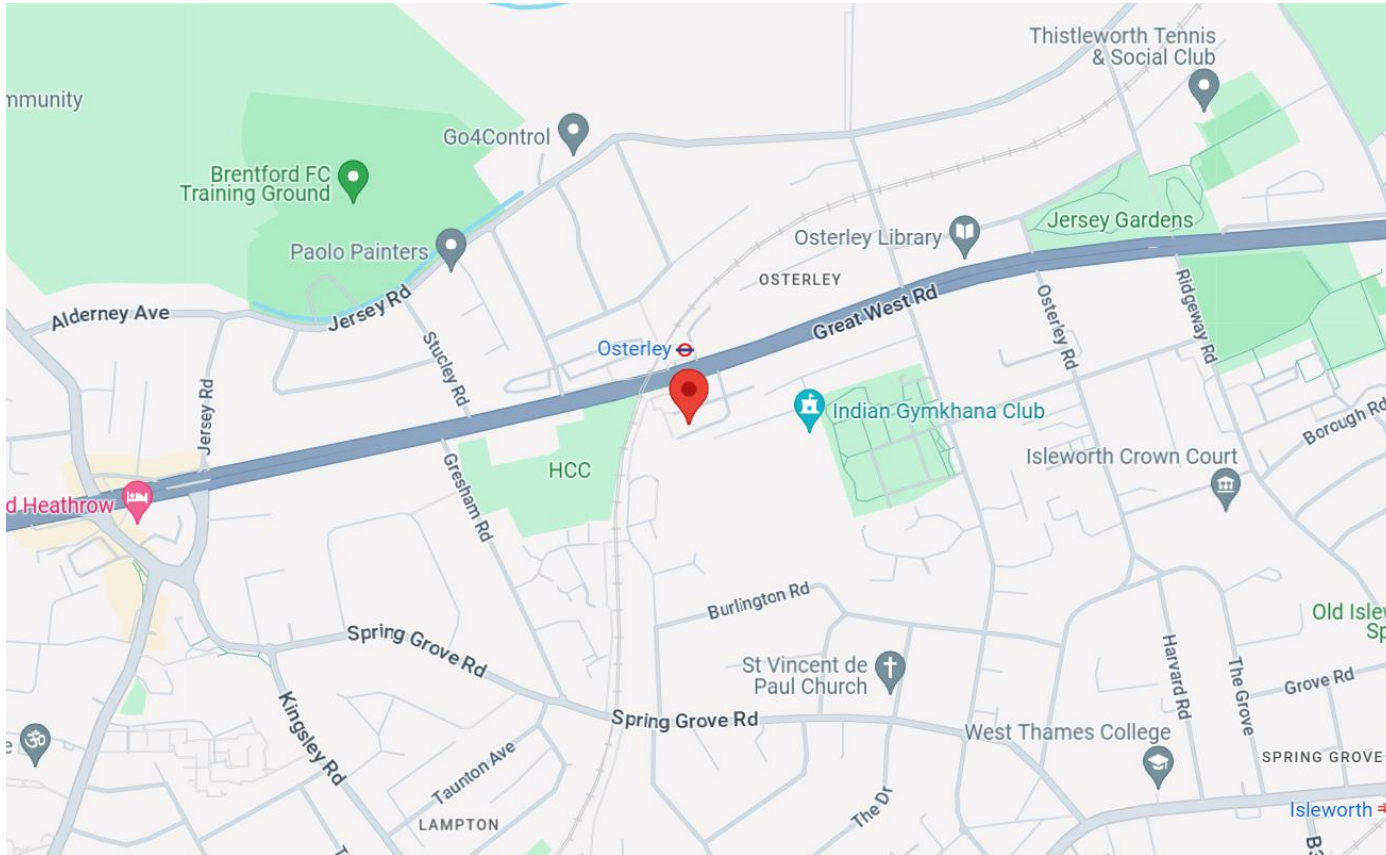

Osterley Ct, Great West Rd, Isleworth TW7 4PY

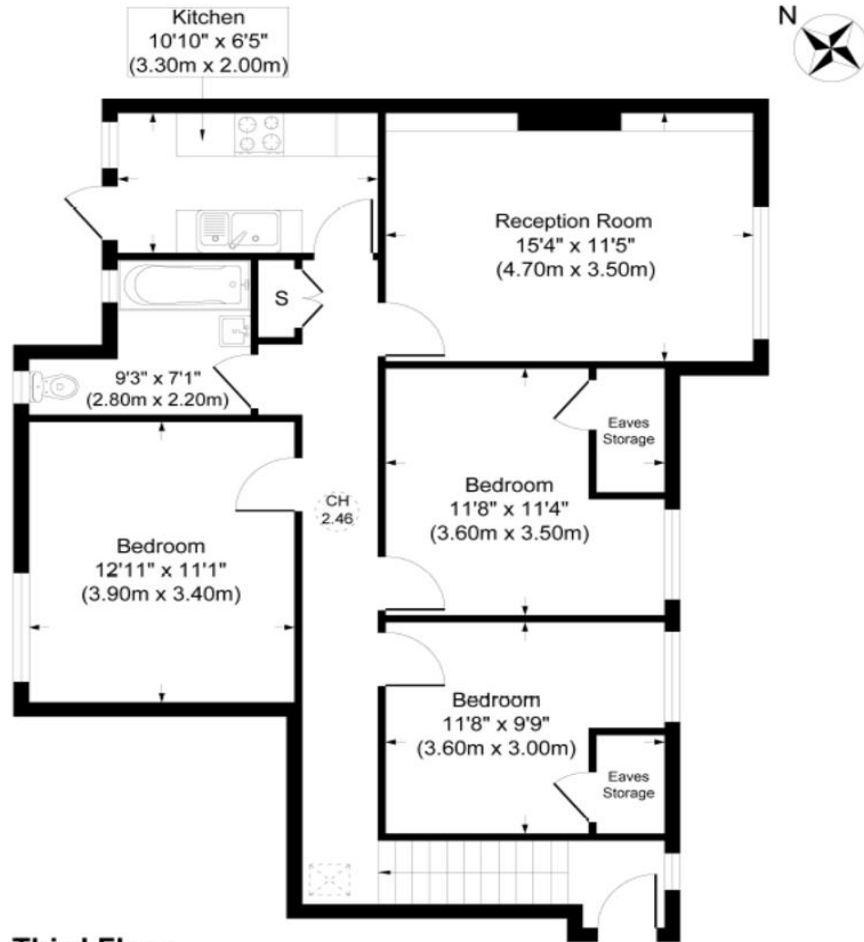

Third Floor

Approx. Gross Internal Floor Area 863.79 sq. ft / 80.24 sq. m

Illustration for identification purposes only, measurements are approximate, not to scale
Produced by www.Rahuljora.co.uk

