



UNIT 12/13

Meridian Trading Estate, Bugsby Way, Charlton, SE7 7SJ

Prominent warehouse/trade counter with rear loading and forecourt parking.

6,853 SQ FT

FOREST
REAL ESTATE

Summary

Available Size	6,853 sq ft
Rent	£123,500 per annum
Rates Payable	£33,792 per annum
Service Charge	The occupier will make a contribution for the upkeep and maintenance of the estate.
EPC Rating	C (51)

Key Features

- Concertina loading door
- Open plan unrestricted warehouse
- Adjacent to Howdens
- Ceiling heights up to 6.9m
- Available now

Description

The property comprises a modern mid terraced trade counter/warehouse formally occupied by a tile showroom. The unit is of steel portal frame construction under a pitched offering a 5m eaves height rising to 6m at the rear.

There is a loading door at the rear of the property. Additional benefits include gas and 3 phase power.

Externally there is parking directly to the front of the property and loading and unloading at the rear.

Location

Meridian Trading Estate occupies a prominent position off Bugsby's Way and close to the junction with Anchor and Hope Lane.

The estate has excellent road networks to Canary Wharf and The City via The Blackwall Tunnel Approach (A102) as well as South Circular Road (A205), A2 and A20 which link to the M25 London Orbital.

Charlton Mainline and North Greenwich Stations are easily accessible from the property. Woolwich Ferry is conveniently situated only a short distance to the east.

Local occupiers include Primark, Aldi, Howdens, Halfords, Magnet, Topp Tiles, Kwik Fit and Selco to name a few.

VAT

Plus VAT.

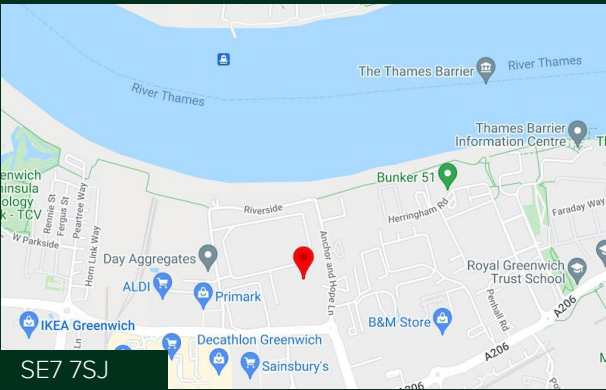

Viewing & Further Information

Zach Forest

020 3355 1555 | 07890 209 397
zach@forestrealestate.co.uk

CONNECT WITH US

1 Bridge Lane, London, NW11 0EA
020 3355 1555
info@forestrealestate.co.uk
www.forestrealestate.co.uk

F O R E S T
REAL ESTATE

The above information contained within this brochure is subject to contract. These particulars are for general information only and do not constitute any part of an offer or contract. All statements contained therein are made without responsibility on the part of the vendors or lessors and are not to be relied upon as statement or representation of fact. Intending purchasers or lessees must satisfy themselves, by inspection, or otherwise, as to the correctness of each of the statements of dimensions contained in these particulars. Generated on 01/12/2022

Meridian Trading Estate

Approximate Gross Internal Area = 6853 sq ft / 636.7 sq m

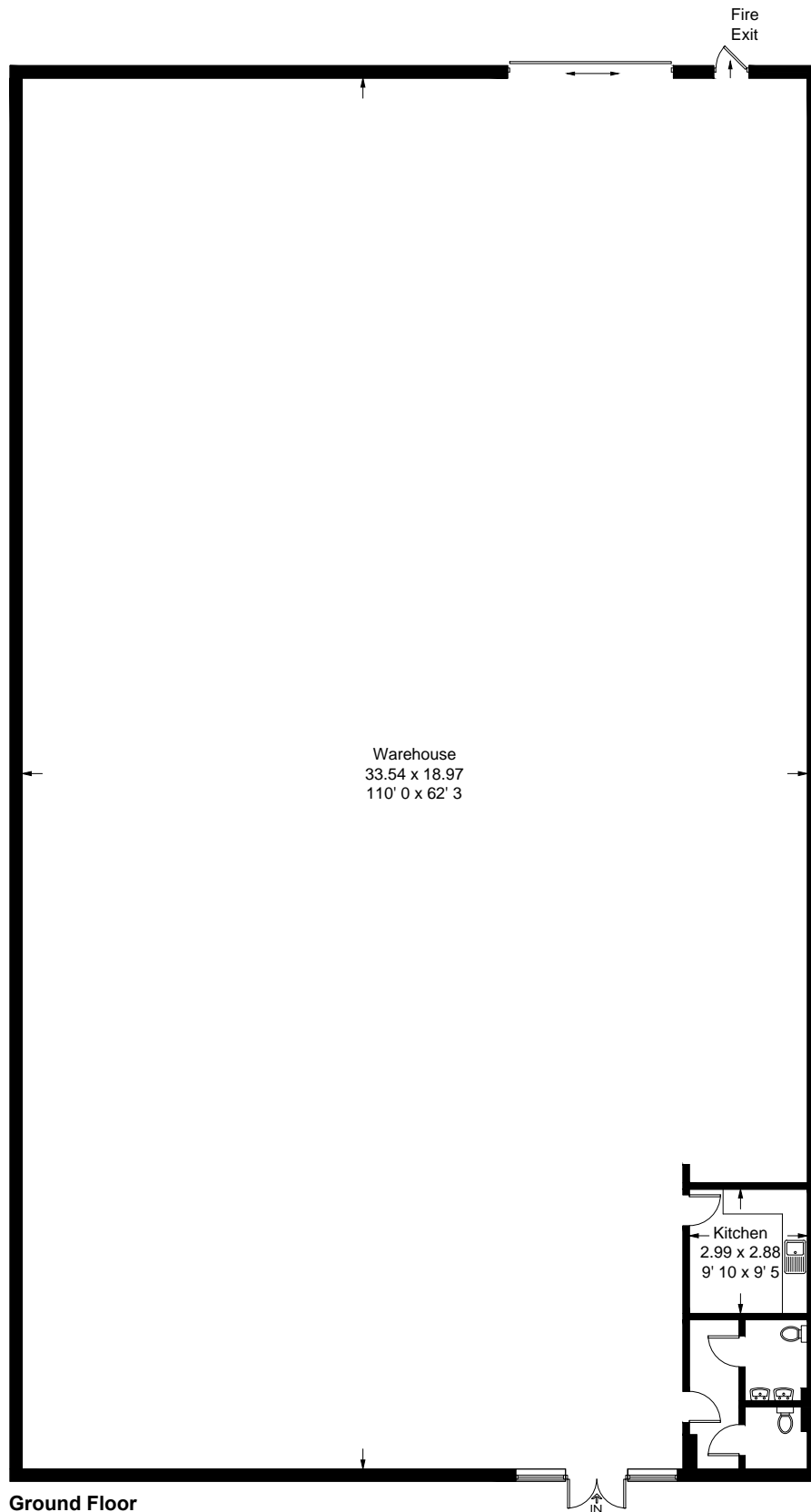

This plan is not to scale and must be used as layout guidance only. All measurements and areas are approximate and should not be relied upon to provide accurate information. This plan must not be relied upon when making property valuations, design considerations or any other such relevant decisions. We accept no responsibility or liability (whether in contract, tort or otherwise) in relation to any loss whatsoever arising from or in connection with any use of this plan or the adequacy, accuracy or completeness of it or any information within it.