



1

Bedroom



1

Bathroom





*****NO CHAIN - FIRST TIME BUYER - BTL - INVESTMENT*****

Trading Places are proud to welcome to the market this ground floor apartment for sale with your own FRONT DOOR, located in an ideal location close to local amenities and transport links. The property briefly comprises of a large lounge, LARGE DOUBLE BEDROOM, kitchen with separate dining area, three piece bathroom. Externally there is a low maintenance garden accessed from the kitchen and allocated parking to the rear of the flat.

GROUND FLOOR
616 sq.ft. (57.2 sq.m.) approx.

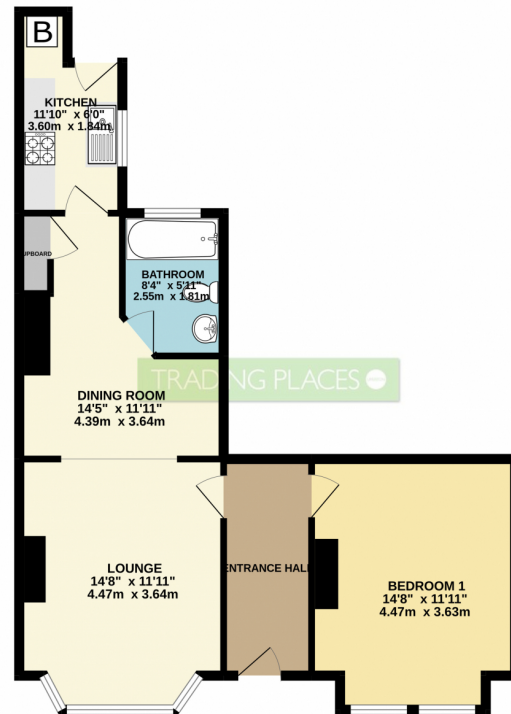

TOTAL FLOOR AREA: 616 sq.ft. (57.2 sq.m.) approx.

Whilst every attempt has been made to ensure the accuracy of the floorplan contained here, measurements of doors, windows, rooms and any other items are approximate and no responsibility is taken for any error, omission or mis-statement. This plan is for illustrative purposes only and should be used as such by any prospective purchaser. The services, systems and appliances shown have not been tested and no guarantee as to their operability or efficiency can be given.
Made with MemoPro 12/22

