



TREFORIS

Andrew Pearce
PINNER

SOUTHBOURNE CLOSE, PINNER, HA5 5BA £650,000



A unique detached bungalow occupying one of the largest plots in the locality. The property is rich with 1930's character and features extended accommodation to the ground floor and loft space, providing spacious living areas, along with four bedrooms, additional bath / shower rooms and self contained outbuildings.

The accommodation comprises: Entrance porch, hallway, leading through to a spacious front aspect living room. The ground floor also consists of a main double bedroom, two further bedrooms, and additional reception room, a bathroom / W.C. in addition to a separate W.C. and a fitted kitchen.

A further room has been created from the original loft space which could ideally be used as a further bedroom or home office.

Outside, the property features an adjoining self contained annexe, featuring a large living room, kitchen bedroom and shower room. It is quite feasible that the adjoining annexe could be re-configured to form part of the main residence. A further brick outbuilding is located to the rear. The substantial plot to the rear provides considerable scope to extend further subject to planning approval and is laid to lawn, set against a backdrop of mature trees with gated access to streamside walk green open space and woodland.



To the front, the private driveway provides off street parking for three cars and access to the garage.

The location is highly sought after, being within the catchment of Cannon Lane and Pinner High Schools and the property is well served by the stations at Eastcote, Pinner and Rayners Lane.

Chain free sale.

SOUTHBOURNE CLOSE, PINNER, HA5 5BA

TOTAL FLOOR AREA : 1998 sq.ft. (185.7 sq.m.) approx.

Whilst every attempt has been made to ensure the accuracy of the floorplan contained here, measurements of doors, windows, rooms and any other items are approximate and no responsibility is taken for any error, omission or mis-statement. This plan is for illustrative purposes only and should be used as such by any prospective purchaser. The services, systems and appliances shown have not been tested and no guarantee as to their operability or efficiency can be given.
Made with Metropix ©2022

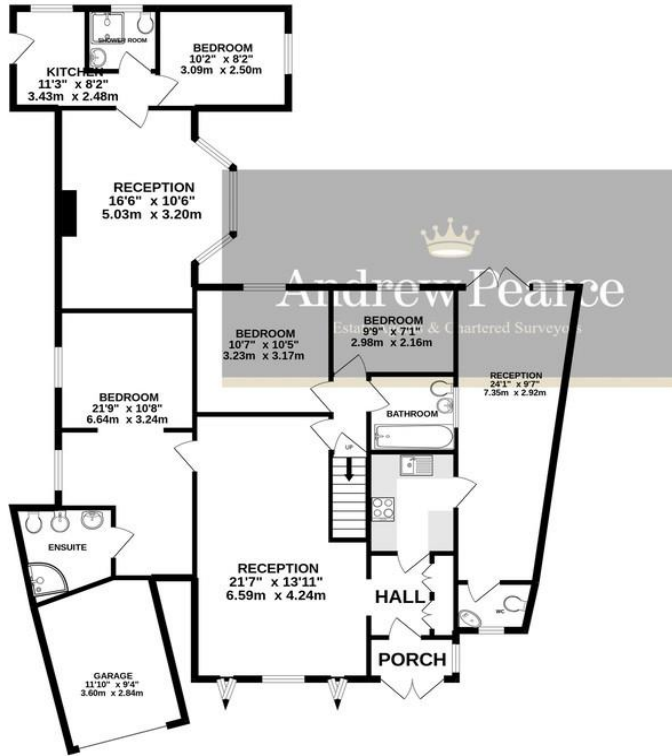

GROUND FLOOR
1783 sq.ft. (165.6 sq.m.) approx.

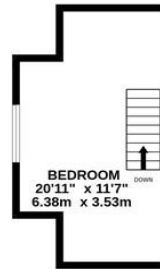

1ST FLOOR
215 sq.ft. (20.0 sq.m.) approx.



