



we are
morfittsmith

**Bickerton House,
Hillsborough,
Sheffield,
S6 1SY**



An outstandingly bright penthouse apartment located at the heart of the hugely popular community of Hillsborough: Bickerton House.

This modern apartment really makes the most of its enviable position with a Juliet balcony, superb views and broad rooms to enjoy the light.





Time to explore.

Bickerton House enjoys all of the vibrance and excitement that the beloved community of Hillsborough has to offer. There are a vast range of amenities and entertainments in the heart of the area, including the Sheffield Wednesday stadium, the magnificent green spaces of Hillsborough Park, many well-known shopping chains, and countless local businesses. Located just down the road from the Leppings Lane SuperTram stop, and closer still to the hugely convenient Penistone Road, Bickerton House would be an ideal hub for exploring the many delights of Sheffield. You even have your own allocated parking space within the building's rear courtyard.

Step inside your new home.

Thanks to its spectacular penthouse positioning in the building, Bickerton House enjoys an incredible vista, looking out toward the hills, over the top of its neighbours. This height also affords it an outstandingly bright atmosphere, particularly in the two bedrooms at the rear elevation which catch the most sun. The master bedroom even boasts its own Juliet Balcony. At the end of the entrance hall is a full bathroom and a storage cupboard. To the front of the home you will find a sizeable living space and connected kitchen, with large windows to the front, and smart laminate wood flooring. In its prime location, Bickerton House is an attractive, modern home with a huge capacity to cater for a myriad of lifestyles.







643 sq.ft. (59.7 sq.m.) approx.

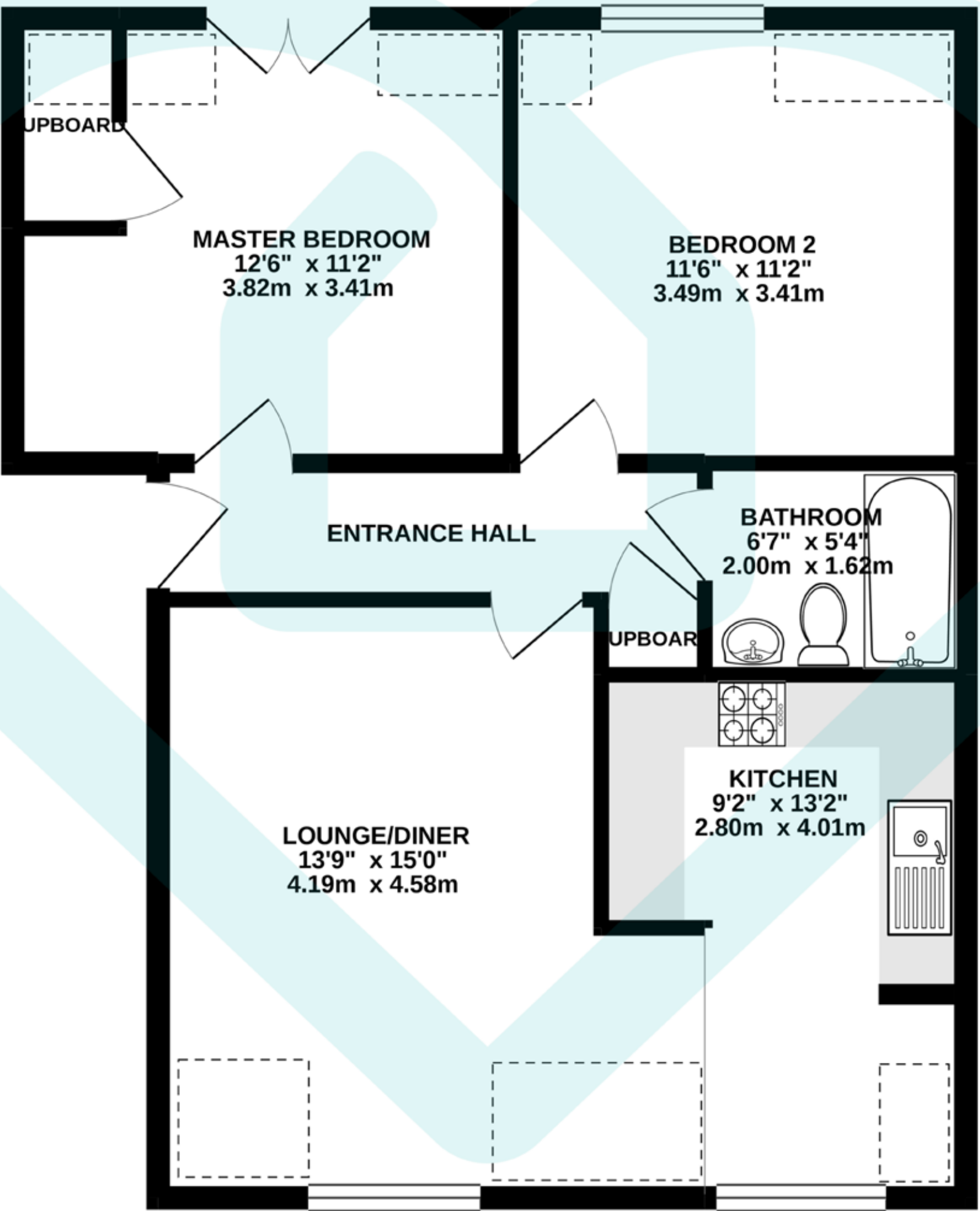

Whilst every attempt has been made to ensure the accuracy of the floor plan contained here, measurements of doors, windows, rooms and any other items are approximate and no responsibility is taken for any error, omission or mis-statement. This plan is for illustrative purposes only and should be used as such by any prospective tenant/ purchaser.

Score	Energy rating	Current	Potential
92+	A	80 C	82 B
81-91	B		
69-80	C		
55-68	D		
39-54	E		
21-38	F		
1-20	G		

IMPORTANT: we would like to inform prospective purchasers that these sales particulars have been prepared as a general guide only, A detailed survey has not been carried out, nor the services, appliances and fittings tested. Room sizes should not be relied upon for furnishing purposes and are approximate. If floor plans are included, they are for guidance only and illustration purposes only and may not be to scale. If there are any important matters likely to affect your decision to buy, please contact us before viewing the property.



The MorfittSmith Building,
67 Middlewood Road,
Sheffield, S6 4GX



0114 232 1764



www.morfittsmith.co.uk



sales@morfittsmith.co.uk



lettings@morfittsmith.co.uk



newhomes@morfittsmith.co.uk



@morfittsmith



@morfittsmith



MorfittSmith Estate & Letting Agent



morfittsmith



sales | lettings | new homes
