

£165,000

Windsor Gardens, Somersham, Huntingdon PE28 3DZ



To arrange a viewing call us now on 01354 694900

This one bedroom property has spacious living room and good size kitchen, double bedroom and bathroom.

Outside, there is a fully enclosed rear garden plus an allocated parking space.

Ground Floor

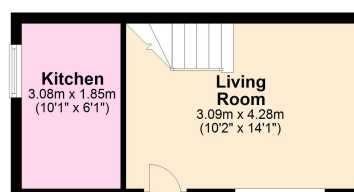

First Floor

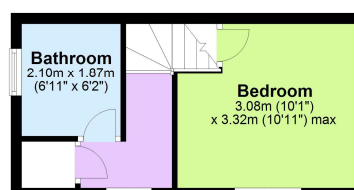

£165,000

Windsor Gardens, Somersham, Huntingdon PE28 3DZ



GROUND FLOOR

LIVING ROOM

4.28m (14'1") x 3.09m (10'2")

Entrance door leading in, window to front, stairs rising to first floor.

KITCHEN

3.08m (10'1") x 1.85m (6'1")

Fitted with a matching range of wall and base units with freestanding cooker, plumbing for washing machine and space for fridge/freezer. Window to side.



FIRST FLOOR

LANDING

Window to front, boiler cupboard.

BEDROOM

3.32m (10'11") max. x 3.08m (10'1")

Window to front.



BATHROOM

Fitted with a panelled bath which has electric shower over, low level WC and hand wash basin. Window to side.

OUTSIDE

There is a fully enclosed garden which is laid mainly to lawn with shrub borders and paved patio area. There is one allocated parking space.



SERVICES

Mains gas, electricity, water and drainage. The property has gas fired central heating.

TENURE

Freehold

VIEWING

By arrangement with elliswinters&co



Energy rating - C

Huntingdonshire District Council tax band - A

Ellis Winters & Co 20 Market Hill, Chatteris, Cambridgeshire, PE16 6BA
Tel: 01354 694900 Email: info@elliswinters.co.uk www.elliswinters.co.uk