



King Street, Covent Garden, London, WC2E 8HN
£875,000

> 1 Bedroom > 1 Bathroom

TAVISTOCKBOW
RESIDENTIAL



- › One bedroom apartment
- › First floor
- › High ceilings
- › Sought after location
- › South facing over gardens
- › Very quiet
- › Open plan kitchen reception
- › Modern conversion
- › Large sash windows
- › Close to Covent Garden Piazza

A beautiful one bedroom lateral apartment situated on the first floor of this handsome period building on King Street, overlooking St Pauls Church Gardens, one of Covent Garden's most sought after views. The apartment is flooded with natural light through the beautiful south facing, full height sash windows and features an open plan kitchen to the main living area.

King Street is one of Covent Garden's most sought after addresses, being one of the part-pedestrianised streets that serve the Piazza. The ongoing transformation in recent years sees the street lined with a number of fashion boutiques, luxury retailers, top eateries and more recently the much lauded arrival of Petersham Nurseries with its fabulous store,

delicatessen and La Goccia & Petersham restaurants in the newly created Floral Court. Other nearby favourites include; Clos Maggiore, Oystermen, The Henrietta, Frenchie, and the recently opened Avobar. There are a number of transport options – Covent Garden (Piccadilly Line), Leicester Square (Piccadilly & Northern lines), Charing Cross (main line train, Northern & Bakerloo lines).





WHAT WE LOVE

Beautiful view over gardens
Period sash windows
Superb location
Covent Garden's premier address
Great retail amid restaurants on your door step.

WHAT YOU NEED TO KNOW

Fist floor (with lift)
Share of freehold
Zero Ground rent
Service charge of £3,141 per year
Westminster City Council band E.



Floorplan

King Street, WC2

Approximate Gross Internal Area 35 sq m / 376 sq ft

First Floor

1 Kitchen /
Reception /
Dining Room
4.94 x 5.27M
16'2" x 17'3"

2 Bedroom
2.66 x 2.66M
8'7" x 8'7"

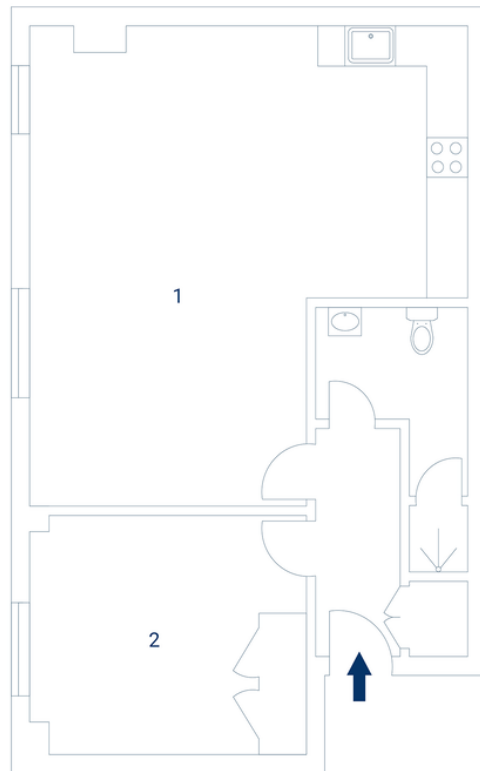

Floorplan produced for Tavistock Bow. Illustration for identification purposes only and not to scale. All measurements are approximate and not to be relied upon.

EPC

Score	Energy rating	Current	Potential
92+	A		
81-91	B		
69-80	C		
55-68	D		64 D
39-54	E	44 E	
21-38	F		
1-20	G		

About Us

Tavistock Bow is an independent residential agency based in Covent Garden. We are niche, boutique, creative, knowledgeable, professional and approachable. We love what we do and that's why we do it.

Contact Us

- a.** 21 New Row, Covent Garden, WC2N 4LE
- t.** 020 7477 2177
- e.** hello@tavistockbow.com
- w.** tavistockbow.com

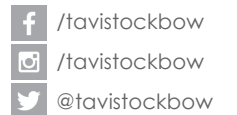

TAVISTOCKBOW
RESIDENTIAL