



25
YEARS

SERVING
BEACONSFIELD
SINCE 1998



43 Wattleton Road, Beaconsfield

Guide Price £1,225,000

Ashington Page

NO CHAIN! Extended, family home in the sought after Butlers Court and Grammar school catchment areas with light, bright and spacious accommodation. The property benefits from having an attached annex with it's own front door, perfect for relatives, teenagers or even as an AirBNB. The property is within walking distance to the local schools and the array of boutique shops, restaurants and bars of Beaconsfield Old Town and enjoys uninterrupted views over the small wood opposite.

Tenure: Freehold

EPC rating: C

Directions: Sat Nav HP9 1RY

Council Tax: Buckinghamshire Council G

These particulars are for guidance only. They are prepared and issued in good faith and are intended to give a fair summary of the property. Any description should not be relied on as a statement or representation of fact or that the property, or its services, are in good condition. The photographs show only certain parts of the property at the time they were taken. Any areas, measurements or distance given are approximate only. Any reference to alterations to, or use of, any part of the property is not a statement that any necessary planning, building regulations or other consent has been obtained. These matters must be verified by an intending purchaser. All statements contained in these particulars in relation to the property are made without responsibility of Ashington Page or its clients. Neither Ashington Page (nor any joint agents) nor any of their employees has any authority to make or give any representation or warranty whatsoever in relation to the property

Cornerstone, 43 Wattleton Road

Approximate Gross Internal Area
 Ground Floor = 114.9 sq m / 1,237 sq ft (Excluding Annex)
 Annex = 15.7 sq m / 169 sq ft
 First Floor = 55.5 sq m / 597 sq ft
 Total = 186.1 sq m / 2,003 sq ft

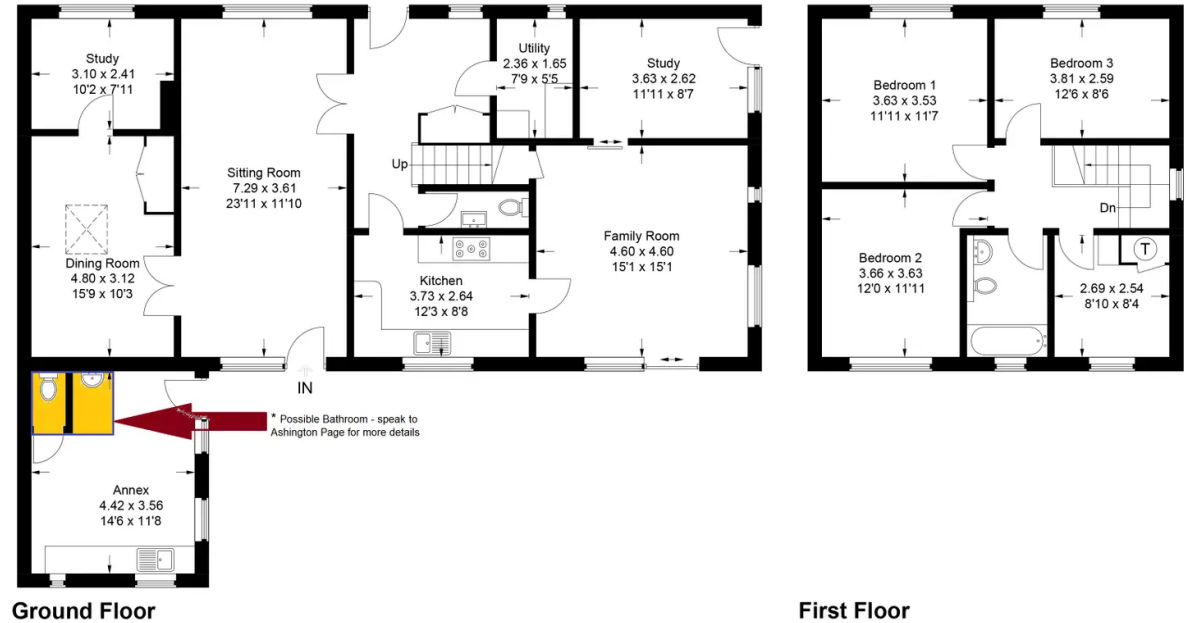

This plan is for layout guidance only. Not drawn to scale unless stated. Windows and door openings are approximate. Whilst every care is taken in the preparation of this plan, please check all dimensions, shapes and compass bearings before making any decisions reliant upon them.
 © CJ Property Marketing Ltd Produced for Ashington Page



01494 680018
info@ashingtonpage.co.uk
www.AshingtonPage.co.uk

