

# THE CLUB

UPPER RIVERSIDE

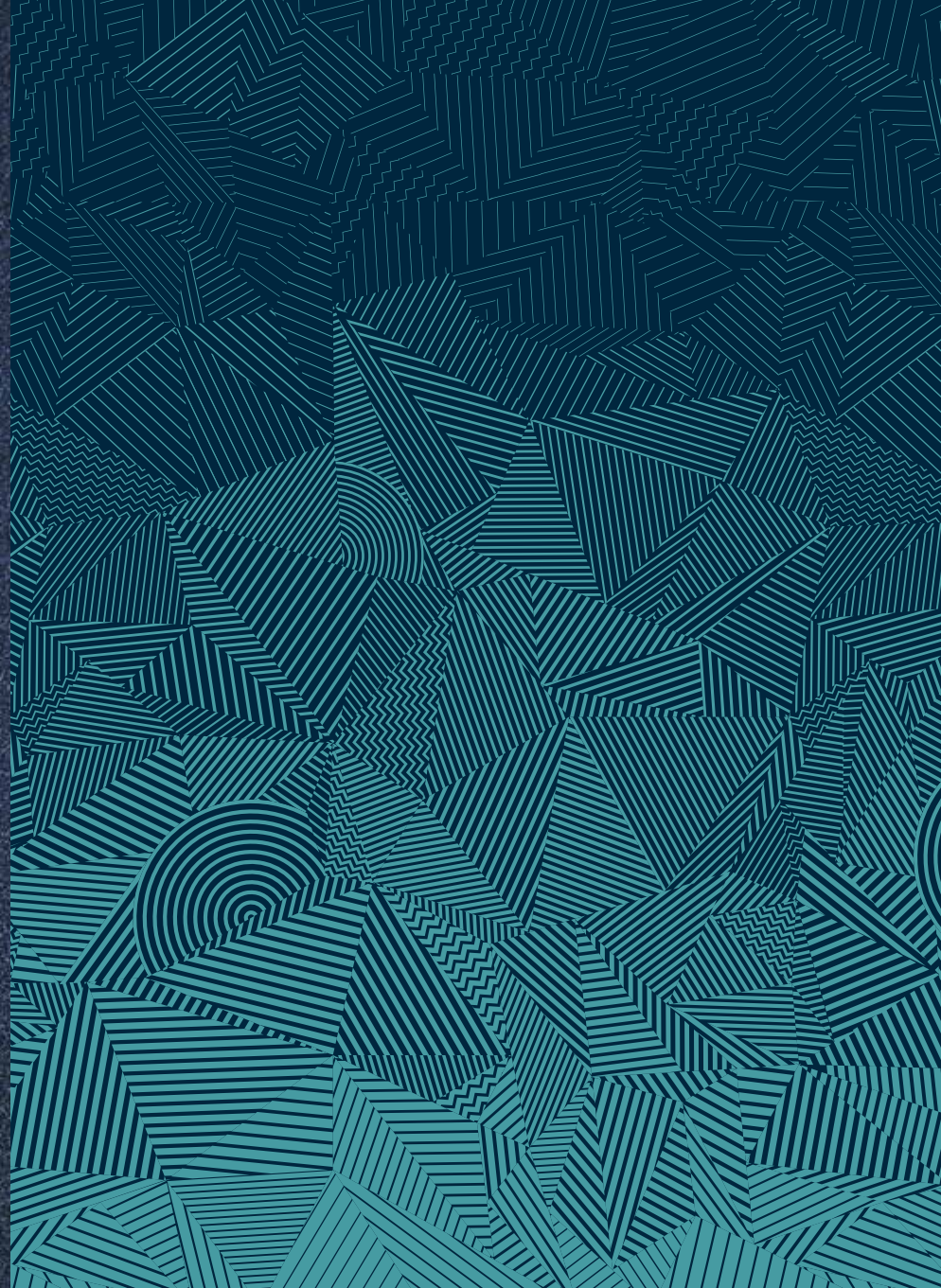

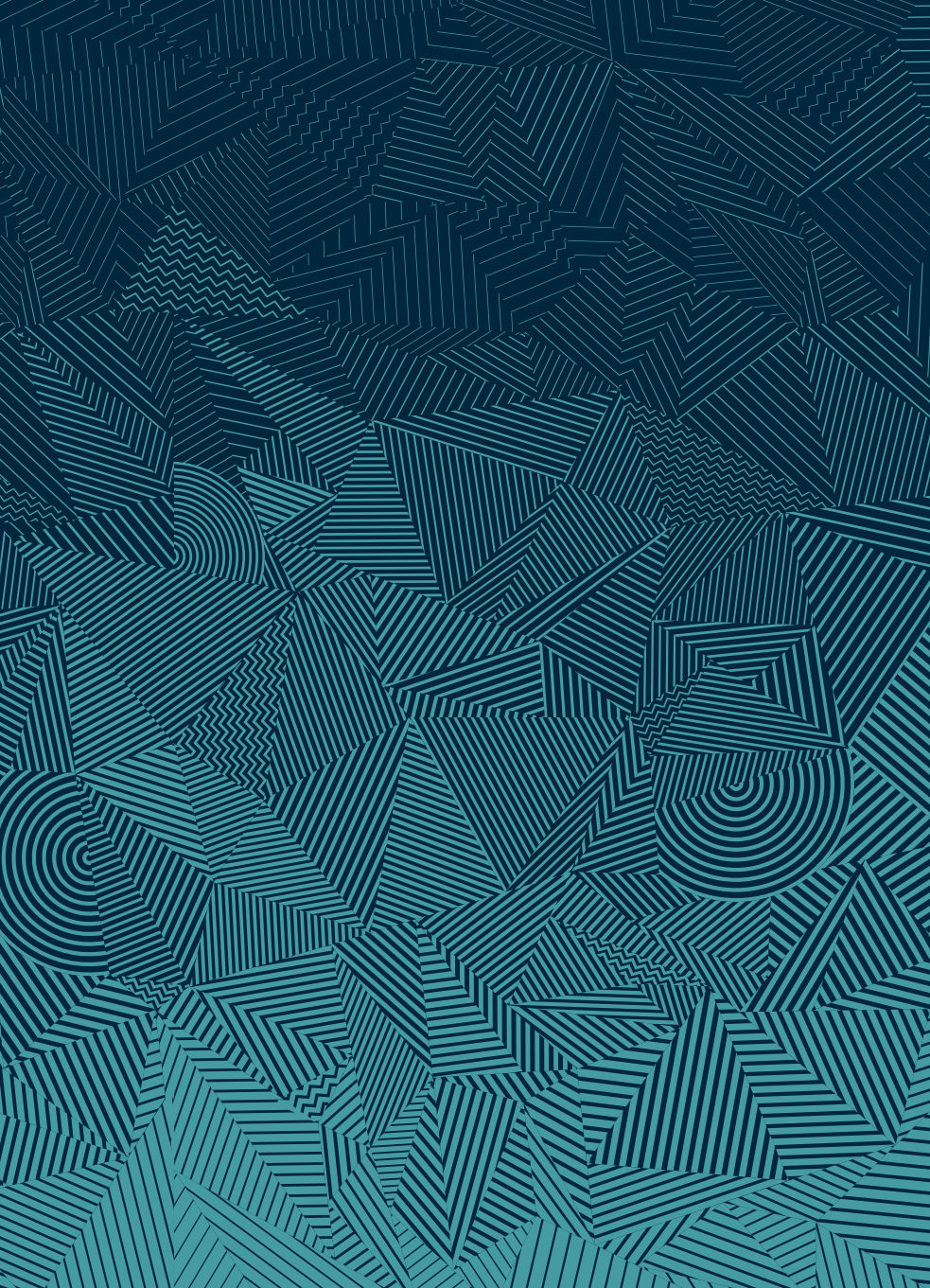

THE CLUB

2

COMMUNAL SPACES

6

THE RENEW FLOOR

8

CINEMA & GAMES ROOM

14

THE ROOFS

16

CONCIERGE

20

THE LOBBIES

22

THE PRIVATE ROOMS

24

THE PENINSULA CULTURAL PATH

26

THE RIVERSIDE

28



MEETING AREAS



RENEW FLOOR



CO-WORKING



DINING ROOM



SKY VIEW TERRACES



LIBRARY



LOUNGES



CINEMAS

# THE CLUB

Think of Upper Riverside as a relaxed, unstuffy and welcoming members' club. Living here means exclusive access to gyms, a pool, rooftop terraces, shared spaces and more. There's space to meet your neighbours and be part of a community.



From the outside each of Upper Riverside's five towers share an architectural relationship, they're part of a family. Inside though a select band of the best interior designers have been commissioned to create inspiring environments specific to each building.

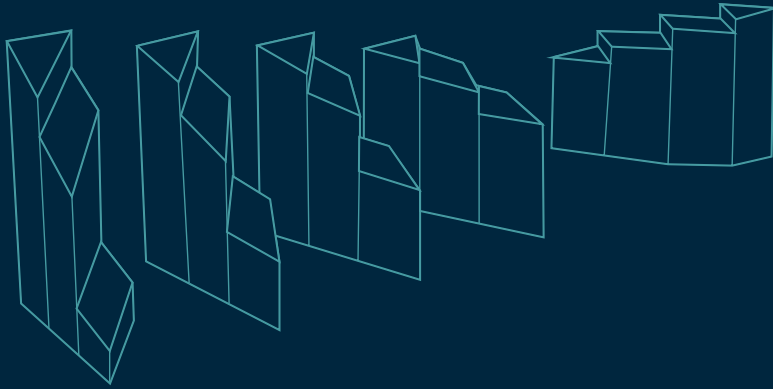

N°5

CINEMA

GAMES ROOM  
THE CASCADING  
TERRACES

N°4

CINEMA

RESIDENTS  
LOUNGE  
& HONESTY BAR

BBQ AREA

DINING TERRACE

SUN DECK

N°3

ROOF GARDEN

LIBRARY &  
CO-WORKING  
SPACE

N°2

RENEW FLOOR

TOM DIXON  
LOBBY

BOARDROOM

DINING &  
EVENT ROOM

PARTY TERRACE

N°1

GYM

SKY VIEW  
TERRACE

LOBBY LOUNGE

# COMMUNAL SPACES

Building neighbourhoods is an art. On the Peninsula you'll find more than just well-designed, beautiful homes, you'll also find shared spaces to relax in, socialise and meet your neighbours. In Upper Riverside you get something special – five elegant buildings brimming with urban amenities – a cardio gym, weights gym, steam room, pool, river facing roof terrace, roof bar and even a private cinema and games room. All the neighbourhoods on Greenwich Peninsula are entirely new, this means that the communities you build, through the people you meet, will be completely new too. It's a chance to make friends, invent fresh traditions and create the kind of place you want to live in.



## RENEW

Our Renew floor is a whole space dedicated to getting you feeling your best – through relaxing with other people and giving your wellbeing a little bit of attention. Exclusively designed by Tom Dixon, it's hard to decide whether it's the gym and pool in this private spa or the gorgeous terrace views that make your heart healthier.

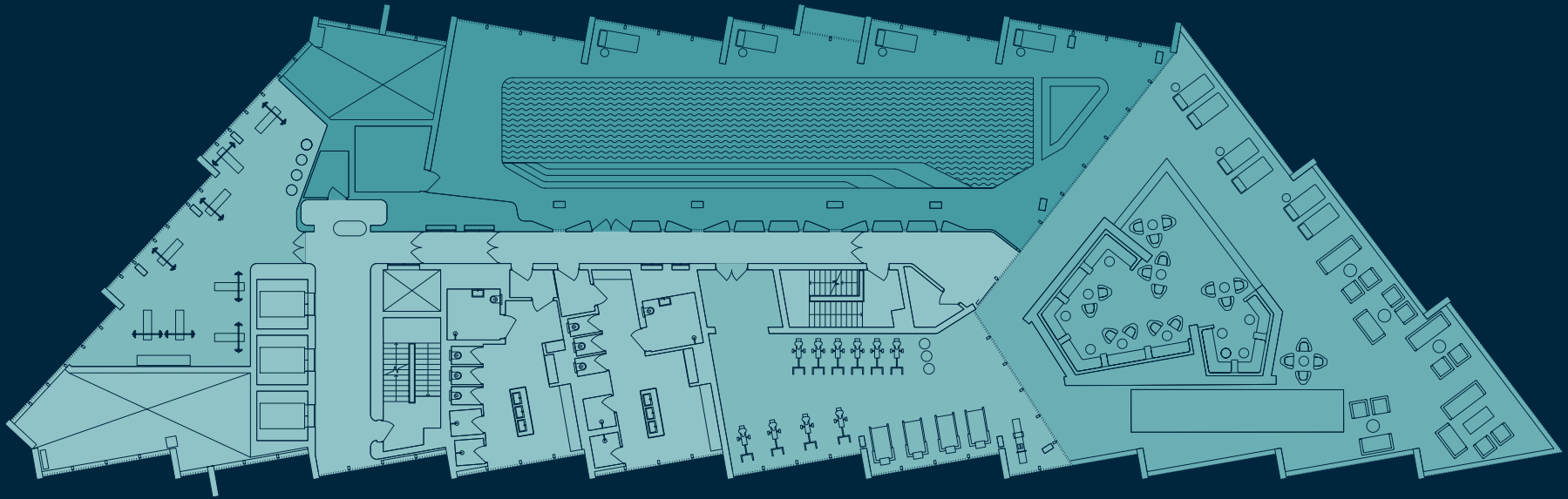

P O O L  
S T E A M   R O O M  
W E I G H T S   G Y M  
C A R D I O   G Y M  
R O O F   T E R R A C E

Renew is a single floor of private facilities for the exclusive use of Upper Riverside residents. The pool is one of London's highest – expect to swim (or gently float) whilst being distracted by dramatic City skyline views of Canary Wharf. Like nearly everywhere in Upper Riverside the gym gets great views of the Thames running alongside the towers. The gym is divided into two so you can either hit the machines in the weights room or pound the treadmills and cycles in the cardio room...making sure you let yourself relax in the steam room afterwards. The Renew floor also has an outdoor roof bar, and an elegantly designed river-facing roof terrace, where you can grab a lounger or a Pilates class on the deck.







## CINEMA & GAMES ROOMS

The downside about having exclusive access to a bookable cinema and a games room, is that everyone will want to come over to yours. A lot. Which isn't the worst problem to have.



## T H E R O O F S

You'll notice these coolly cascading roof terraces long before you reach the five buildings. It's a striking feature of the architecture, each terrace facing the river. Once part of the Upper Riverside community you'll find yourself using the spaces in so many ways. Think yoga, lunching and being with friends. Think BBQs, parties and exercising (though perhaps not in that order).



Some roof terraces in Upper Riverside are shared by all residents. Some are private. All of them offer moments of contemplation as you look out across the sunrise, rolling Thames and hustling City – great during the day, magnificent at night.



Through a little architectural wizardry, each of the Upper Riverside roof terraces faces the river. The Thames gives London its soul, its connection to history and its ever-flowing energy – you can drink it all in from any of the terraces.



## CONCIERGE

As part of the Upper Riverside club you'll be introduced to concierges who are dedicated to taking some of life's small stresses from you. They'll take in deliveries and keep them safely for you, they can make bookings, order taxis, hold a spare key and greet visitors.

# THE LOBBIES

Because community matters, Upper Riverside lobbies have been carefully considered to be sophisticatedly sociable. Lounges, libraries, games room and workspaces are all on offer. Again, you can think of the buildings as your own private club – without the dress code or imperious doorman.



Each sociable lobby is a unique special edition, designed by a different world-class interior designer. As part of the Upper Riverside community you'll be welcome in each.

# THE PRIVATE ROOMS

These sumptuous, elegant rooms are all available to be booked privately for when you need undisturbed working space, want to entertain friends with a bit of pizzazz, or serve dinner in style.





## THE PENINSULA CULTURAL PATH

The Peninsula Cultural Path will provide residents with a trail that traces the riverfront before winding through the Peninsula. It will offer a unique experience. Run it, stroll it, pause on it—it'll be just one of the many things to do in our entirely active and social riverfront.





## T H E R I V E R S I D E

Destination restaurants, neighbourhood restaurants, cool bars and friendly cafes will line the river, meaning you'll always have options for where to meet friends and relax.

Who knows whether it's artisan coffee, a proper cup of tea, craft beer, a London Gin or detox smoothie that's best to drink as you watch the river roll by? Whichever it is, you'll find it along our riverside.

The information contained in this brochure and any other materials supplied to you by Knight Dragon Developments Limited (the "Company") in relation to the Property at Greenwich Peninsula (the "Information") does not form part of any offer or contract and must not be relied upon as statements or representations of fact. The Company does not represent that the Information is accurate, comprehensive, verified or complete, and shall accept no liability for the accuracy or completeness of the Information or for any reliance placed by any person on the Information. No representations, warranties or undertakings are given in relation to the Property. Any representation, condition or warranty which might be implied or incorporated into the Information by statute, common law or otherwise is excluded to the fullest extent permitted by law.

All of the text, photographs, images and plans shown in relation to the Property are indicative and are not necessarily comprehensive. Any areas, measurements or distances given are approximate only. Any reference to alterations to, or use of any part of the Property is not a statement that any necessary planning, building regulations or other consent has been obtained. These matters must be verified by any intending buyer/lessee. Any intending buyer/lessee must satisfy himself by inspection or otherwise as to the correctness of any information given about the Property.

The Company will not be liable to any recipient of the Information for any loss or damage, whether in contract, tort (including negligence), breach of statutory duty, or otherwise, even if foreseeable, arising under or in connection with use of, or inability to use, the Information. In particular, The Company will not be liable for: loss of profits, sales, business, or revenue; business interruption; loss of anticipated savings; loss of business opportunity, goodwill or reputation; or any indirect or consequential loss or damage. Nothing in this disclaimer shall exclude the Company's liability for death or personal injury resulting from the Company's negligence.

All intellectual property rights whether registered or unregistered in any information, content, materials, data or processes contained in the Information belong to the Company or its licensed source. All rights of the Company in such intellectual property are hereby reserved. No part of the Information may be reproduced in any material form (including storing it in any medium by electronic means) without the written permission of the copyright owner.



KNIGHT DRAGON

SUPPORTED BY

MAYOR OF LONDON

