



£75,000

KESTREL CLOSE
SLEAFORD ROAD
TATTERSHAL

- HOT TUB
- EN-SUITE
- ULTRA MODERN
- FULLY FURNISHED
- COMPOSITE DECKING
- BI-FOLD DOORS



Modern 2017 Park Home with Hot Tub

THIS CONTEMPORARY PARK HOME, BUILT IN 2017, OFFERS STYLISH LIVING AND A HOST OF AMENITIES, PERFECT FOR A RETREAT OR SUBLETTING INVESTMENT.

THE UPVC DOUBLE-GLAZED ACCOMMODATION FEATURES AN OPEN-PLAN KITCHEN, LIVING, AND DINING SPACE, ENHANCED BY MODERN BI-FOLDING DOORS THAT BRING THE OUTSIDE IN. THE KITCHEN IS FULLY EQUIPPED WITH A SLIMLINE INTEGRATED DISHWASHER, DOUBLE OVEN, FREESTANDING FRIDGE FREEZER, EXTRACTOR, FITTED MICROWAVE, AND A FIVE-RING GAS HOB.

THE HOME INCLUDES TWO DOUBLE BEDROOMS, WITH THE MASTER BEDROOM BOASTING AN EN-SUITE BATHROOM COMPLETE WITH A FEATURE FREESTANDING BATH. OUTSIDE, YOU'LL FIND A DEDICATED PARKING SPACE AND COMPOSITE DECKING THAT WRAPS AROUND THE FRONT AND SIDE, INCORPORATING A LUXURIOUS SUNKEN HOT TUB.

LOCATED IN THE PICTURESQUE TATTERSHALL LAKES, THIS PROPERTY OFFERS ACCESS TO A WIDE RANGE OF ON-SITE FACILITIES, INCLUDING EATERIES, SWIMMING POOLS, WATER SPORTS, AN ARCADE, AND MORE.

THIS PARK HOME PRESENTS AN IDEAL OPPORTUNITY FOR A PEACEFUL RETREAT OR AS A LUCRATIVE SUBLETTING INVESTMENT. FOR MORE DETAILS,

[HTTPS://WWW.AWAYRESORTS.CO.UK/HOLIDAY-HOMES/OWNERSHIP-GUIDE/](https://www.awayresorts.co.uk/holiday-homes/ownership-guide/)

2023 SITE FEES PRO RATA £6721.71
RATES PRO RATA APRIL-APRIL £304
OPTIONAL HOT TUB SUPPLEMENT TO BE PAID ANNUALLY

PRICE STATED INCLUDES THE 15% PLUS VAT SALE COMMISSION TO SITE

*ANY PERSPECTIVE PURCHASER MUST CONFIRM THAT ANY FIGURES QUOTED ARE CORRECT/UP TO DATE BEFORE PURCHASE



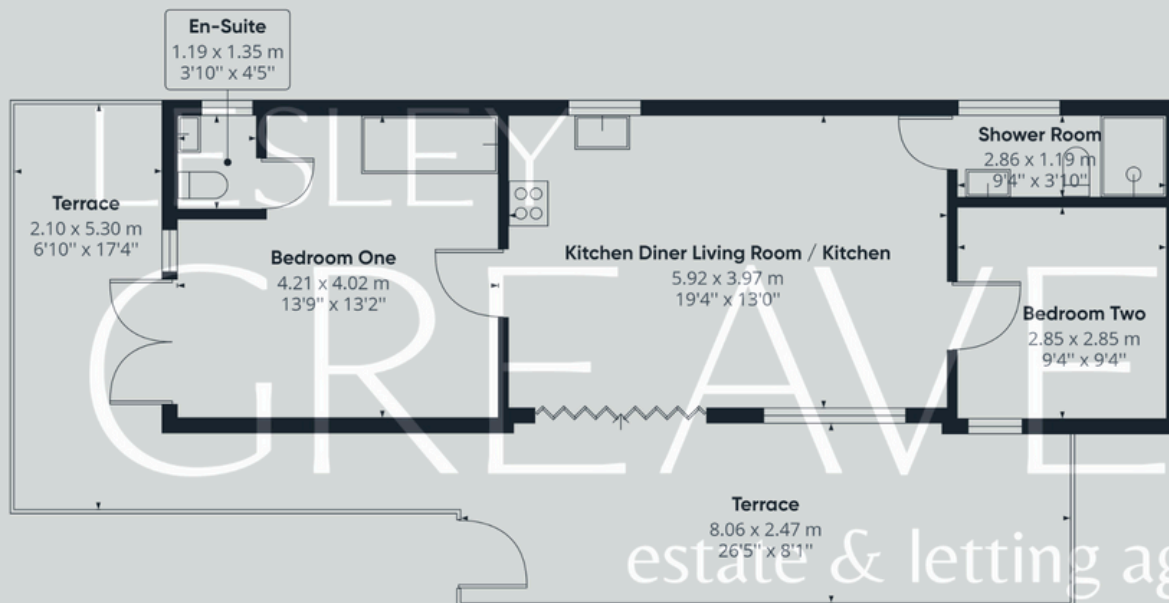

Approximate total area⁽¹⁾
53.29 m²
573.60 ft²

(1) Excluding balconies and terraces

While every attempt has been made to ensure accuracy, all measurements are approximate, not to scale. This floor plan is for illustrative purposes only.

GIRAFFE360

Lesley Greaves Estate & Lettings Agents

20 Main Road ,Gedling, Nottingham, NG4 3HG

0115 987 7337

sales@lesleygreaves.co.uk