



£600,000 - LEASEHOLD

PARLIAMENT VIEW APARTMENTS, ALBERT EMBANKMENT, SE1

PROPERTY

1 BEDROOM 1 BATHROOM 1 RECEPTION ROOM



A bright one-bedroom apartment in Parliament View, a highly regarded portered block on the Southbank, with amazing views of the river Thames and the Houses of Parliament.

The apartment comprises a bright reception room with views of the river Thames and the Houses of Parliament, a modern open-plan kitchen, a master bedroom with integrated storage, a separate bathroom, wooden flooring and air cooling. The property benefits from an allocated underground parking space.

Parliament View offers a 24-hour concierge service, residents' gymnasium and an excellent location on the river between Lambeth and Vauxhall Bridge. The development is within easy reach of the West End, Westminster, the City and South Bank, Vauxhall rail and underground station.





PROPERTY

PARLIAMENT VIEW APARTMENTS, ALBERT EMBANKMENT, SOUTH BANK, LONDON, SE1

At a glance:

- 24h concierge service
- Chain free
- 360 Virtual Tour
- Close to public transport
- Underground parking
- Gym
- Shops and amenities nearby

Other information:

- Leasehold
- Lease with 973 years unexpired
- Service charge approx. £3,600 pa
- Ground rent approx. £200 pa



Parliament View Apartments

Approx. Gross Internal Area 529 Sq Ft - 49.15 Sq M

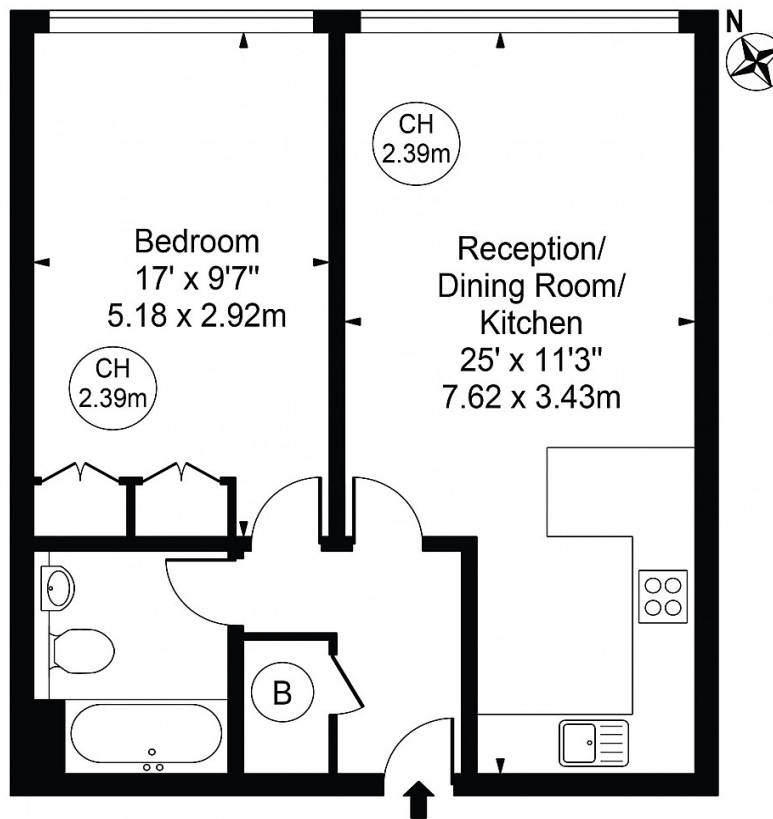

First Floor

For Illustration Purposes Only - Not To Scale

This floor plan should be used as a general outline for guidance only and does not constitute in whole or in part an offer or contract. Any intending purchaser or lessee should satisfy themselves by inspection, searches, enquiries and full survey as to the correctness of each statement. Any areas, measurements or distances quoted are approximate and should not be used to value a property or be the basis of any sale or let. Copyright Morriarti Photography & Design LTD