

## Reynolds Drive

Approximate Gross Internal Area = 68.4 sq m / 736 sq ft  
 Garage = 11.4 sq m / 122 sq ft  
 Total = 79.8 sq m / 858 sq ft

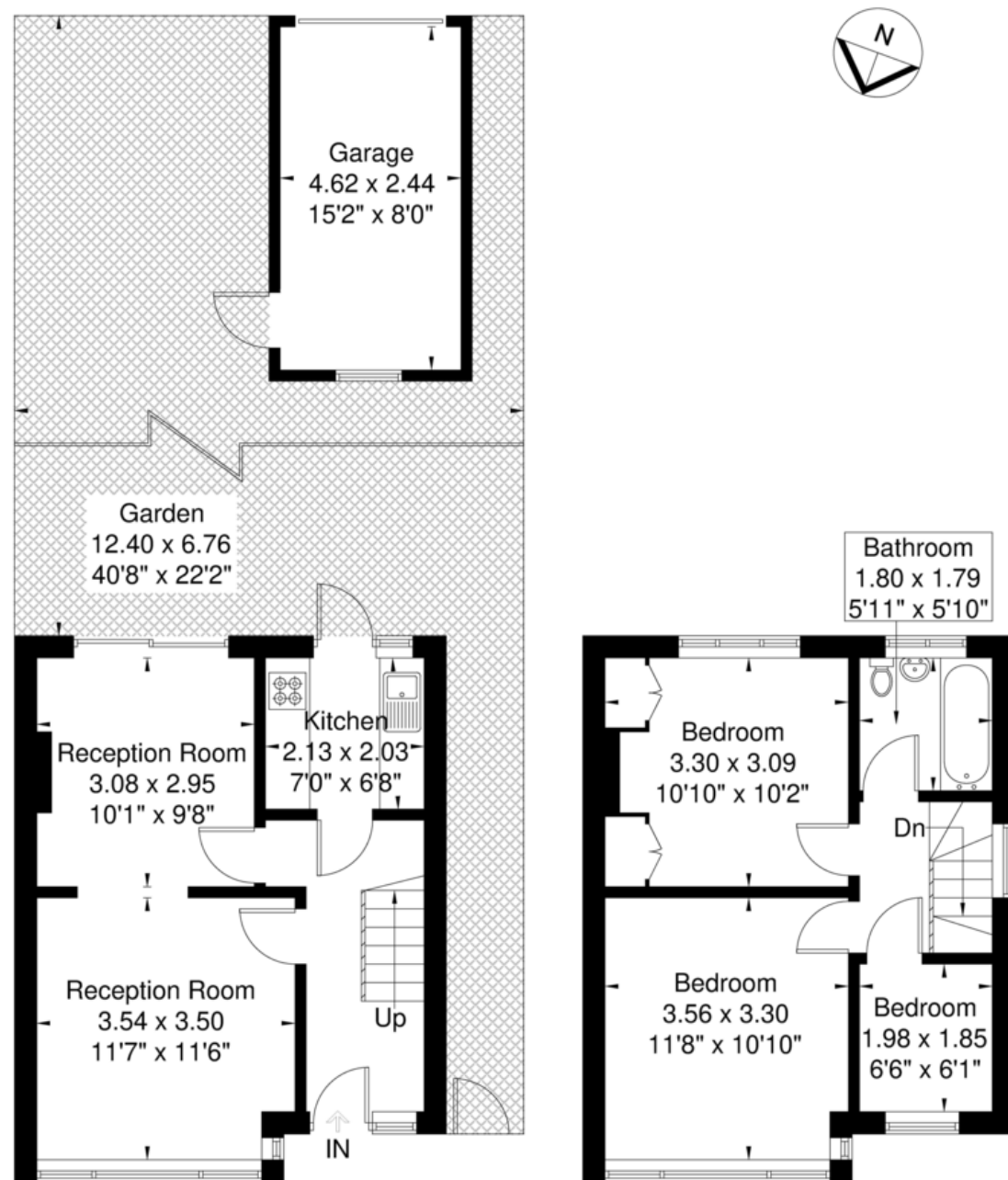

**Ground Floor**  
 34.2 sq m / 368 sq ft

**First Floor**  
 34.2 sq m / 368 sq ft

Although every attempt has been made to ensure accuracy, all measurements are approximate.  
 The floorplan is for illustrative purposes only and not to scale.  
 © www.perspective.co.uk



## Reynolds Drive, Middlesex, HA8 5PX

£2,300 pcm

### Key Features

- End Of Terrace Family House
- Just Being Refurbished
- Three Bedrooms
- Family Bathroom
- Two Reception Rooms
- Modern Kitchen
- Private Garden
- Own Drive Way For 2 Cars

### Description

Hart and Co are please to present this three-bedroom end of terrace family house with own drive and garage. The ground floor accommodation comprises a double reception and a separate kitchen leading to a private garden. First floor family bathroom main master bedroom and a further 2 bedrooms. Queensbury Underground Station (Jubilee Line) is within a short walk, as well as all other local amenities.



Energy Efficiency Rating		
	Current	Potential
<i>Very energy efficient - lower running costs</i>		
(92+) <b>A</b>		
(81-91) <b>B</b>		86
(69-80) <b>C</b>		
(55-68) <b>D</b>	61	
(39-54) <b>E</b>		
(21-38) <b>F</b>		
(1-20) <b>G</b>		
<i>Not energy efficient - higher running costs</i>		
<b>England &amp; Wales</b>	EU Directive 2002/91/EC	

WWW.EPC4U.COM