

40
YEARS
1982 - 2022

HACKNEY
& LEIGH



Keswick

Offers in the region of £270,000

11 Hewetson Court, Main Street, Keswick, Cumbria, CA12 5DW

A modern purpose built self-contained second floor two bedroom apartment together with an allocated private parking space most conveniently situated in Keswick town centre and offering easily managed accommodation with fell views from three sides. The property is equally suitable as a primary home, second home or for lucrative holiday letting.

Quick Overview

Modern purpose built self-contained apartment

Most convenient town centre location
Easily managed accommodation with fell views from three sides

Two bedrooms

Allocated private parking space

Equally suitable as a primary or second home or for holiday letting



2



1



1



D



Superfast
80 Mbps



1

Property Reference: KW0208



Accommodation

Ground Floor:

Communal Entrance Hall

With stair case leading to

Second Floor:

Communal landing and external passage.



Self Contained Entrance Hall

With electric heater, built in airing cupboard, built in storage cupboard.

Living / Dining Room

With fell views, electric heater.



Kitchen

With fell views, range of fitted base and wall units, single drainer sink unit with mixer tap, ceramic wall tiling, integrated oven, hob, extractor unit and plumbing for washing machine, wall mounted fan heater.

Bedroom One

With fell views, electric heater.



Bedroom Two

With fell views, electric heater.

Bathroom

With WC, wash hand basin and bath including shower over, ceramic wall tiling, heated towel rail, wall mounted fan heater.

Outside:

Communal private car park with an allocated single parking space.

Services

Mains water, electricity and drainage. Electric heating.

Tenure

Leasehold.

Service Charge

We are advised that the service charge is currently £70 per month.

Rateable Value

£3,900.

Energy Performance Certificate

The full energy performance certificate is available on our website and also at any of our offices.

Directions

Entering into Keswick town centre on the A591 along Main Street, the entrance to Hewetson Court is on the left at the roundabout immediately after the Cooperative food store. Apartment 11 is within the rear block of apartments on the left.

Viewings

By appointment with Hackney & Leigh's Keswick office.

Price

Offers in region of £270,000.



Flat 11, Hewetson Court, Main Street, Keswick

Approximate Area = 561 sq ft / 52.1 sq m

For identification only - Not to scale

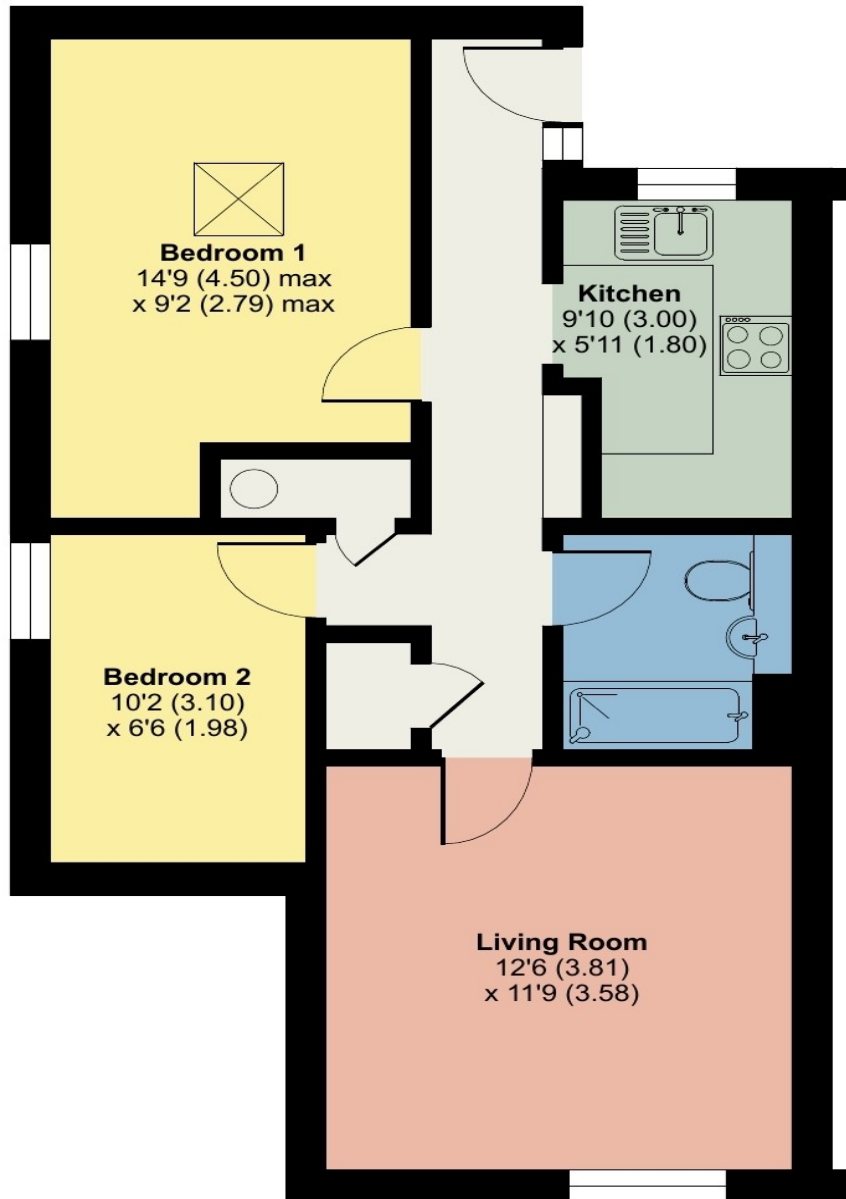

SECOND FLOOR



Floor plan produced in accordance with RICS Property Measurement Standards incorporating International Property Measurement Standards (IPMS2 Residential). © nīchecom 2022. Produced for Hackney & Leigh. REF: 925008

All permits to view and particulars are issued on the understanding that negotiations are conducted through the agency of Messrs. Hackney & Leigh Ltd. Properties for sale by private treaty are offered subject to contract. No responsibility can be accepted for any loss or expense incurred in viewing or in the event of a property being sold, let, or withdrawn. Please contact us to confirm availability prior to travel. These particulars have been prepared for the guidance of intending buyers. No guarantee of their accuracy is given, nor do they form part of a contract. Broadband speeds estimated and checked by <https://checker.ofcom.org.uk/en-gb/broadband-coverage> on 30/11/2022.

Request a Viewing Online or Call 01768 741741