

**£850 pcm**

Fleetwood Close, March, Cambridgeshire PE15 9NN



**To arrange a viewing call us now on 01354 694900**

**Deposit £980**

A modern terraced house with two double bedrooms, an open plan lounge/dining area and a kitchen.

The property has radiator central heating, double glazed windows, a garden and parking to the front.

Available early September.

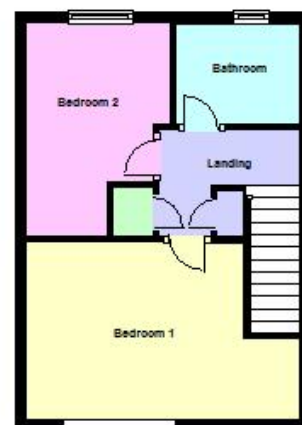
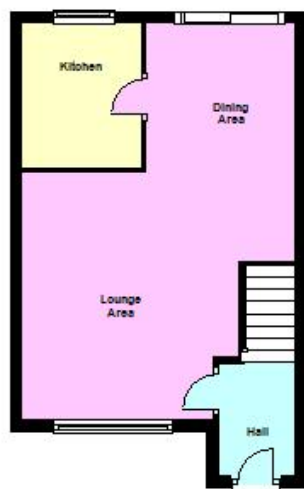

**£850 pcm**

**Fleetwood Close, March, Cambridgeshire PE15 9NN**



**GROUND FLOOR**

Entrance door to:

**HALL**

Radiator, stairs to first floor.

**LOUNGE / DININGROOM**

6.67m (22'") x 4.56m (15') max.

Double glazed window to front, two radiators, double glazed sliding patio door to garden,

**INITIAL LENGTH OF TENANCY**

6 months

Fenland District Council Tax band – A

Energy rating - C



**KITCHEN**

2.44m (8') x 2.00m (6'7")

Fitted with a matching range of base and eye level units with worktop space over, stainless steel sink with single drainer, plumbing for automatic washing machine, built-in oven, four ring gas hob with extractor hood over, double glazed window to rear.

**FIRST FLOOR LANDING**

Storage cupboard, airing cupboard.



**BEDROOM 1**

4.56m (15') x 3.00m (9'10")

Double glazed window to front, radiator.

**BEDROOM 2**

3.57m (11'9") x 2.40m (7'10")

Double glazed window to rear, radiator.

**BATHROOM**

Double glazed window to rear, radiator.



**OUTSIDE**

There is a parking area to the front, the enclosed rear garden is laid to lawn with flowers, shrubs and a patio area.

**DIRECTIONS**

On entering the town from the Chatteris direction continue along Wimblington Road, turn right onto Cavalry Park, turn left onto Worsley Chase and left into Fleetwood Close.

**Ellis Winters & Co** 20 Market Hill, Chatteris, Cambridgeshire, PE16 6BA  
Tel: 01354 694900 Email: [info@elliswinters.co.uk](mailto:info@elliswinters.co.uk) [www.elliswinters.co.uk](http://www.elliswinters.co.uk)