



3 Bedroom Mid Terraced House £275,000

2 Pavilion Close, Swindon, SN1 2NZ

**mcfarlane**  
property.com



## 3 Bedroom Mid Terraced House Swindon,

- Three Storey
- Three Double Bedrooms
- Heart of Swindon
- Tenant In situ

An ideal investment opportunity with tenant currently in situ paying £750pcm. A three storey terraced property with three double bedrooms. To the ground floor there is a good sized modern kitchen, lounge and cloakroom. To the second floor there are two double bedrooms and the family bathroom with three piece suite comprising bath with shower over, basin and WC. To the second floor is the master bedroom with built in wardrobe and en-suite shower room.



**We**   
**where you**  
**LIVE**

Our team are friendly, experienced and are all local. They know it better than they do their own living rooms and can help you find what you're looking for because **we love where we live.**

We would be delighted to show you around this property.

**Because every home  
 needs a personal touch.**

**If you would like to view this  
 property then please get in touch.**

☎ 01793 296880

✉ [oldtown@mcfarlaneproperty.com](mailto:oldtown@mcfarlaneproperty.com)

[mcfarlaneproperty.com](http://mcfarlaneproperty.com)

Agents Note: Whilst every care has been taken to prepare these sales particulars, they are for guidance purposes only. All measurements are approximate are for general guidance purposes only and whilst every care has been taken to ensure their accuracy, they should not be relied upon and potential buyers are advised to recheck the measurements

### Ground Floor

Approx. 40.1 sq. metres (431.9 sq. feet)

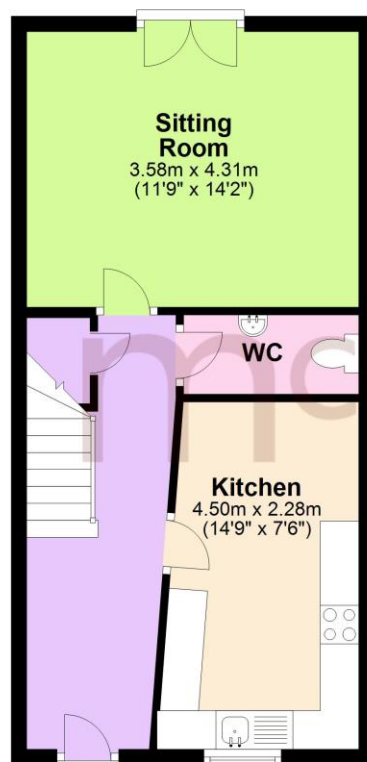

### First Floor

Approx. 41.4 sq. metres (445.7 sq. feet)

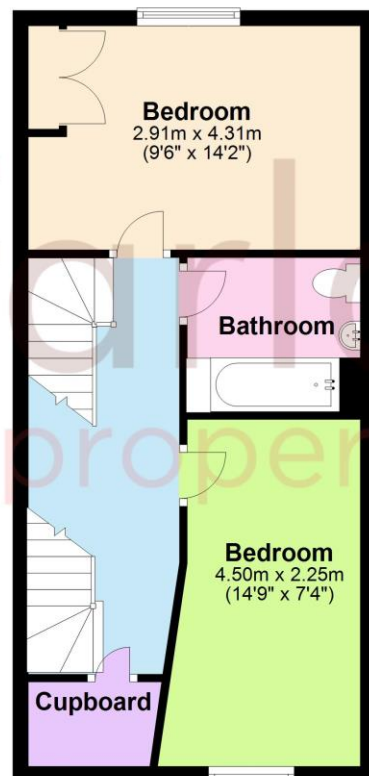

### Second Floor

Approx. 25.4 sq. metres (273.1 sq. feet)

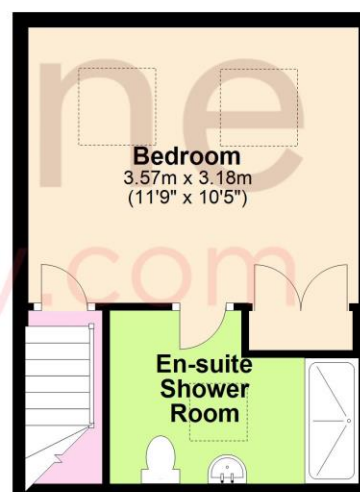

Total area: approx. 106.9 sq. metres (1150.6 sq. feet)

**mcfarlane**  
 property.com

#### Cricklade.

102 High Street  
 Cricklade SN6 6AA

☎ 01793 751044

#### Marlborough.

106 High Street  
 Marlborough SN8 1LT

☎ 01672 514380

#### Old Town.

28-30 Wood Street  
 Swindon SN1 4AB

☎ 01793 296880

#### Swindon.

The Village Centre,  
 Redhouse SN25 2FW

☎ 01793 296600