



 3
Bedrooms

 1
Bathroom



Elliott Quinn Estates are excited to bring this beautiful 3 Bedroom property to market.

Elliott Quinn Estates are excited to bring this beautiful 3 Bedroom property to market. This property is located in the very popular area of Earlsdon, which allows easy access to the city centre and other local amenities. The mid terraced property has a large spacious living room which leads into the kitchen and onto the garden. Then upstairs has two double bedrooms and a box bedroom and a W/C.

Viewing is a must to fully appreciate the size of this property.

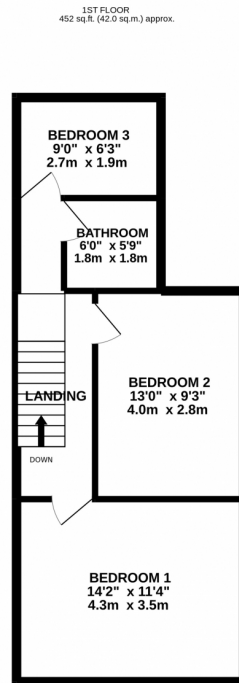
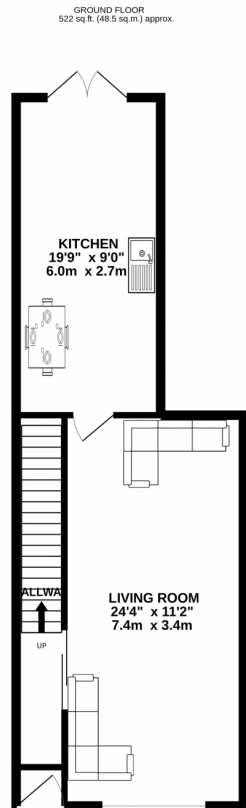

TOTAL FLOOR AREA: 974 sq.ft. (90.5 sq.m.) approx.

Whilst every attempt has been made to ensure the accuracy of the floorplan contained here, measurements of doors, windows, rooms and any other items are approximate and no responsibility is taken for any error, omission or mis-statement. This plan is for illustrative purposes only and should be used as such by any prospective purchaser. The services, systems and appliances shown have not been tested and no guarantee as to their operability or efficiency can be given.
Made with Metropix 10/2022

