

25
YEARS

SERVING
BEACONSFIELD
SINCE 1998

36 Elmers Court, Post Office Lane, Beaconsfield

Guide Price £350,000

Ashington Page

Attractive second floor apartment ideally located in central Beaconsfield within a few minutes' walk to shops, restaurants, bars and mainline station with fast trains to London Marylebone taking less than 25 minutes. This town centre apartment benefits from having a secure underground car parking space.

Energy Efficiency Rating - B

Council Tax Band - D

Lease - 125 years from 1 January 2004. 107 years remaining.

Service Charge - £2,219 Review period TBA

Ground Rent - £175.00 paid half yearly, total £350.00. Review period TBA

These particulars are for guidance only. They are prepared and issued in good faith and are intended to give a fair summary of the property. Any description should not be relied on as a statement or representation of fact or that the property, or its services, are in good condition. The photographs show only certain parts of the property at the time they were taken. Any areas, measurements or distance given are approximate only. Any reference to alterations to, or use of, any part of the property is not a statement that any necessary planning, building regulations or other consent has been obtained. These matters must be verified by an intending purchaser. All statements contained in these particulars in relation to the property are made without responsibility of Ashington Page or its clients. Neither Ashington Page (nor any joint agents) nor any of their employees has any authority to make or give any representation or warranty whatsoever in relation to the property

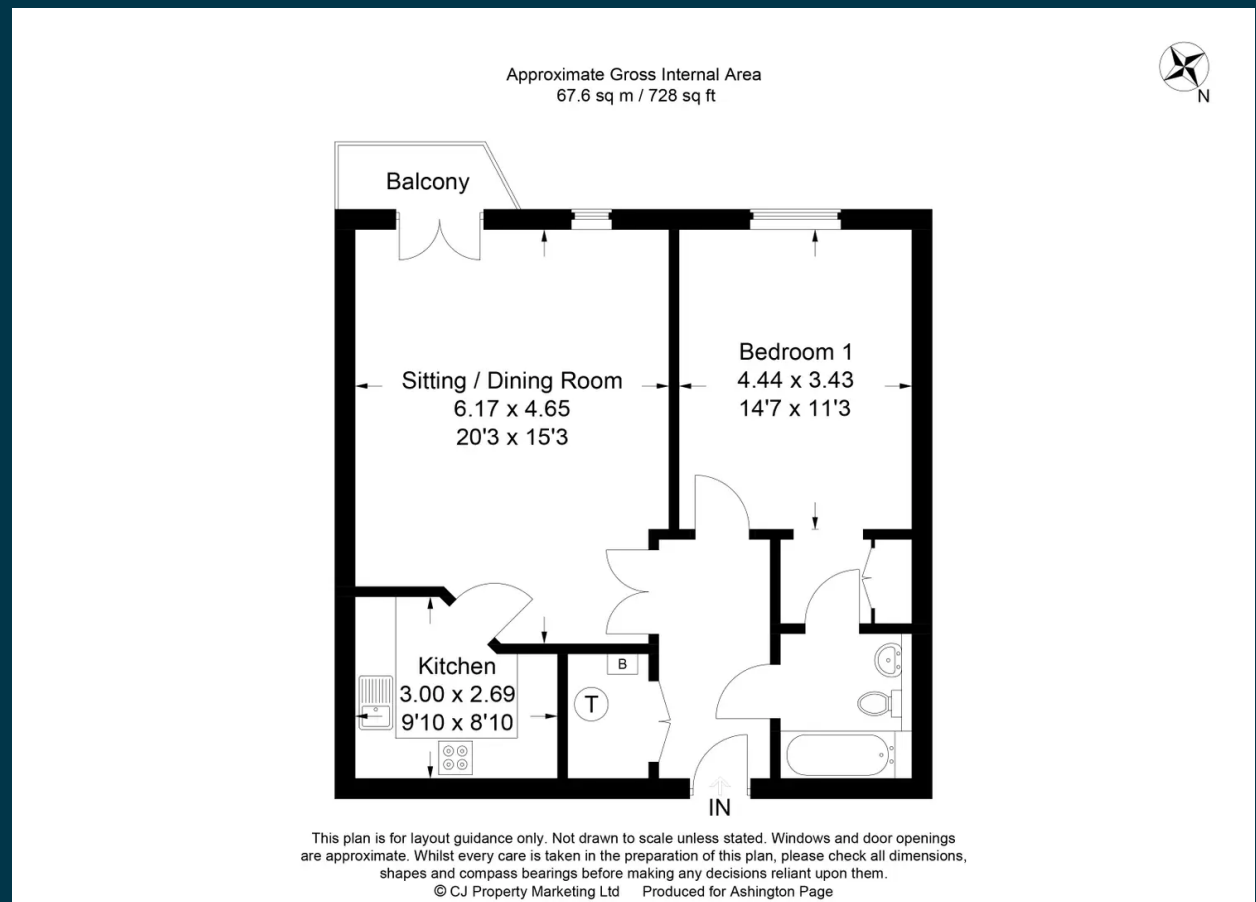

01494 680018
info@ashingtonpage.co.uk
www.AshingtonPage.co.uk

