



16a Southside Street | The Barbican | Plymouth | PL1 2LB

In Excess Of £110,000

A first and second floor maisonette situated on the Barbican.

Upon inspection you find an entrance lobby, with stairs to first floor landing, with doors to the bedroom and bathroom, stairs further ascend to the second floor where you will find an open plan living kitchen diner.

The property does benefit from Upvc double glazing and a gas central heating system, however the property requires refurbishment and re-decoration throughout.

- Self Contained Maisonette
- Upvc Double Glazing
- Gas Central Heating System
- Double Bedroom
- Bathroom

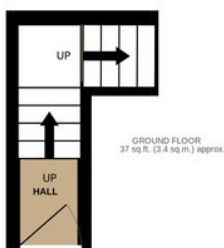
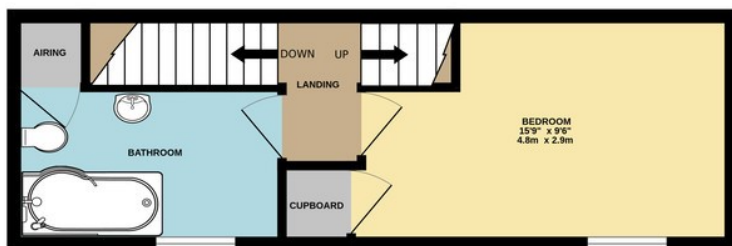
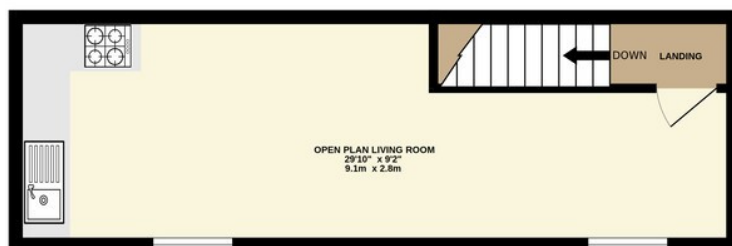

Contact Details

48 Ebrington Street
Plymouth
Devon
PL4 9AD

www.athomelettings.com
info@athomeproperty.co.uk
01752 777070

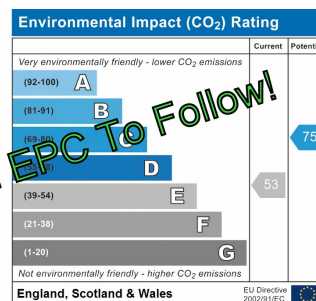
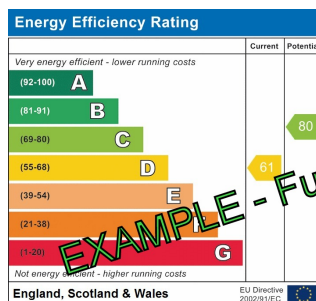

Agents Note: Whilst every care has been taken to prepare these sales particulars, they are for guidance purposes only. All measurements are approximate are for general guidance purposes only and whilst every care has been taken to ensure their accuracy, they should not be relied upon and potential buyers are advised to recheck the measurements