



4 Bedroom Semi-Detached House Offers Over £300,000

7 Foxhill Close, Swindon, SN25 3DW

mcfarlane
property.com

4 Bedroom Semi-Detached House Swindon, SN25 3DW

- SEMI DETACHED
- FOUR BEDROOMS
- TWO RECEPTION ROOMS

A well presented FOUR BEDROOM semi-detached property which has been thoughtfully extended to the rear plus an ANNEX. The spacious and flexible accommodation includes: STUNNING light and airy kitchen with integrated appliances open to the dining room with VAULTED CEILING and three sets of French doors to the rear garden. Spacious living room with modern electric fireplace, three double bedrooms, generous single bedroom and family bathroom.





We 
where you
LIVE

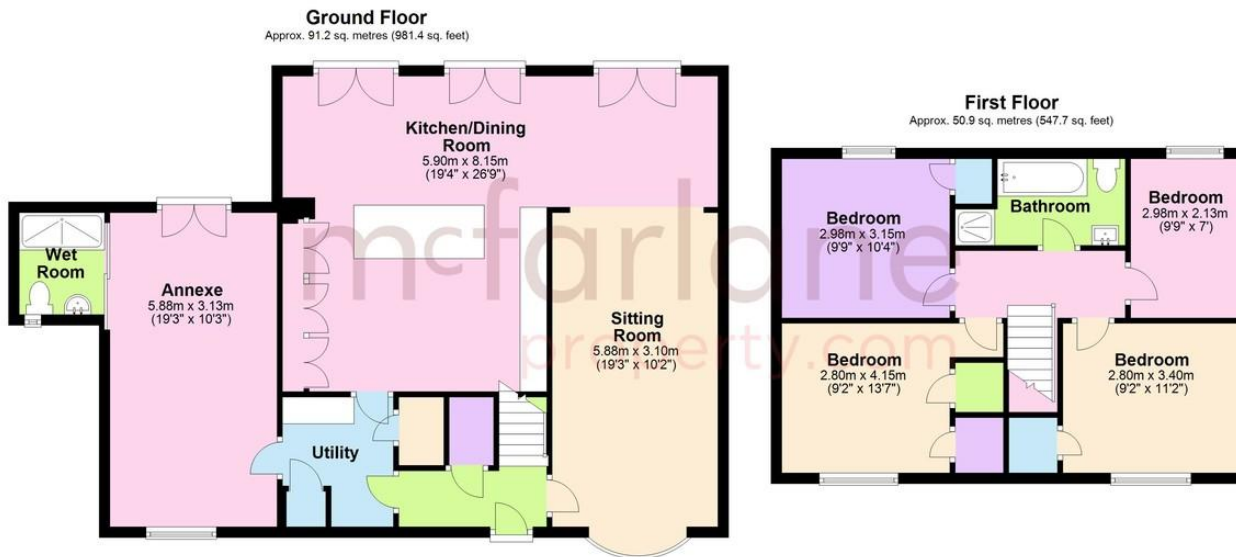

Total area: approx. 142.1 sq. metres (1529.2 sq. feet)

Our team are friendly, experienced and are all local. They know it better than they do their own living rooms and can help you find what you're looking for because **we love where we live.**

We would be delighted to show you around this property.

**Because every home
needs a personal touch.**

**If you would like to view this
property then please get in touch.**

📞 01793 296880

✉ oldtown@mcfarlaneproperty.com

mcfarlaneproperty.com

mcfarlane
property.com

Cricklade.
102 High Street
Cricklade SN6 6AA
📞 01793 751044

Marlborough.
106 High Street
Marlborough SN8 1LT
📞 01672 514380

Old Town.
28-30 Wood Street
Swindon SN1 4AB
📞 01793 296880

Swindon.
The Village Centre,
Redhouse SN25 2FW
📞 01793 296600

Agents Note: Whilst every care has been taken to prepare these sales particulars, they are for guidance purposes only. All measurements are approximate are for general guidance purposes only and whilst every care has been taken to ensure their accuracy, they should not be relied upon and potential buyers are advised to recheck the measurements