



Monks Wall Barn, Brimham Rocks Road, Burnt Yates, HG3 3EW

£795,000



Description

A very attractive and aesthetically pleasing Yorkshire stone barn conversion offering spacious, four double bedroom, three bathrooms, (2 en-suite) family accommodation.

Monks Wall Barn has been converted and improved to an impressive high standard following conversion approximately 20 years ago, but it does still offer opportunities for a purchaser to carry out additional works to suit individual taste. There remains a wealth of features throughout including tiled and wooden flooring, wooden beams and stone fireplace.

Equipped with double glazed windows, air source heat pump, solar panels, and a multi fuel stove, there are significant energy consumption benefits.

There remains a wealth of features throughout, thus retaining character, but also offering a modern feel. The property is approached initially via a shared private driveway servicing the 3 other properties within this hamlet.

Monks Wall Barn is located at the heart of beautiful Nidderdale countryside and has far reaching views, including the famed White Horse at Kilburn. There is, enclosed within a dry stone walled boundary to the front a garden with well stocked borders, lawn and a south facing patio. To the rear is a further easy to maintain garden area with low stone boundary wall.





Additionally, there is block paved driveway with ample vehicle parking space and direct access to a large integral double garage, with eves storage, light, power and rear service door.

The property should be viewed internally to fully appreciate all it has to offer.

Located within this small hamlet set back off the Brimham Rocks Road, it thus affords good privacy, the property is in outstanding natural countryside, very close to the well serviced Village of Burnt Yates, with local primary school and cricket club. Harrogate town centre is accessible via good road links, as are the cities of Leeds and Ripon, plus towns of Skipton and Pateley Bridge and the A1 motorway. The outstanding natural formations at Brimham Rocks are also close at hand.

Services

Mains electricity is provided, as well as mains water via a sub meter from the incoming supply and charged back according to consumption on a monthly basis. There is a shared septic tank, the cost of servicing again shared with the other neighbours. There is no mains gas supply to the property.

Tenure

Freehold.

Council Tax

Band G.

Directions

Leave Harrogate on the A61 Ripon Road and continue through Killinghall then at the second Ripley roundabout turn left sign posted Pateley Bridge. Follow the road through Burn Yates and immediately after leaving the village turn right towards Brimham Rocks Road. Take the next right hand turning and continue along the private driveway, bearing right then Monks Wall Barn can be found on the left hand side.

Details Produced

26th January 2023.









GROUND FLOOR
1135 sq.ft. (105.4 sq.m.) approx.



1ST FLOOR
923 sq.ft. (85.7 sq.m.) approx.

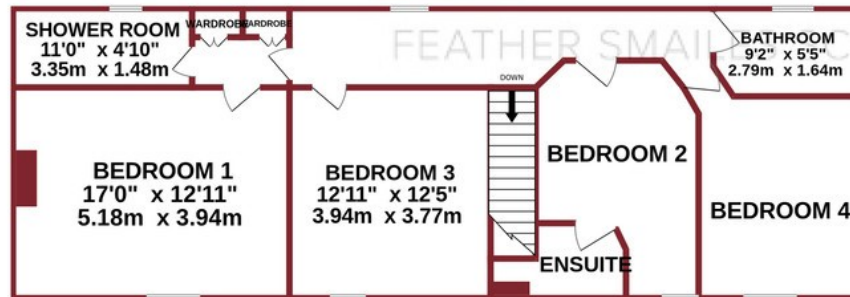

FSS trust potential buyers and sellers have obtained financial advice, or have funds in place, prior to entering into a property transaction. FSS, as agents acting on behalf of clients, will seek proof of funding to safeguard our clients interest. Should you require mortgage advice, we have a long standing relationship with an independent mortgage advisor who can provide information for you. Please ask a member of staff for more details. Over the course of the last financial year 2018-2019 referrals to this independent mortgage broker have, on average, earned us a fee of £339.96 per case.

IMPORTANT NOTICE: 1. Particulars: These particulars are not an offer of contract, nor part of one. You should not rely on statements by Feather Smalles Scales LLP in the particulars or by word of mouth or in writing ("information") as being factually accurate about the property, its condition or its value. Neither Feather Smalles Scales or any joint agent has any authority to make any representations about the property, and accordingly any information given is entirely without responsibility on the part of the agents, seller(s) or lessor(s). **2. Photos etc:** The measurements and distances given are approximate only and maps, plans and areas displayed are for illustration purposes only. Photographs show only certain parts of the property as they appeared at the time they were taken. **3. Regulations etc:** Any reference to alterations to, or use of, any part of the property does not mean that any necessary planning, building regulations or other consent has been obtained. A buyer or lessee must find out by inspection or in other ways that these matters have been properly dealt with and that all information is correct. **4. VAT:** The VAT position in relation to the property may change without notice. Viewing by appointment only. Feather Smalles & Scales is a limited liability partnership registered in England with registered number OC308783. Our registered office is 8 Raglan Street, Harrogate, North Yorkshire, HG1 1LE, where you may look at a list of members' names.

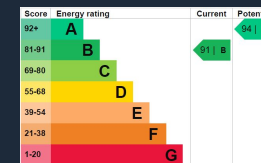

01423 501211
www.fssproperty.co.uk
sales@fssproperty.co.uk
8 Raglan Street, Harrogate,
North Yorkshire, HG1 1LE