



 2  
Bedrooms

 1  
Bathroom









TRADING PLACES ESTATE AGENTS are pleased to offer for sale this charming and modernised beautifully presented TWO DOUBLE BEDROOM mid terrace period property. Tucked away in a quiet cul-de-sac, within a popular residential area, situated just off Church Road. The location is conveniently located just a short stroll to the town centre and the train station. In brief, this attractive well presented property comprises; a warm and welcoming entrance hallway, a well proportioned bay fronted living room, a open plan breakfast kitchen complete with a comprehensive range of 'Shaker' style wall and base units with a integral dishwasher and wine cooler. The dining area opens into the fitted kitchen with double doors opening out into the rear garden. To the first floor, a spacious landing provided access into two double bedrooms and a larger than average three piece bathroom with a jacuzzi bath. Boarded loft with pull down ladder ideal for storage or conversion. Externally, to the rear of the property, an enclosed low maintenance artificial lawned SOUTH FACING garden can be found with ample space for a table and chairs during those summer months. An excellent period property in a desirable location. An internal inspection comes highly recommended.



GROUND FLOOR  
430 sq.ft. (39.9 sq.m.) approx.

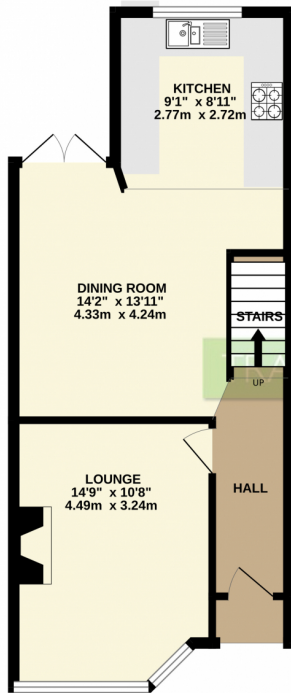

1ST FLOOR  
423 sq.ft. (39.3 sq.m.) approx.

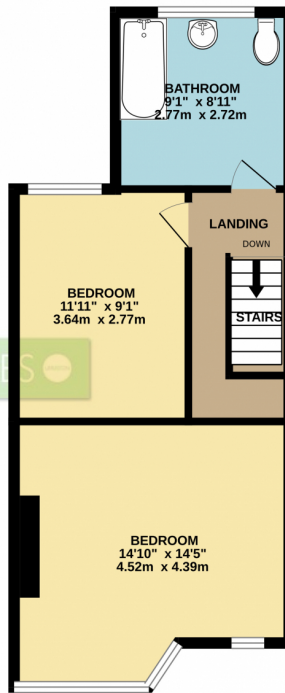

TOTAL FLOOR AREA : 853 sq.ft. (79.2 sq.m.) approx.

Whilst every attempt has been made to ensure the accuracy of the floorplan contained here, measurements of doors, windows, rooms and any other items are approximate and no responsibility is taken for any error, omission or mis-statement. This plan is for illustrative purposes only and should be used as such by any prospective purchaser. The services, systems and appliances shown have not been tested and no guarantee as to their operability or efficiency can be given.  
Made with Metropac ©2012.

