



**Boulters Close | Slough | SL1 9BQ**

Hiltons are pleased to bring to the market this three bedroom family home situated in Cippenham. Benefitting from a newly refurbished kitchen and bathroom, this property is ideal for family's and commuters looking for their next ideal home. The ground floor benefits from a spacious and well decorated through lounge leading to the newly renovated kitchen. Spacious garden also benefits this property with potential for further extension (STPP). The first floor leads to the renovated bathroom and three bedrooms.

**£395,000**

- Three Bedroom Home
- Newly Renovated
- Potential to Extend (STPP)
- Good Transport Links
- Close to all Major Amenities





GROUND FLOOR  
927 sq.ft. (86.1 sq.m.) approx.

1ST FLOOR  
859 sq.ft. (79.8 sq.m.) approx.

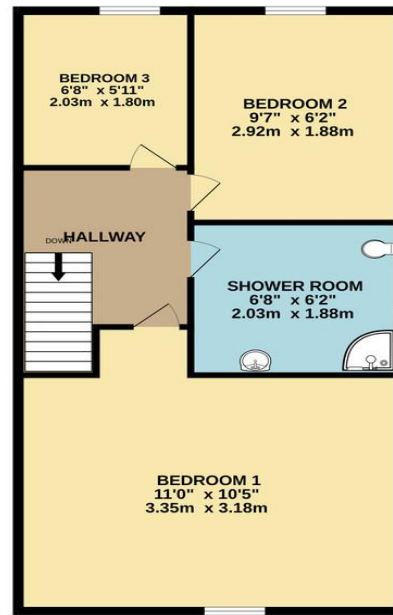
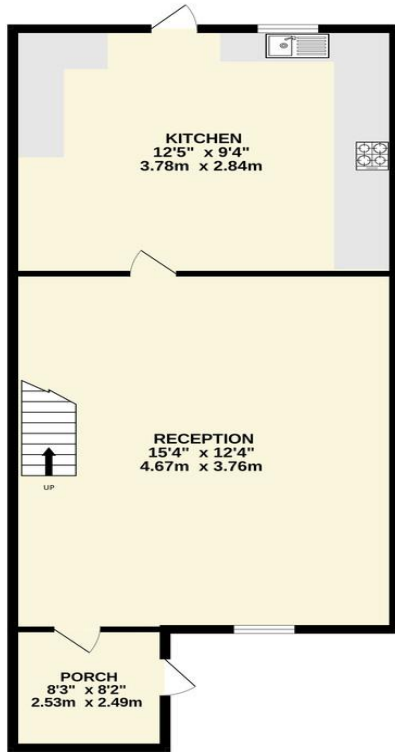

TOTAL FLOOR AREA: 1786 sq.ft. (165.9 sq.m.) approx.

Whilst every attempt has been made to ensure the accuracy of the floorplan contained here, measurements of doors, windows, rooms and any other items are approximate and no responsibility is taken for any error, omission or mis-statement. This plan is for illustrative purposes only and should be used as such by any prospective purchaser. The services, systems and appliances shown have not been tested and no guarantee as to their operability or efficiency can be given.  
Made with Metropix ©2023

## Contact Details

137 Western Road

Southall

Middlesex

UB2 5HN

[www.hiltons-estates.com](http://www.hiltons-estates.com)

[Harvin@hiltons-estates.com](mailto:Harvin@hiltons-estates.com)

02088679555

## Energy Efficiency Rating

Score	Energy rating	Current	Potential
92+	A		
81-91	B		87   B
69-80	C		
55-68	D	61   D	
39-54	E		
21-38	F		
1-20	G		

Agents Note: Whilst every care has been taken to prepare these sales particulars, they are for guidance purposes only. All measurements are approximate are for general guidance purposes only and whilst every care has been taken to ensure their accuracy, they should not be relied upon and potential buyers are advised to recheck the measurements