



**CHISWELL & CO**  
RESIDENTIAL SALES & LETTINGS

51 CARPATHIA DRIVE, SOUTHAMPTON, SO14 3GU  
ASKING PRICE OF £149,950





TWO BEDROOM FIRST FLOOR FLAT WITH PARKING AND EN-SUITE. Chiswell & Co are delighted to offer for sale this two double bedroom room 4th floor flat with parking, en-suite, separate kitchen, lounge with Juliette balcony. The property is in a great location in Town Centre, close to main bus routes and the popular area of Oxford St and Ocean village.

**LOUNGE**

15' 3" x 12' 2" (4.67m x 3.73m)

**KITCHEN**

10' 2" x 6' 5" (3.12m x 1.96m)

**BEDROOM 1**

12' 9" x 8' 5" (3.89m x 2.59m)

**BEDROOM 2**

10' 2" x 8' 5" (3.12m x 2.59m)

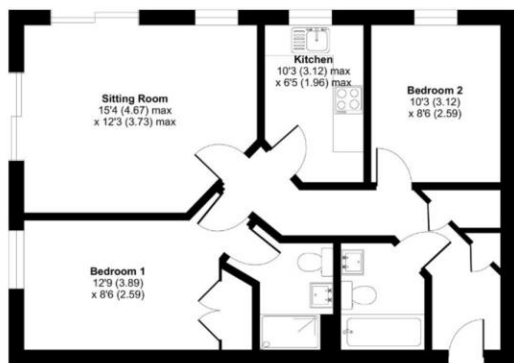

GROUND FLOOR

%epcGraph\_c\_1\_304%