

Property Summary

A spacious three bedroom mid terrace situated in the increasingly popular location of South Wigston offering ample living space with two reception rooms, fitted kitchen, ground floor lobby and bathroom, two double bedrooms and bedroom three off bedroom two, a private and spacious rear garden and side access, the property has also benefitted from a recent new roof. Internal inspection comes highly recommended.

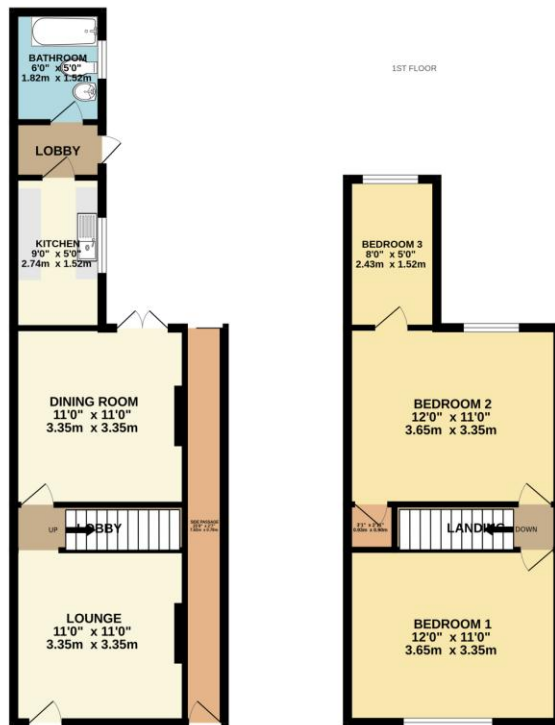

GROUND FLOOR



PHILLIPS GEORGE LTD

Whilst every attempt has been made to ensure the accuracy of the floorplan contained herein, measurements of doors, windows, rooms and any other items are approximate and no responsibility is taken for any error, omission or mis-statement. This plan is for illustrative purposes only and should be used as such by any prospective purchaser. The services, systems and appliances shown have not been tested and no guarantee as to their operability or efficiency can be given. Made with Metropex 05023

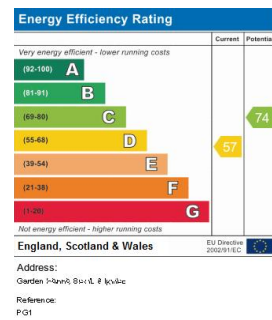

- Mid Terrace Property With Rear Garden
- Three Bedrooms
- Highly Popular Location
- Ideal First Time Buy
- Landscaped Garden
- Fitted Kitchen
- Ground Floor Bathroom
- Well Presented

phillips george | sales & lettings

Agents Note: Whilst every care has been taken to prepare these sales particulars, they are for guidance purposes only. All measurements are approximate and for general guidance purposes only and whilst every care has been taken to ensure their accuracy, they should not be relied upon and potential buyers are advised to recheck the measurements

46 Long Street, Wigston, Leicestershire, LE18 2AH

info@phillipsgeorge.co.uk
0116 216 8178

