

Love Homes



Richmond Road, Westoning, Bedfordshire, MK45 5JZ

This well presented three bedroom home with ground floor cloakroom is located in a popular residential area close to the village high street and the lower school. The property has been improved and updated by the current owners and offers light and airy open plan living accommodation that briefly comprises; a 14ft8 living room with feature open fireplace, a modern open plan kitchen/diner overlooking the rear garden, a downstairs cloakroom, three first floor bedrooms and a modern family bathroom.



This property is presented by Duncan Stead - a Love Homes property expert with over 25 years experience.

Find out more about this property by scanning the QR code.



1.6m



3



1



1

Tenure: Freehold Council Tax Band: C

Flitwick Office 01525 71311



Barton Le Clay Office 01582 882440



Biggleswade Office 01767 669222



“Westoning is a fantastic village and I've really loved living here and it has various community events throughout the year. Having a real open fireplace was a big attraction to me and an open plan kitchen/diner. I recently added a downstairs cloakroom for convenience for when family and friends visit...I wish I did it years ago! The 3rd bedroom is larger than others I've seen and has been used as a bedroom and hobbycraft room/home office”.



GROUND FLOOR
379 sq. ft. (35.3 sq.m.) approx.

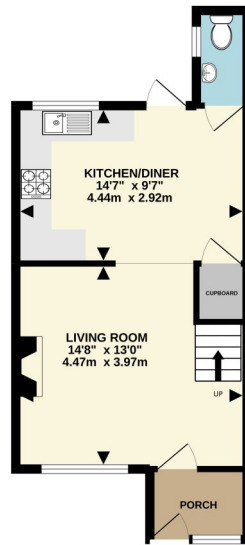

1ST FLOOR
336 sq. ft. (31.2 sq.m.) approx.

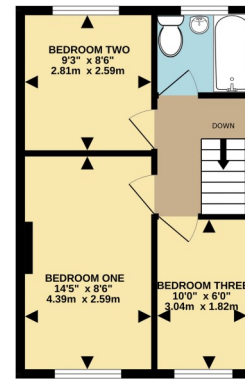

TOTAL FLOOR AREA: 716 sq. ft. (66.5 sq.m.) approx.
Drawn by: Wilson & Hunt, not to scale
Checked with: Metropack 10/2022

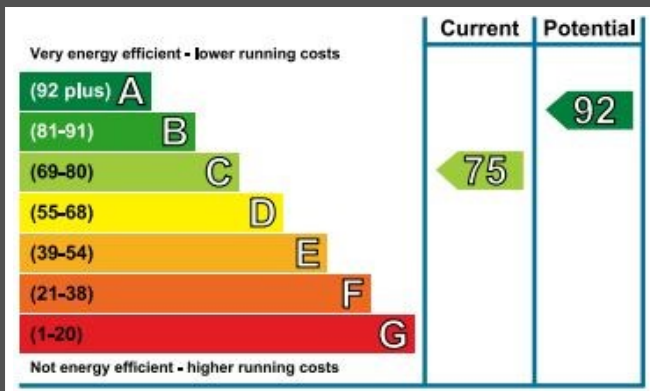

These particulars are set out as a general outline in accordance with the Property Misdescriptions Act (1991) only for the guidance of intending purchasers or lessees, and do not constitute any part of an offer or contract. Details are given without any responsibility, and any intending purchasers, lessees or third parties should not rely on them as statements or representations of fact but must satisfy themselves by inspection or otherwise as to the correctness of each of them. We have not carried out a structural survey and the services, appliances and specific fittings have not been tested. All photographs, measurements, floor plans and distances referred to are given as a guide only and should not be relied upon for the purchase of carpets or any other fixtures or fittings. Gardens, roof terraces, balconies and communal gardens as well as tenure and lease details cannot have their accuracy guaranteed for intending purchasers. Lease details, service ground rent (where applicable) are given as a guide only and should be checked and confirmed by your solicitor prior to exchange of contracts. No person in the employment of Love Homes has any authority to make any representation or warranty whatever in relation to this property. Purchase prices, rents or other prices quoted are correct at the date of publication and, unless otherwise stated, are exclusive of VAT. We retain the copyright in all advertising material used to market this Property.