



- SUPERB REFURBISHMENT THROUGHOUT
- CHAIN FREE
- THREE BEDROOMS
- STUNNING FITTED KITCHEN

### Pinnacles, Waltham Abbey, EN9 1TG

SUPERBLY AND COMPLETELY refurbished three bedroom semi-detached property in a central location walking distance of schooling for all ages and local shops. Large lounge, guest cloakroom WC, modern high gloss kitchen with integrated appliances. Three good size bedrooms. CHAIN FREE

**PRICE: £379,995 FREEHOLD**



## Property Description

Absolutely stunning three bedroom semi-detached property which has been completely and thoroughly refurbished by the current owners to create a modern and stylish interior offering a cool and light colour palette throughout.

This property has had major investment to include new full double glazing, a brand new high gloss kitchen with integrated appliances and new gas boiler in recent months.

The accommodation in brief comprises an entrance lobby which grants access to the guest cloakroom/WC. The large lounge which faces the front aspect has an open plan staircase and leads through to the modern kitchen/breakfast room at the rear of the property.

A cool grey high gloss kitchen with fully integrated appliances and contrasting work surface is set open plan to the breakfast area and double glazed patio doors lead onto the modern courtyard garden.

Three good size bedrooms grace the first floor and these are supported by a modern bathroom with white three piece suite.

Every element of the property has been upgraded as previously mentioned but in addition there is has been full redecoration and new floor coverings throughout the whole property.

Externally there is a good size lawned front garden and the rear courtyard garden which offers a good degree of privacy has been laid to a grey stone slab creating a modern courtyard feel.





Being offered chain free, early viewing is highly recommended.

**ACCOMMODATION IN BRIEF COMPRISES:**

**ENTRANCE LOBBY**

5' 3" x 3' 5" (1.6m x 1.04m)

**GUEST CLOAKROOM/WC**

4' 7" x 2' 4" (1.4m x 0.71m)

**LOUNGE**

15' 8" x 14' 5" (4.78m x 4.39m)

**KITCHEN**

7' 8" x 7' 8" (2.34m x 2.34m)

**BREAKFAST AREA**

8' 5" x 7' 9" (2.57m x 2.36m)

**FIRST FLOOR LANDING**

**BEDROOM ONE**

14' 4" x 8' 8" (4.37m x 2.64m)

**BEDROOM TWO**

8' 8" x 8' 6" (2.64m x 2.59m)

**BEDROOM THREE**

8' 8" x 6' 8" (2.64m x 2.03m)

**BATHROOM**

6' 2" x 5' 4" (1.88m x 1.63m)

**EXTERIOR**



### Ground Floor

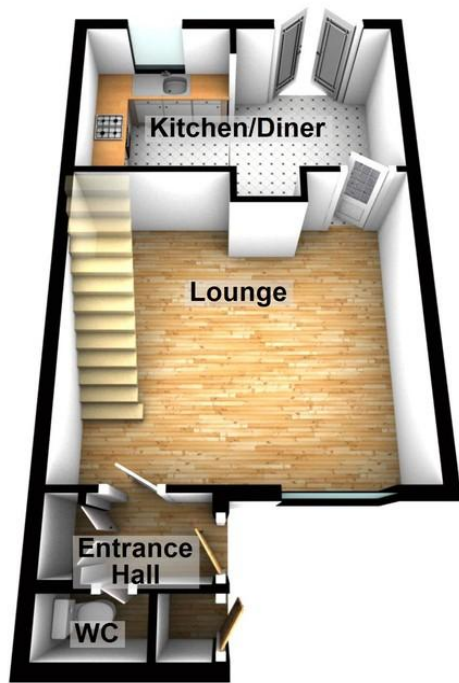

### First Floor



FRONT GARDEN

REAR GARDEN

### TENURE

Freehold title

Council Tax Band D - Epping Forest District Council

25 Market Square, Waltham Abbey,  
Essex, EN9 1DU

[www.rainbowestateagents.co.uk](http://www.rainbowestateagents.co.uk)

01992 711222

[rebecca@rainbowestateagents.co.uk](mailto:rebecca@rainbowestateagents.co.uk)

Agents Note: Whilst every care has been taken to prepare these particulars, they are for guidance purposes only. All measurements are approximate and for general guidance purposes only and whilst every care has been taken to ensure their accuracy, they should not be relied upon and potential buyers/tenants are advised to recheck the measurements