







1 BEDROOM 1 BATHROOM 1 RECEPTION ROOM

A bright spacious one bedroom apartment located on the 5th Floor (with lift) and comprises of a good size reception room with plenty of character including a fireplace, separate modern eat-in kitchen, a double bedroom with plenty of storage and bathroom.

There have been some works in the property to repaint and replace floors.

The property is available from early February 2023.

Page Street is located in the Heart of Westminster and close to all the amenities of Victoria Street. Transportation is provided via Victoria (Victoria, Circle, District and Mainline Services) Pimlico (Victoria) and St James's Park (Circle and District).





PAGE STREET  
SW1  
CITY OF WESTMINSTER

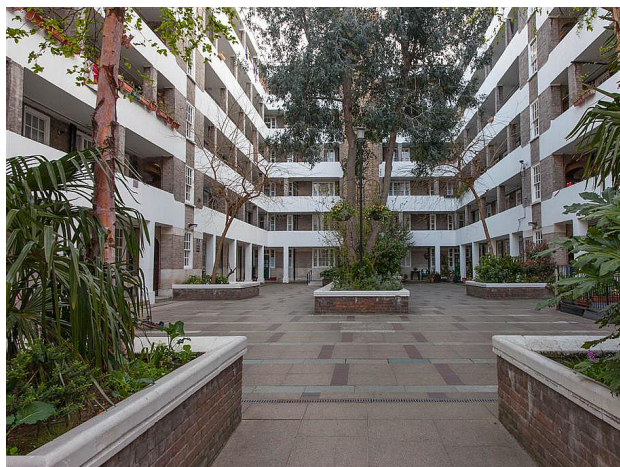

PAGE STREET, WESTMINSTER, LONDON, SW1P

At a glance:

- Top Floor with lift
- Fully Furnished
- Bright with wood floors
- Available early February 2023



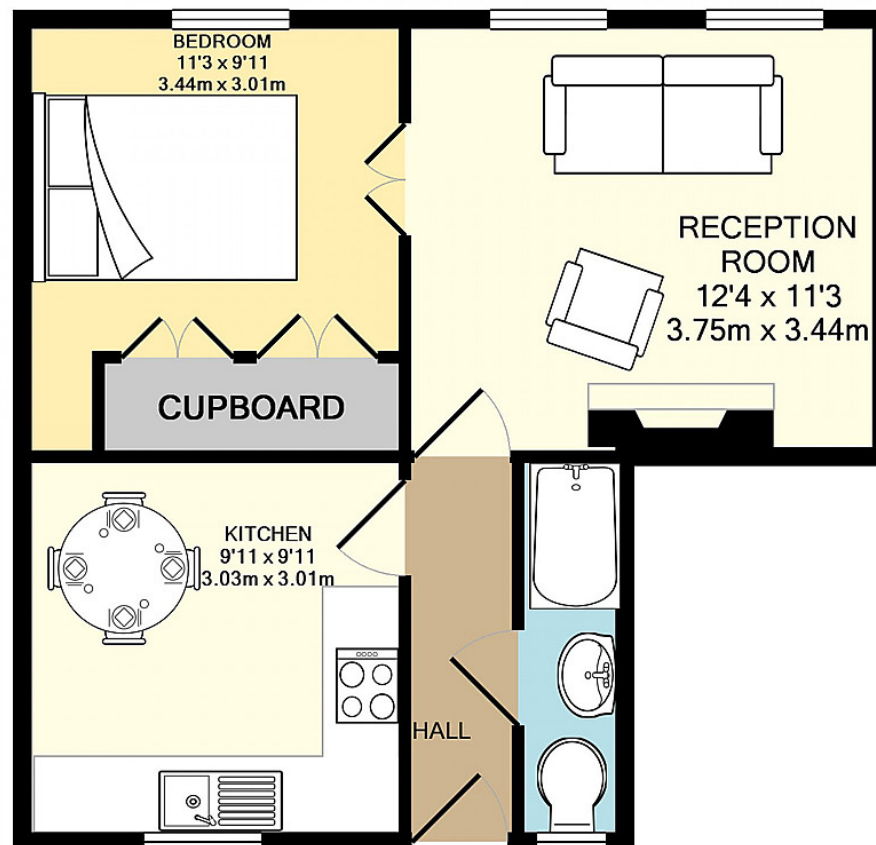

TOTHILL HOUSE, PAGE STREET, WESTMINSTER, SW1P  
TOTAL APPROX. FLOOR AREA 405 SQ.FT. (37.6 SQ.M.)  
Measurements are approximate. Not to scale. Illustrative purposes only  
Made with Metropix ©2011