



61 Ebery Grove, Baffins

Portsmouth

Offers in Region of £390,000

 chinneckshaw



61 Ebery Grove

Baffins, Portsmouth

In the much sought after residential area of Baffins, this four bedroomed house has space for all the family. The house provides easy access to the Eastern Road, fabulous facilities at Baffins Pond, Great Salterns along with primary and secondary schools and local amenities on Tangier Road. The entrance hall is bright with glazed doors and window surround. Storage is offered under the stairs. The front reception room has a feature fireplace and square bay. The second reception has been extended and provides family dining space with patio doors out to the garden and access to a downstairs WC. The kitchen has a range of shaker style units with space for a cooker, fridge freezer, washing machine, worktops along both sides give an ample food prep area. There are three bedrooms on the first floor, the principal bedroom to the front has a square bay and built in wardrobes along one wall, the second room to the rear also has a built in wardrobes along one wall. The third room is a single room and is currently fitted out as a home office. The modern bathroom has a white suite with a roll top stand alone bath, panel tiling and a towel rail. The second floor has a double dormer bedroom suite with views across the rooftops from the juliette balcony. The ensuite has a shower with modern white toilet, basin, floor to ceiling splashback panels and a towel rail. This a stunning space. The garden is low maintance with sitting area and a path to the to large double garage at the rear. The garage has vehicular access and an up and over electric door.

Council Tax band: C Tenure: Freehold





Hallway
13'7" x 5'7"
4.16 x 1.73 m

Ground Floor Building 1

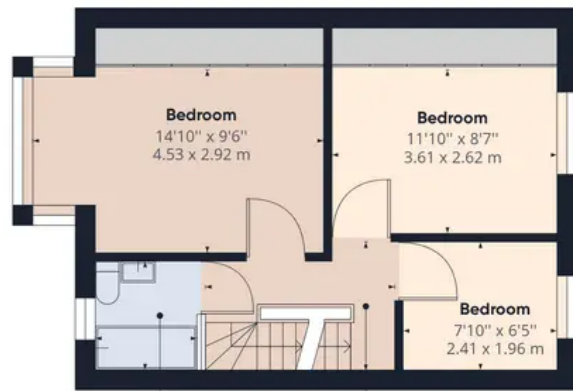

WC
5'9" x 5'7"
1.76 x 1.73 m

Landing
9'10" x 6'5"
3.01 x 1.97 m

Floor 1 Building 1

chinneck
shaw



Landing
2'8" x 2'9"
0.83 x 0.85 m

Bathroom
5'11" x 6'6"
1.83 x 1.99 m

Floor 2 Building 1



Ground Floor Building 2

Approximate total area⁽¹⁾
1623.96 ft²
150.87 m²

(1) Excluding balconies and terraces

While every attempt has been made to ensure accuracy, all measurements are approximate, not to scale. This floor plan is for illustrative purposes only.

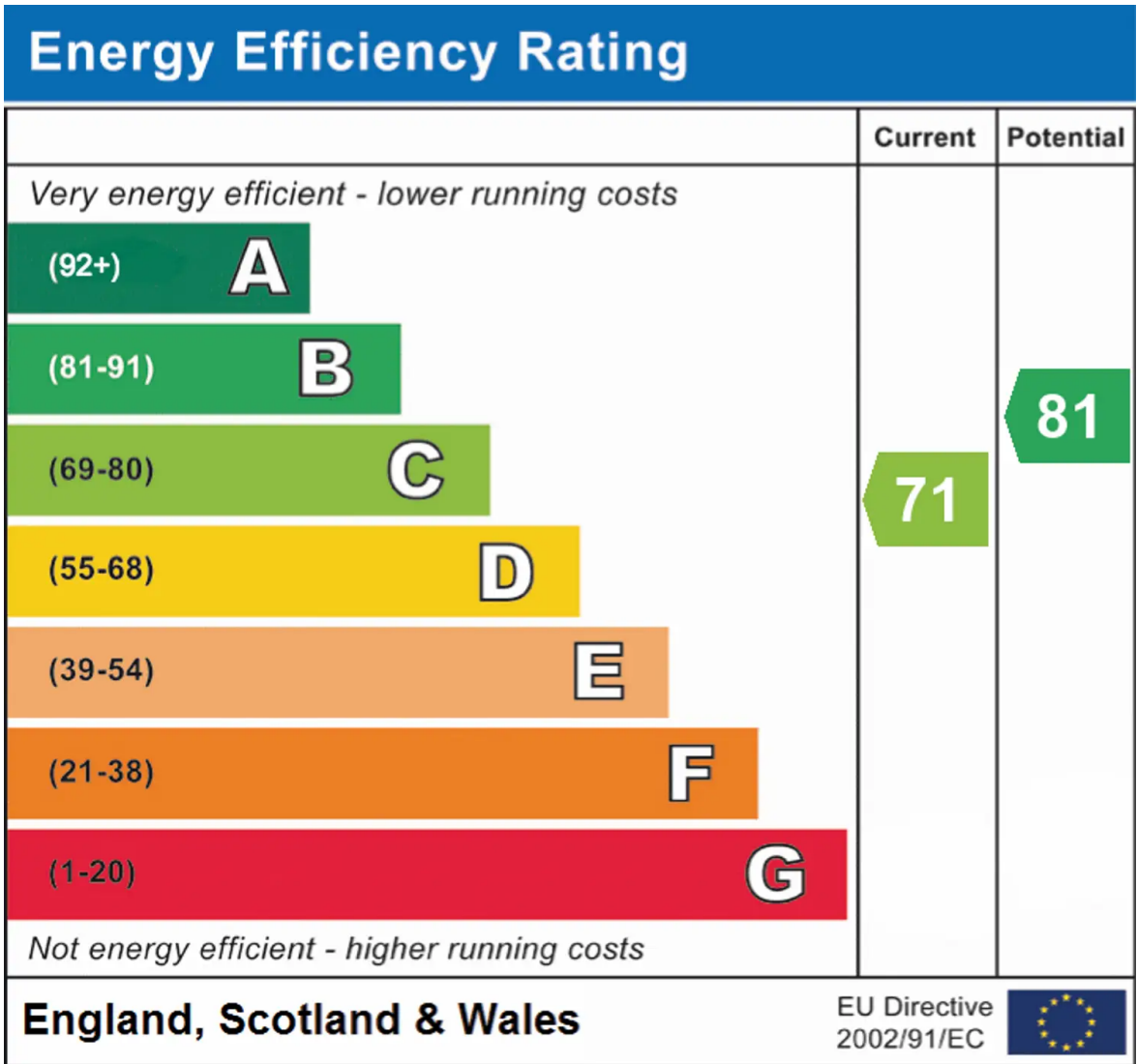

Chinneck Shaw

Bridge House, Milton Road, Portsmouth – PO3 6AN

023 9282 6731

hello@chinneckshaw.co.uk

www.chinneckshaw.co.uk/

Chinneck Shaw, Bridge House, Milton Road, PO3 6AN Consumer Protection from Unfair Trading Regulations 2008: These details are for guidance only and complete accuracy cannot be guaranteed. If there is any point which is of particular importance, verification should be obtained. The do not constitute a contract or part of a contract. All measurements are approximate. No guarantee can be given with regard to planning permissions or fitness for purpose. No apparatus, equipment, fixture or fitting has been tested. Items shown in the photographs are NOT necessarily included. Interested Parties are advised to check availability and make an appointment to view before travelling to see a property.