



5 Heathdene Manor, Grandfield Avenue, Watford, Hertfordshire, WD17 4PZ

Asking Price £100,000 Leasehold

sewell &
gardner

About the property

One bedroom ground floor retirement property for the over 60's located in Nascot Wood.

A well presented one bedroom ground floor retirement flat located in the popular Heathdene Manor in Nascot Wood. The property has one double bedroom, lounge with access to the kitchen and a bathroom. From the lounge you have access direct onto the communal gardens. In the block you will find a residents lounge, laundry room and guest suite for family to stay while visiting (please note there is a small charge for this). There is also a resident house manager Monday to Friday. The property is to be offered with No Upper Chain.



- One bedroom apartment
- Retirement property
- No upper chain
- Communal gardens
- Service charge £2,363 pa
- Leasehold 96 years 4 months

Ground Floor

Approx. 43.9 sq. metres (472.1 sq. feet)

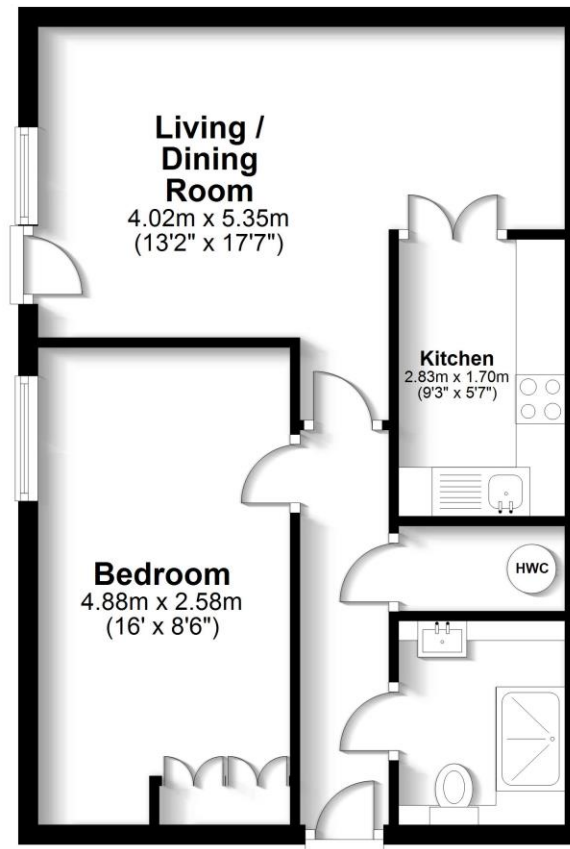

Total area: approx. 43.9 sq. metres (472.1 sq. feet)

FOR ILLUSTRATIVE PURPOSES ONLY - NOT TO SCALE
The position and size of doors, windows, appliances and other features are approximate only. Total areas inc garages & outbuildings.
© My Home Property Marketing - Unauthorised reproduction prohibited.
Plan produced using PlanUp.

To view this property, contact us on-

T: 01923 776400 E: ricky@sewellgardner.com

165-167 High Street, Rickmansworth, WD3 1AY



Area Information

Watford is a desirable location for many as it offers an ideal balance of urban and rural living. With a vibrant town centre and excellent transport links into London combined with plenty of green space, Watford offers the best of both worlds.

Watford Town Centre has a variety of entertainment and retail options, including a big shopping centre, large Cineworld Imax cinema and a vibrant restaurant hub. There are also various sports facilities including golf, football, tennis and cricket and many leisure & health clubs close by. Notably, Watford is home to one of England's most luxurious golf courses at The Grove, Chandlers Cross. Watford is surrounded by some beautiful countryside with many locations to enjoy walking and cycling. Cassiobury Park is a popular attraction, being the largest public open space in Watford with over 190 acres of green space catering for all ages, including sports facilities, kids' attractions & a nature reserve.

Local Authority: Watford Borough Council
 Council Tax: C
 Approximate floor area: 472.1 sq ft
 Tenure: Leasehold

Nearest Station: 0.8 miles to Watford Junction
 Distance to Town Centre: 2.5 miles to Watford
 Nearest Motorway: 3 miles to M25



Energy Efficiency Rating		
	Current	Potential
Very energy efficient - lower running costs		
(92+) A		
(81-91) B		
(69-80) C	80	83
(55-68) D		
(39-54) E		
(21-38) F		
(1-20) G		
Not energy efficient - higher running costs		
England, Scotland & Wales	EU Directive 2002/91/EC	

Every care has been taken to ensure that the details in this brochure represent an accurate description of the property. However, we wish to inform prospective purchasers that these sales particulars are a general guide and none of the statements or dimensions should be relied upon as statements of representation or fact. Transparency of referral fees: We're legally required to inform you that we receive referral income from the following solicitors and surveyors up to the value of £125.00 per transaction; Archer Rusby Solicitors LLP, Taylor Walton Solicitors, Hanney Dawkins & Jones Solicitors, New Homes Law, Edwards Willoby & Loch, Woodward Surveyors & Trend & Thomas Surveyors. For financial services we recommend Severn Financial from which we don't take a referral fee but one of our directors does have a vested interest in the business. We also recommend Meridian Mortgages and receive an average referral income of £288.40 per transaction. Although we recommend these companies because we believe they offer an excellent service, you are not under any obligation to use them.

