

TO LET



Worlds End Estate, Chelsea
£2,900 pcm

MARTIN&CO

Worlds End Estate, Chelsea

Two Bedroom Apartment in Chelsea,
SW10,
2 bedroom, 1 bathroom

£2,900 pcm

Date available:

Deposit: £3,346.15

Unfurnished

Council Tax band: C

- Fantastic Location
- Two Double Bedrooms, Master can accommodate a king size bed
- Refurbished
- South Facing Balcony
- Heating & Hot Water Included
- Separate Kitchen with Dishwasher & ...

This recently refurbished apartment sits on the second floor (with lift) of a purpose built apartment block and comprises a large living room, separate kitchen (includes dishwasher), two double bedrooms, one bathroom and separate WC. It has excellent storage, and a spacious balcony that can be accessed from the kitchen. Heating & hot water are included in the rent.

Within 10 minutes walking distance from Imperial Wharf station (Rail) & Fulham Broadway Station (Tube) and it also offers an excellent local bus service which connects easily



with Sloane Square. Desired local amenities are also close by as are good schools, gyms etc.

Residents are eligible for the RBKC permit and there is the option of secure underground parking (at extra cost).

Offered Unfurnished.



%epcGraph_c_1_322%

Middle Dartrey Walk Worlds End Estate, SW10

Total Internal Gross Area
75 sq m / 807 sq ft

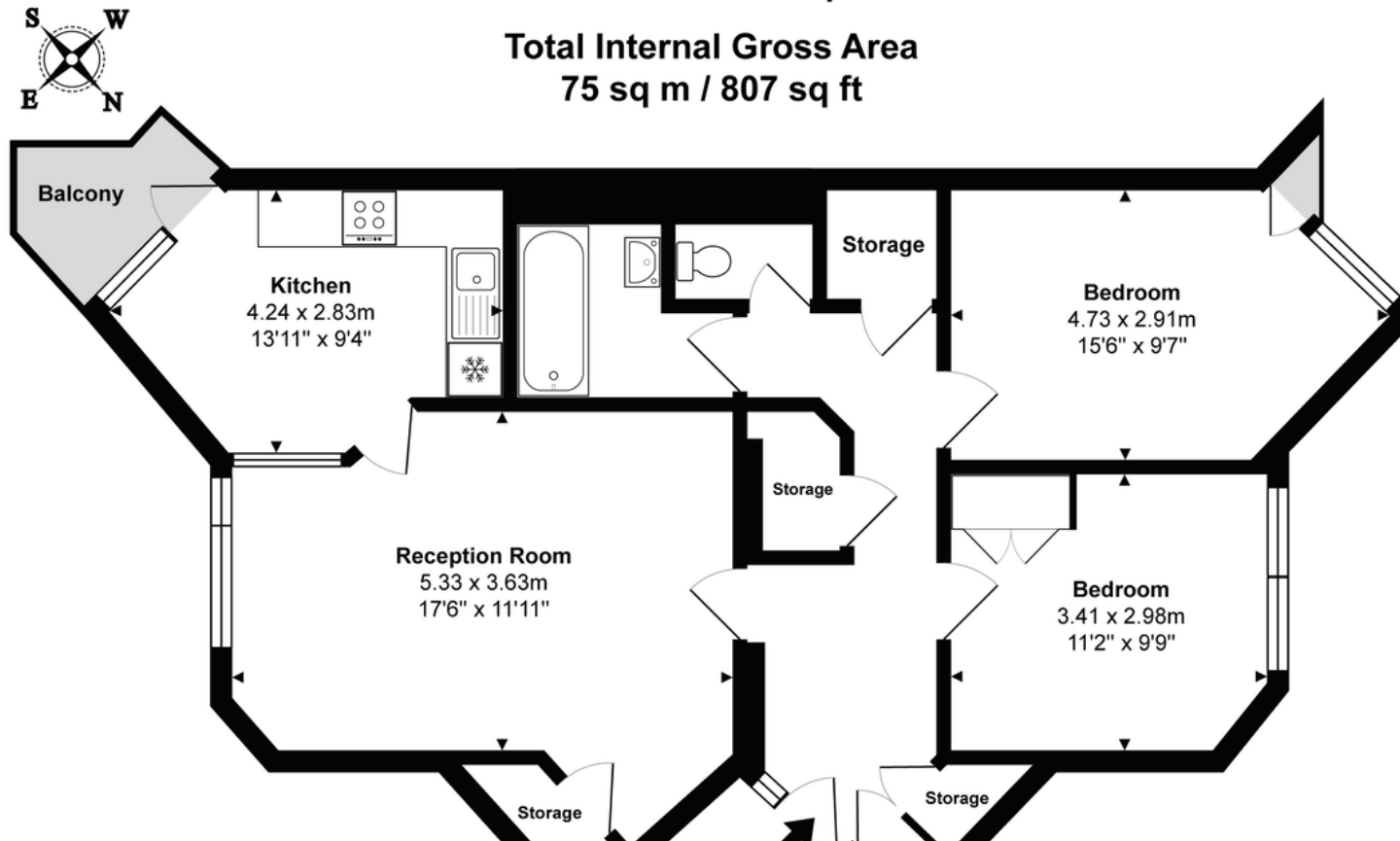

Martin & Co Chelsea Riverside

1 Cremorne Road • London • SW10 0NA
T: 020 7351 0387 • E: chelseariverside@martinco.com

020 7351 0387
<http://www.martinco.com>

MARTIN&CO

Accuracy: References to the Tenure of a Property are based on information supplied by the Seller. The Agent has not had sight of the title documents. A Buyer is advised to obtain verification from their Solicitor. Items shown in photographs including but not limited to carpets, fixtures and fittings are not included unless specifically mentioned within the sales particulars. They may however be available by separate negotiation. Buyers must check the availability of any property and make an appointment to view before embarking on any journey to see a property. No person in the employment of the agent has any authority to make any representation about the property, and accordingly any information given is entirely without responsibility on the part of the agents, sellers(s) or lessors(s). Any property particulars are not an offer or contract, nor form part of one. **Sonic / Laser Tape:** Measurements taken using a sonic / laser tape measure may be subject to a small margin of error. **All Measurements:** All Measurements are Approximate. **Services Not tested:** The Agent has not tested any apparatus, equipment, fixtures and fittings or services and so cannot verify that they are in working order or fit for the purpose. A Buyer is advised to obtain verification from their Solicitor or Surveyor.