



**CHISWELL & CO**  
RESIDENTIAL SALES & LETTINGS

TERRACE ROAD, BOURNEMOUTH, BH2 5NJ  
ASKING PRICE OF £120,000





**LOUNGE**

11' 7" x 11' 1" (3.54m x 3.38m)

**KITCHEN**

6' 6" x 4' 4" (2m x 1.33m)

**SHOWER ROOM**

4' 5" x 6' 6" (1.36m x 2m)

**BEDROOM**

11' 5" x 11' 0" (3.5m x 3.37m)



GROUND FLOOR  
350 sq. ft. (32.5 sq.m.) approx.

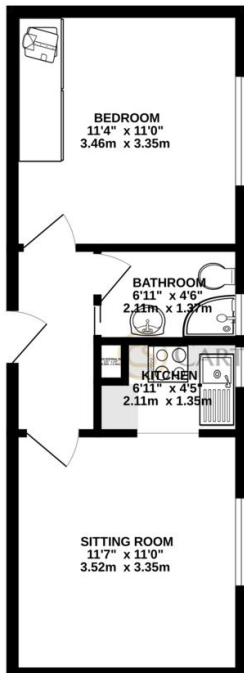

%epcGraph\_c\_1\_304%