



Julian Reid

**127 Shakspeare Walk, London, N16 8TB**

Elegant, early Victorian terraced house offering contemporary, family space on a quiet, popular residential road midway between Stoke Newington Church Street and Newington Green.

[julianreid.co.uk](http://julianreid.co.uk)

**Guide Price £1,500,000**  
**Freehold**

- **5 Bedrooms**
- **Council Tax Band: F**
- **EPC Rating: C**
- **Home Office/studio**
- **Beautifully presented**

Elegant, early Victorian terraced house offering beautifully presented accommodation over three floors. Super, bright, family space with a mixture of contemporary and period character. There are 5 bedrooms, large family bathroom and second shower room. The ground floor is quite open-plan with wonderful reception space opening to a beautifully fitted kitchen/diner and glass doors opening to the rear garden. To the rear of the garden there is a large home office/studio which can also be used as occasional guest bedroom. The property has the benefit of solar panels on the roof, an electric car charging point and secure bike storage to the front. Shakspeare Walk is a very popular road midway between the vibrant selection of shops bars and restaurants on both Stoke Newington Church Street and Newington Green. There are regular bus services to both the City and West End.



Julian Reid  
51 Stoke Newington Church Street London N16 0AR  
[jreid@julianreid.co.uk](mailto:jreid@julianreid.co.uk) Fax: 020 7923 8651  
+44 (0) 20 7923 8650



Ground Floor



First Floor

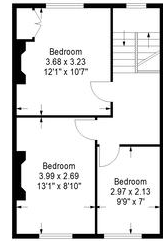

Second Floor

**Shakespeare Walk**  
Approximate Gross Internal Area

Studio = 162 sq ft / 15.05 sq m  
Ground Floor = 818 sq ft / 77.41 sq m  
First Floor = 504 sq ft / 46.82 sq m  
Second Floor = 404 sq ft / 37.53 sq m  
Total = 1686 sq ft / 156.82 sq m



JULIAN REID SPECIAL DISCLAIMER:-  
For Illustration Purposes Only - Not To Scale  
Floor plan For Julian Reid

**Important notice:** Julian Reid, their clients and any joint agents give notice that: **1:** They are not authorized to make or give representations or warranties in relation to the property either here or elsewhere, either on their own behalf or on behalf of the client or otherwise. They assume no responsibility for any statement that may be made in these particulars. These particulars do not form part of any offer or contract and must not be relied upon as statements or representations of fact. **2:** Any areas, measurements or distances are approximate. The text, photographs and plans are for guidance only and are not necessarily comprehensive. It should not be assumed that the property has all necessary planning, building regulation or other consents and Julian Reid have not tested any services, equipment or facilities. Purchasers must satisfy themselves by inspection or otherwise.

