

Morris Place, Finsbury Park
London N4 3JG

artsbuildinglondon.com

Arts Building



Did someone say 'bright and airy'? With full-height windows running the length of the building, this New York loft-style space feels natural and homely.

1st Level	Fully Fitted & Furnished
Available Space	4,782 sq ft
Specifications	<ul style="list-style-type: none">- Fully fitted- Generous floor to ceiling height- Exposed concrete ceilings- High specification & adjustable lighting system- Exposed ceiling mounted air conditioning units- Accessible toilet facilities- Floor to ceiling windows- Dual aspect- Fitted kitchen- Desks: 56

1st Level

[1st Level hypothetical fit-out VR tour](#)

1st Level

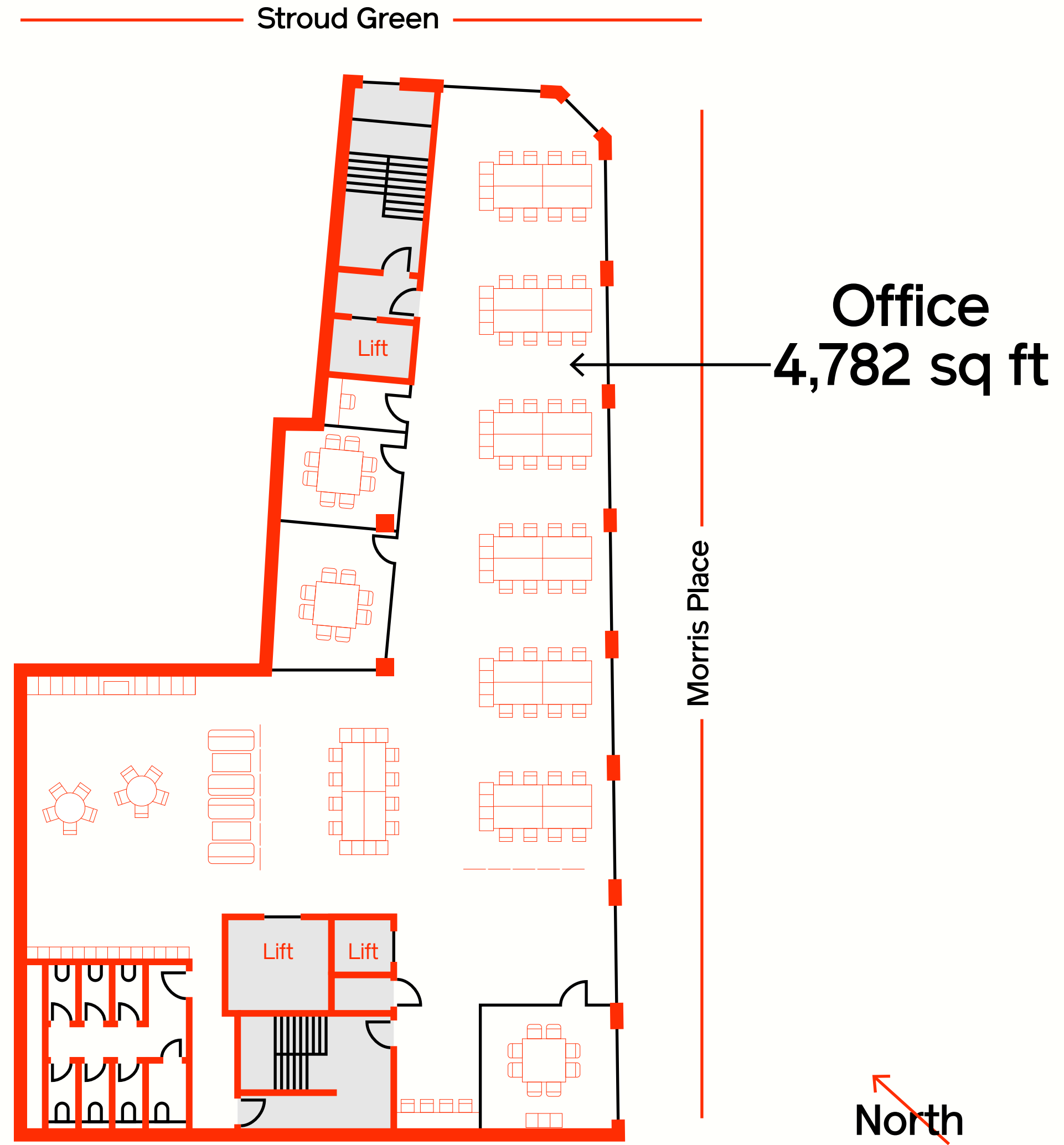

ArtsBuilding



1st Level



Amenities

-  Communal terrace
-  Generous floor to ceiling height
-  Exposed concrete ceilings
-  High specification & adjustable lighting system
-  Exposed ceiling mounted air conditioning units
-  Passenger & goods lifts
-  DDA compliant building
-  Floor to ceiling windows
-  Dual aspect
-  Communal kitchen

Communal terrace



Food & Drink

- 1 Cats
- 2 Common Ground
- 3 The Deli at 80
- 4 La Fabrica
- 5 Faltering Fullback
- 6 Itto
- 7 M&S Foodhall
- 8 Petek
- 9 Season Kitchen
- 10 The World's End
- 11 Yard Sale Pizza
- 12 The WB Yeats
- 13 Honest Burgers
- 14 Shop Cuvée
- 15 Book Bar
- 16 Max's Sandwich Shop
- 17 Fink's Salt and Sweet
- 18 Gail's

Entertainment

- 19 Park Theatre
- 20 The Night Owl
- 21 Finsbury Park Picturehouse **soon!**
- 22 Rowans Tenpin Bowling
- 23 Someday Canteen and Bar **soon!**
- 24 Various festivals in Finsbury Park

Wellbeing

- 25 Finsbury Park
- 26 More Yoga **soon!**
- 27 Pure Gym
- 28 Gymbox
- 29 Castle Climbing Centre
- 30 Arsenal Football Ground
- 31 F45

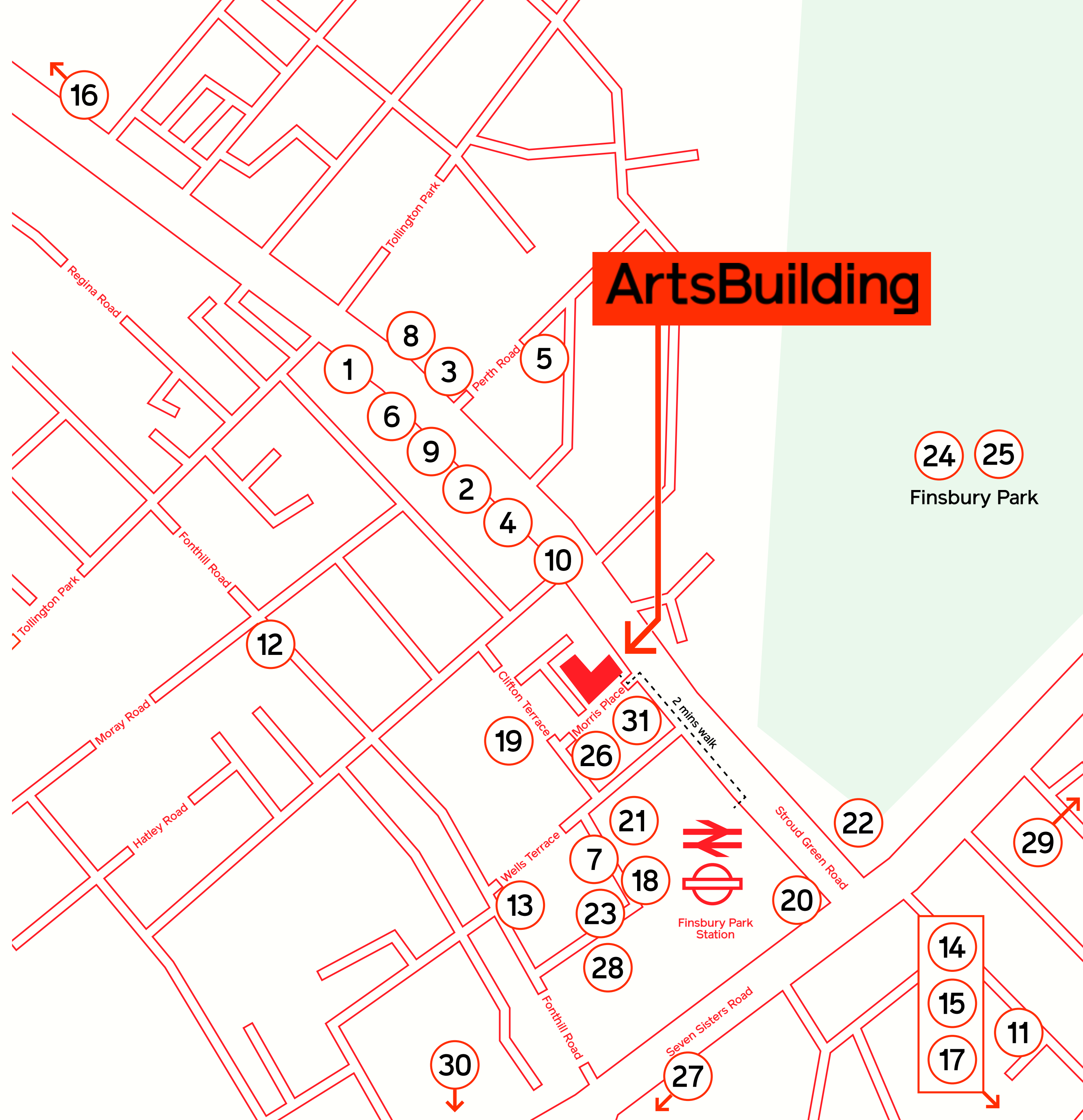

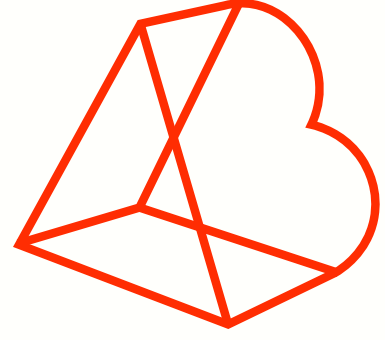

Morris Place, Finsbury Park
London N4 3JG

artsbuildinglondon.com

Contact

BELCOR

Oli Cohen

oc@belcor.london

T: +44 (0) 20 7375 3444

M: +44 (0) 7740 110063

Joe Meisel

jm@belcor.london

T: +44 (0) 20 7375 3444

M: +44 (0) 7872 350838

Compton

Oliver Jay

oj@compton.london

T: +44 (0) 20 7101 2020

M: +44 (0) 7903 714187

Joshua Perlmutter

jp@compton.london

T: +44 (0) 20 7101 2020

M: +44 (0) 7814 699096

Development by

Oval Real Estate

+44 (0)207 629 1656

ovalrealestate.com

Oval

The Pilcher Hershman partnership LLP and Compton Property Consultants Ltd on their behalf and for the lessor of this property whose agents they are, give notice that: 1. These particulars are set out as a general outline only for guidance to intending lessees, and do not constitute any part of an offer or contract. 2. Whilst they have used reasonable endeavours to ensure that the information in these particulars is materially correct, any intending lessees or third parties should not rely on them as statements or representations of fact, but must satisfy themselves by inspection, searches, enquiries, surveys or otherwise as to their accuracy. The agents as such cannot be held responsible for any loss or damage including without limitation, indirect or consequential loss or damage, or any loss of profits resulting from direct or indirect actions based upon the content of these particulars. 3. No person in the employment of the pilcher hershman partnership llp has any authority to make any representation or warranty whatsoever in relation to this property. 4. Unless otherwise stated, all rents are correct at the date of publication and, unless otherwise stated, are quoted exclusive of vat. Lease details and service charges are given as a guide only and should be checked and confirmed by your solicitor prior to exchange of contracts.