

# Abberley Grove

Stafford, ST17 4FE



A stylish modern detached house conveniently situated for Stafford town centre and amenities. Competitively priced for an early sale with an easily managed garden, side garage and driveway parking.

£245,000



John German

An attractively designed and thoughtfully planned detached modern home located at the head of a cul de sac and having a part walled garden, gas central heating and uPVC double glazing.

Step over the front door threshold and you will find yourself in a good-sized reception hall with laminate flooring, cloaks storage cupboard, stairs to first floor and access to a white and chrome fitted two-piece guest's cloakroom.

Leading off the hall is an attractive lounge with laminate flooring and windows to the front and side.

Also leading off the centrally positioned hall is a spacious and well-appointed dining kitchen with French windows within the dining area that lead directly into the garden. The kitchen has a full range of high gloss base and wall units together with contrasting worktops, inset one and a half bowl sink unit, built in electric oven/grill, four burner gas hob, extractor hood and tiled floor.

On the first floor a centre landing provides access to the three bedrooms, family bathroom and airing cupboard.

The master bedroom has built in wardrobes and access to its own en suite shower room with a three-piece white and chrome suite, and partial tiling.

Bedroom two has a built in wardrobe and side aspect window, bedroom three also has a built in wardrobe and front aspect window.

The family bathroom is fitted with a contemporary white and chrome suite to include bath with mains shower unit above, low level WC, vanity unit/wash hand basin, tiled floor and front aspect window.

Outside a single garage is located in a close neighbouring block with up and over door. Driveway parking for one car in front of the garage.

There is a part walled and gravelled garden to the right hand side of the property and a further enclosed area of garden to the left hand side.

**Tenure:** Freehold (purchasers are advised to satisfy themselves as to the tenure via their legal representative).

**Services:** Mains water, drainage, electricity and gas are believed to be connected to the property but purchasers are advised to satisfy themselves as to their suitability.

**Useful Websites:** [www.staffordbc.gov.uk](http://www.staffordbc.gov.uk)

[www.gov.uk/government/organisations/environment-agency](http://www.gov.uk/government/organisations/environment-agency)

**Our Ref:** JGA/200223

**Local Authority/Tax Band:** Stafford Borough Council / Tax Band D

GROUND FLOOR

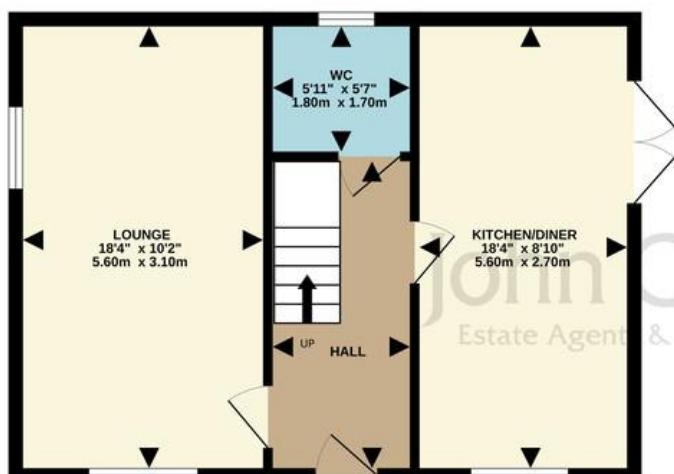

1ST FLOOR

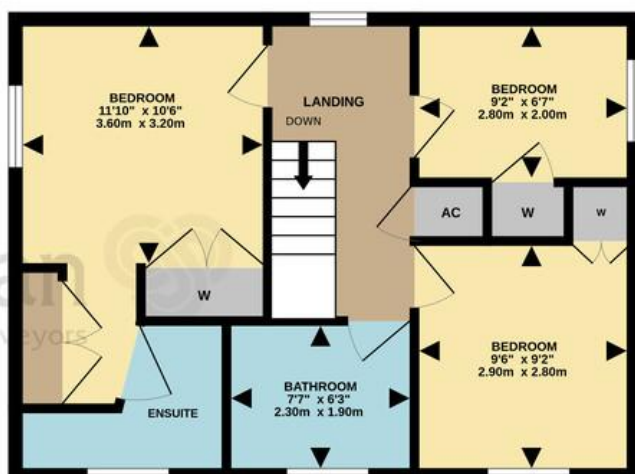

Whilst every attempt has been made to ensure the accuracy of the floorplan contained here, measurements of doors, windows, rooms and any other items are approximate and no responsibility is taken for any error, omission or mis-statement. This plan is for illustrative purposes only and should be used as such by any prospective purchaser. The services, systems and appliances shown have not been tested and no guarantee as to their operability or efficiency can be given.

Made with Metropix ©2023





Score	Energy rating	Current	Potential
92+	A		
81-91	B		89   B
69-80	C	78   C	
55-68	D		
39-54	E		
21-38	F		
1-20	G		



John German  
 5 Pool Lane, Brocton, Stafford, Staffords hire, ST17 0TR  
 01785 236600  
 stafford@johngerman.co.uk

#### Agents' Notes

These particulars do not constitute an offer or a contract neither do they form part of an offer or contract. The vendor does not make or give and Messrs. John German nor any person employed has any authority to make or give any representation or warranty, written or oral, in relation to this property. Whilst we endeavour to make our sales details accurate and reliable, if there is any point which is of particular importance to you, please contact the office and we will be pleased to check the information for you, particularly if contemplating travelling some distance to view the property. None of the services or appliances to the property have been tested and any prospective purchasers should satisfy themselves as to their adequacy prior to committing themselves to purchase.

#### Referral Fees

**Mortgage Services** - We routinely refer all clients to APR Money Limited. It is your decision whether you choose to deal with APR Money Limited. In making that decision, you should know that we receive on average £60 per referral from APR Money Limited.

**Conveyancing Services** - If we refer clients to recommended conveyancers, it is your decision whether you choose to deal with this conveyancer. In making that decision, you should know that we receive on average £150 per referral.

**Survey Services** - If we refer clients to recommended surveyors, it is your decision whether you choose to deal with this surveyor. In making that decision, you should know that we receive up to £90 per referral.

Ashbourne | Ashby de la Zouch | Barton under Needwood  
 Burton upon Trent | Derby | East Leake | Lichfield  
 Loughborough | Stafford | Uttoxeter

**JohnGerman.co.uk** Sales and Lettings Agent