

25  
YEARS

SERVING  
BEACONSFIELD  
SINCE 1998



53 Seeleys Road, Beaconsfield

Guide Price £935,000

*Ashington Page*



A well maintained family home ideally situated in a quiet location within easy walking distance to Beaconsfield new town and mainline station with trains to London Marylebone. This much loved three bedroom, detached property offers further potential to extend (subject to usual consents). Beaconsfield has an extensive range of shops, cafes, restaurants and excellent schools. The rolling Chiltern countryside is easily accessible.

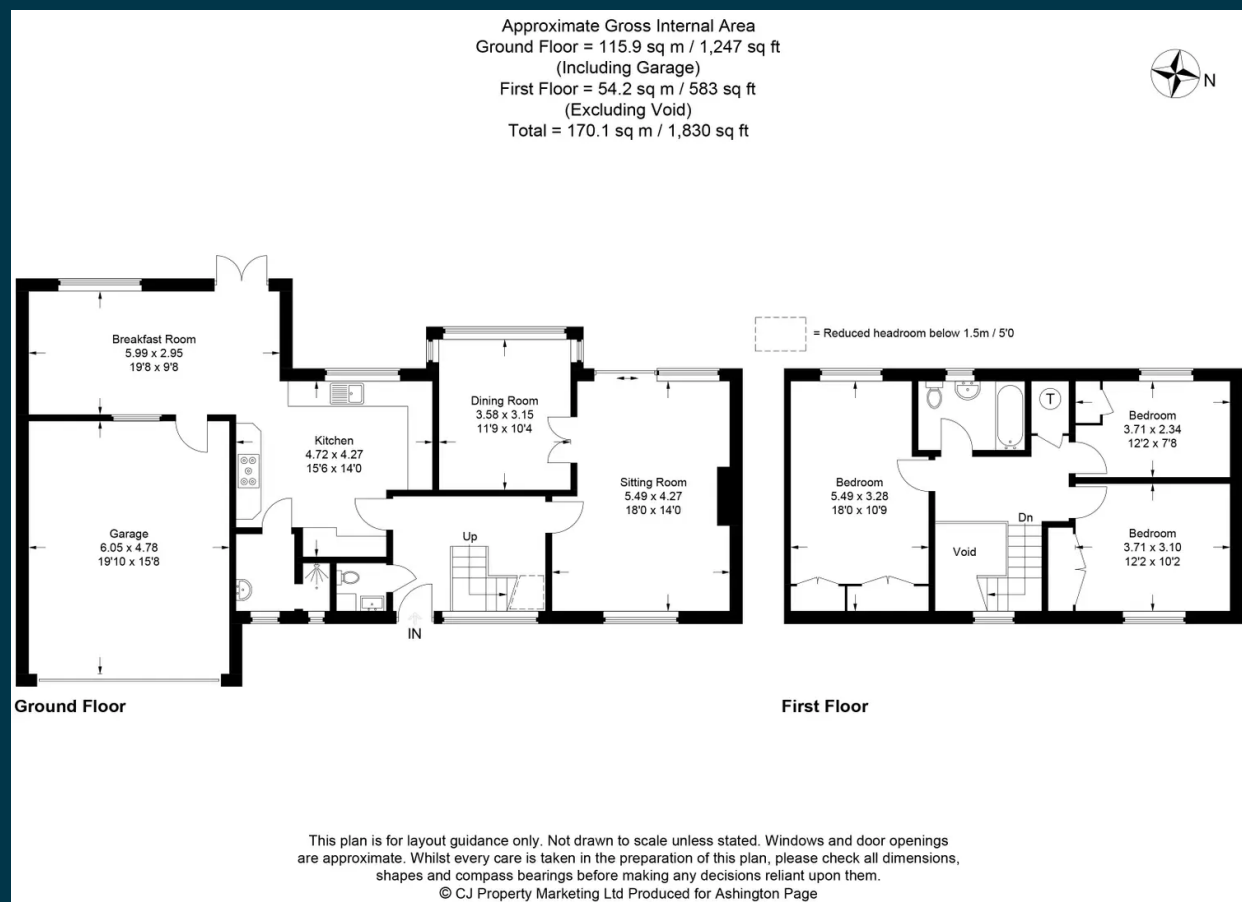

These particulars are for guidance only. They are prepared and issued in good faith and are intended to give a fair summary of the property. Any description should not be relied on as a statement or representation of fact or that the property, or its services, are in good condition. The photographs show only certain parts of the property at the time they were taken. Any areas, measurements or distance given are approximate only. Any reference to alterations to, or use of, any part of the property is not a statement that any necessary planning, building regulations or other consent has been obtained. These matters must be verified by an intending purchaser. All statements contained in these particulars in relation to the property are made without responsibility of Ashington Page or its clients. Neither Ashington Page (nor any joint agents) nor any of their employees has any authority to make or give any representation or warranty whatsoever in relation to the property



01494 680018  
 info@ashingtonpage.co.uk  
 www.AshingtonPage.co.uk

