



2 Bedroom Apartment **£160,000**

136 Saltash Road, Swindon, SN2 2EE

mcfarlane
property.com

2 Bedroom Apartment

Swindon, Old Town

-
- LARGER THAN AVERAGE APARTMENT AT OVER 70 SQ M
 - TWO DOUBLE BEDROOMS
 - EN-SUITE TO MASTER
 - GROUND FLOOR
 - GARAGE
 - POTENTIAL TENANT IN SITU
 - LONG LEASE REMAINING
-

A much larger than average two bedroom apartment on the ground floor presented in good order throughout. Accommodation briefly comprises: sitting/dining room, two double bedrooms with the master bedroom benefitting from built in wardrobes and en-suite shower room, fitted kitchen and family bathroom with three piece suite. Additional benefits to include single garage, double glazing, secure entry system and walking distance to Swindon Railway Station, Town Centre and the McArthur Glen Designer Outlet centre.

****Lease****

134 years remaining.

Annual Management Charge: £1,134.76

Annual Ground Rent Charge: £150.00





Ground Floor

Approx. 70.5 sq. metres (759.1 sq. feet)

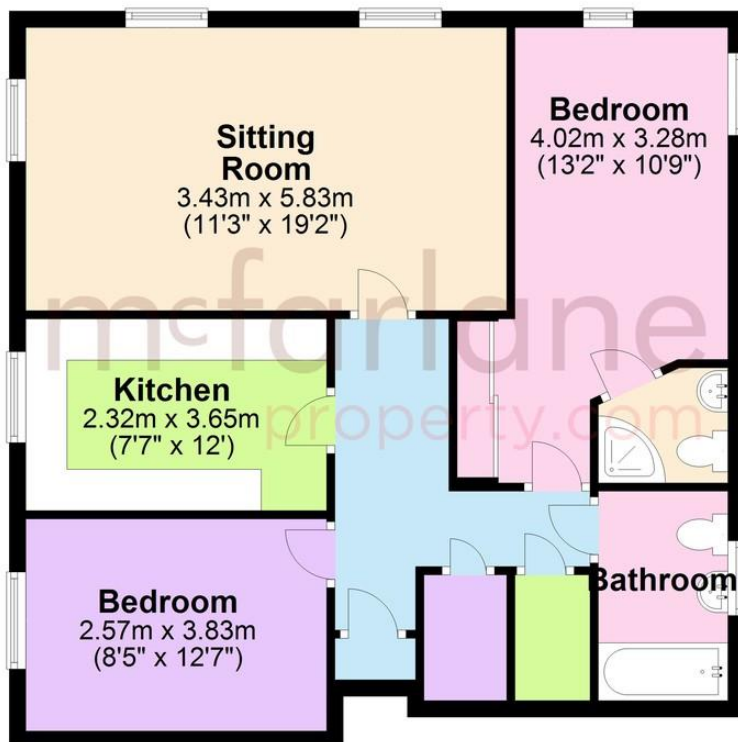

Total area: approx. 70.5 sq. metres (759.1 sq. feet)

We 
where you
LIVE

Our team are friendly, experienced and are all local. They know it better than they do their own living rooms and can help you find what you're looking for because **we love where we live.**

We would be delighted to show you around this property.

**Because every home
needs a personal touch.**

**If you would like to view this
property then please get in touch.**

📞 01793 296880

✉ oldtown@mcfarlaneproperty.com

mcfarlaneproperty.com

mcfarlane
property.com

Cricklade.

102 High Street
Cricklade SN6 6AA

📞 01793 751044

Marlborough.

106 High Street
Marlborough SN8 1LT

📞 01672 514380

Old Town.

28-30 Wood Street
Swindon SN1 4AB

📞 01793 296880

Swindon.

The Village Centre,
Redhouse SN25 2FW

📞 01793 296600

Agents Note: Whilst every care has been taken to prepare these sales particulars, they are for guidance purposes only. All measurements are approximate and are for general guidance purposes only and whilst every care has been taken to ensure their accuracy, they should not be relied upon and potential buyers are advised to recheck the measurements