

Water Street, Chorley

Chorley

In Excess of £135,000



An absolutely stunning two bedroom cottage in the heart of Chorley. Believed to be an original weavers cottage and approximately 200 years old this property is bursting with style and provenance. Step into the vestibule and from there into the gorgeous living room with log burning stove on a stone hearth in an imposing brick fireplace. Leading off is the kitchen comprising a range of wall and base units with space, power and plumbing for appliances, exposed beams and stonework and housing the annually serviced Ideal Logic boiler. To the rear, the cosy dining room overlooks the garden. Step through French windows down to the lovely cottage garden with mature planting, raised beds and vegetable plots, crushed slate and plenty of areas to sit. With private gated access to the rear this is a lovely place from which to watch the world go by. Back inside, carpeted stairs lead to the first floor landing. Bedroom one is a spacious double to the front with built in storage and ladder access to the boarded loft with light. Bedroom two is a comfortable single to the rear and the stylish bathroom comprises exposed brickwork with tiled flooring and elevations, wash hand basin, wc and free standing double ended bath with central faucet and rainfall shower over. Also boasting a cellar this delightful home is a wonderful place to live.



An absolutely stunning two bedroom cottage in the heart of Chorley. Believed to be an original weavers cottage and approximately 200 years old this property is bursting with style and provenance. Council Tax band: A

Tenure: Leasehold

- Beautifully presented
- Many period features
- Wood burning stove
- Gorgeous bathroom
- Good sized garden
- Video tour



Eccleston Branch
265 The Green, Eccleston, PR7 5TF
01257 451673

Coppull Branch
244 Spendmore Lane, Coppull, PR7 5DE
01257 794588

www.hometruthslancs.co.uk
office@hometruthslancs.co.uk



Ground Floor

Approx. 36.4 sq. metres (391.8 sq. feet)

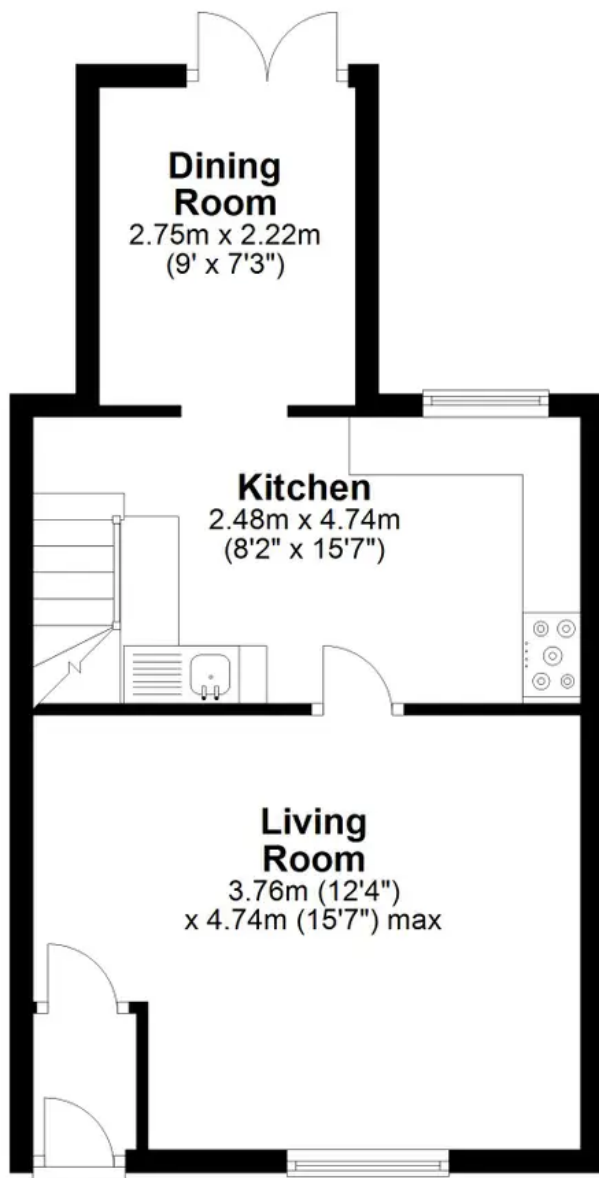

First Floor

Approx. 30.1 sq. metres (323.6 sq. feet)

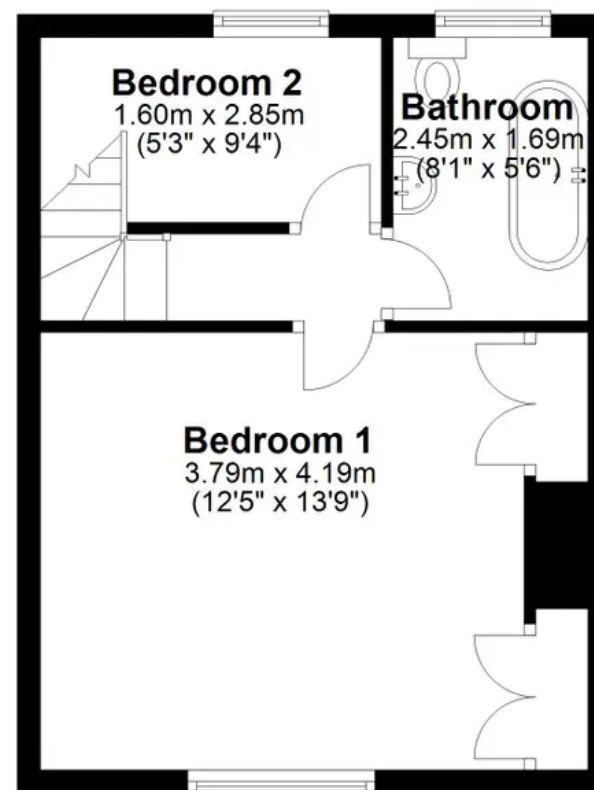

Total area: approx. 66.5 sq. metres (715.3 sq. feet)

THIS FLOOR PLAN IS FOR ILLUSTRATION ONLY AND IS NOT A SCALE DRAWING, SQFT IS AN APPROXIMATE GUIDE

Plan produced using PlanUp.