

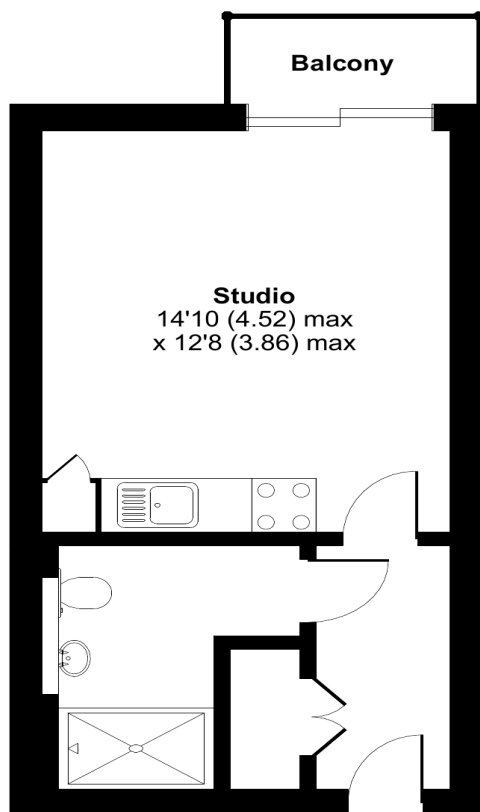

Yeo Street, London, E3

Approximate Area = 308 sq ft / 28.6 sq m
For identification only - Not to scale



THIRD FLOOR



Floor plan produced in accordance with RICS Property Measurement Standards incorporating International Property Measurement Standards (IPMS2 Residential). © nchecon 2023. Produced for Independent London Ltd. REF: 955099

All rooms have been measured with electronic laser and are approximate measurements only. None of the services to the above property have been tested by ourselves, and we cannot guarantee that the installations described in the details are in perfect working order. Independent London Lettings for themselves, and for the vendors or lessors, produce these brochures in good faith, and are a guideline only. They do not constitute any part of a contract and are correct to the best of our knowledge at the time of going to press.

Deposit: Five Weeks
Bedrooms: Studio
Bathrooms: 1
Furnished: Yes
Property Style: Modern/Urban
Location: Limehouse
Council Tax Band: C
EPC Rating: C
Parking: None
Nearest Transport:
Devons Road DLR or Bromley By Bow
for District Line and Hammersmith and
City

Independent London
6-8 Cole Street, Trinity Village,
London SE1 4YH
t: 020 7099 6373
e: hello@independentlondon.net

[independentlondon.co.uk](https://www.independentlondon.co.uk)
Landlords ask for The 5% Let Only
Service from Independent London

independent
london.
Right place. Right people.

