



**Saxondale Road, Wigston**

Leicester, LE18 3SY

# Property Summary

\*\*\* No Chain \*\*\* An ideal first time buy or investment property. A one bedroom mid town house for sale on Wigston Harcourt. The property requires some modernising and upgrading and comprises entrance hall, bathroom, open plan living kitchen and mezzanine bedroom. Call to book your viewing today!



GROUND FLOOR

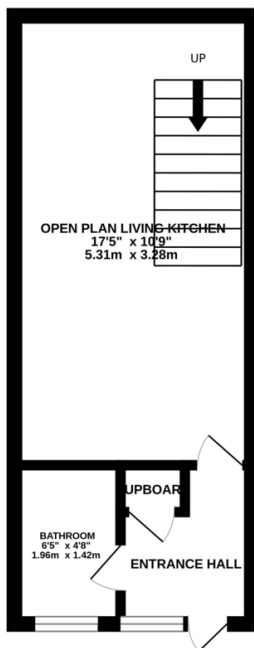

1ST FLOOR

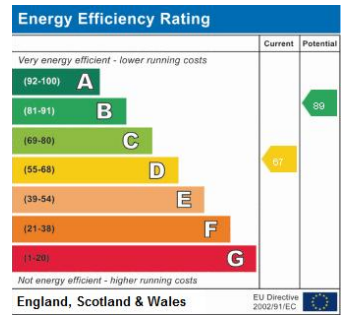
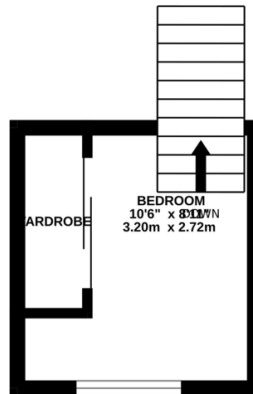

- No Chain
- One Bedroom
- Mid Town House
- Work Required
- Mezzanine Bedroom
- Popular Location
- Rear Garden
- On Street Parking

Whilst every attempt has been made to ensure the accuracy of the floorplan contained here, measurements of doors, windows, rooms and any other items are approximate and no responsibility is taken for any error, omission or mis-statement. This plan is for illustrative purposes only and should be used as such by any prospective purchaser. The services, systems and appliances shown have not been tested and no guarantee as to their operability or efficiency can be given.  
Made with Metropix ©2023

phillips george | sales & lettings

Agents Note: Whilst every care has been taken to prepare these sales particulars, they are for guidance purposes only. All measurements are approximate and for general guidance purposes only and whilst every care has been taken to ensure their accuracy, they should not be relied upon and potential buyers are advised to recheck the measurements

🏠 46 Long Street, Wigston, Leicestershire, LE18 2AH

✉ info@phillipsgeorge.co.uk  
☎ 0116 216 8178

