

25  
YEARS

SERVING  
BEACONSFIELD  
SINCE 1998



31 Ronald Road, Beaconsfield

Guide Price £700,000

*Ashington Page*

A charming and beautifully presented 4 bedroomed semi detached property with 2 bath/shower rooms, garden and off street parking. Located in a quiet residential road, this property benefits from being within equal walking distance to both the old and new towns of Beaconsfield. The station with direct links into London Marylebone is approximately an 8 minute walk away. There are excellent local primary, secondary and grammar schools close by and within catchment.

Tenure: Freehold

Directions : Sat Nav HP9 1AJ

EPC rating: E

Council Tax Band: South Buckinghamshire E

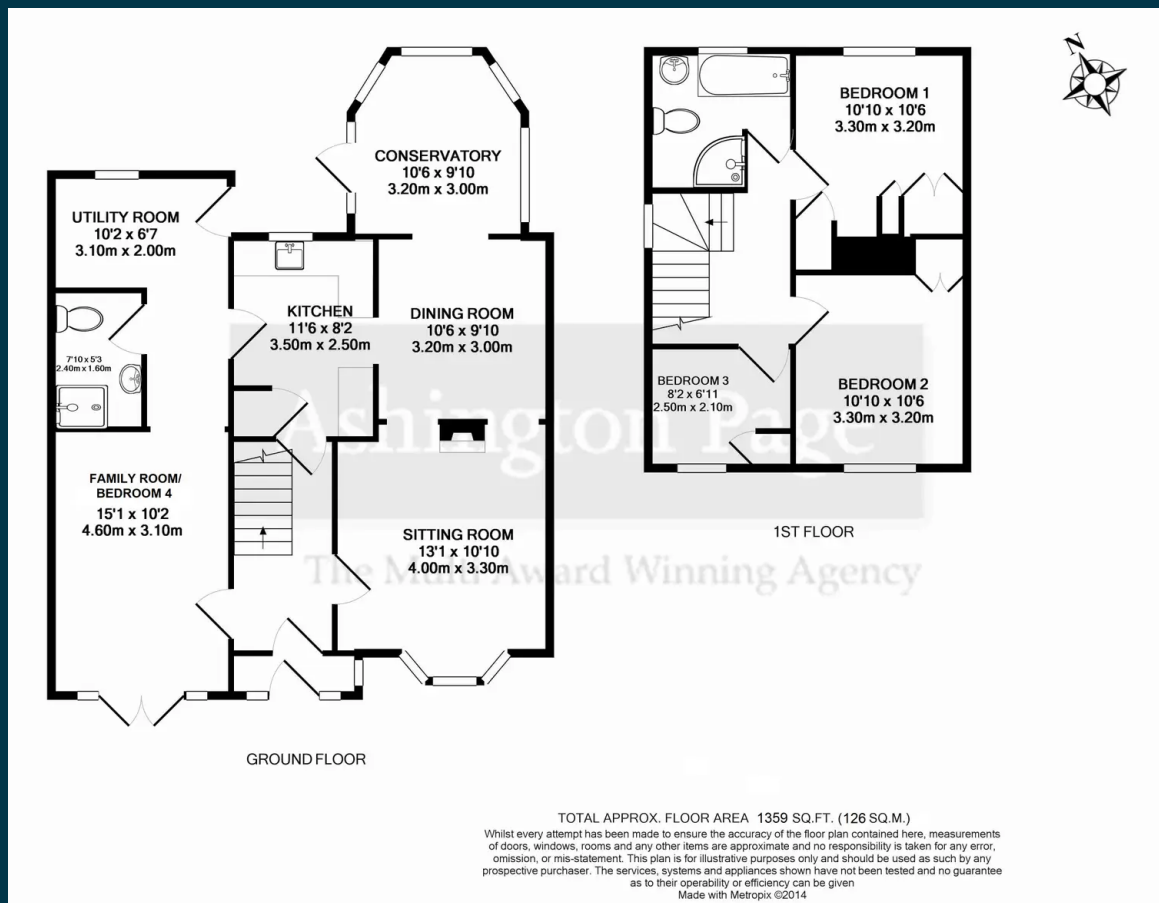

These particulars are for guidance only. They are prepared and issued in good faith and are intended to give a fair summary of the property. Any description should not be relied on as a statement or representation of fact or that the property, or its services, are in good condition. The photographs show only certain parts of the property at the time they were taken. Any areas, measurements or distance given are approximate only. Any reference to alterations to, or use of, any part of the property is not a statement that any necessary planning, building regulations or other consent has been obtained. These matters must be verified by an intending purchaser. All statements contained in these particulars in relation to the property are made without responsibility of Ashington Page or its clients. Neither Ashington Page (nor any joint agents) nor any of their employees has any authority to make or give any representation or warranty whatsoever in relation to the property



01494 680018  
[info@ashingtonpage.co.uk](mailto:info@ashingtonpage.co.uk)  
[www.AshingtonPage.co.uk](http://www.AshingtonPage.co.uk)

