



 **2**
Bedrooms

 **1**
Bathroom

Tenure :
Freehold



Available for sale is this quirky two bedroom mid terrace located on Main Street in Allerton Bywater.

For your viewing please call Tudor Sales & Lettings on 0113 282 3056.

Available for sale is quirky, two bedroom mid terrace home located on Main Street in Allerton Bywater. To a high standard throughout, this is an opportunity not to be missed! the internal layout comprises in brief: ground floor: kitchen diner with access to a cellar. Lounge. First floor: - landing, two bedrooms and a bathroom. Benefits from double glazing and gas central heating. This would make the perfect first home or investment!

Externally, there is a low maintenance garden to the rear with outbuilding. Call Tudor Sales & Lettings today for more information or to arrange a viewing on 0113 282 3056.

Kitchen 12' 54" x 11' 89" (5.03m x 5.61m)

Fitted with a range of wall and base units. Laminated worksurfaces. Integrated oven, gas hob with extractor over. Tiled splashback. Plumbing for washing machine and dishwasher. Tiled flooring. Central heating radiator. Double glazed window. Door leads to cellar.

Lounge 12' 86" x 12' 46" (5.84m x 4.83m)

A tastefully decorated lounge with feature wall panelling. Coving to ceiling. Provisions for wall mounted tv. Central heating radiator. Double glazed window. Handmade shelving hides front door.

Bedroom 1 11' 89" x 12' 57" (5.61m x 5.11m)

Feature wall lights. Coving to ceiling. Central heating radiator. Double glazed window. Storage cupboards.

Bedroom 2 9' 6" x 5' 9" (2.90m x 1.75m)

Laminated flooring. Coving to ceiling. Central heating radiator. Double glazed window.

Bathroom 9' 81" x 6' 25" (4.80m x 2.46m)

Fitted with a three piece suite comprising of: - jacuzzi style bath, vanity unit and a push button wc. Walk in shower. Part tiled walls. Heated towel rail. Double glazed window.

GROUND FLOOR

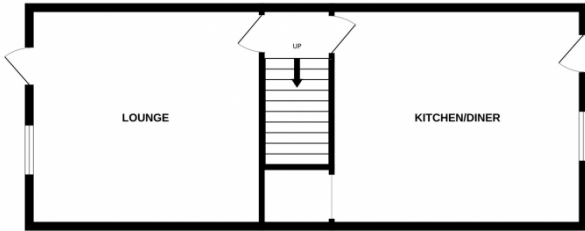

1ST FLOOR

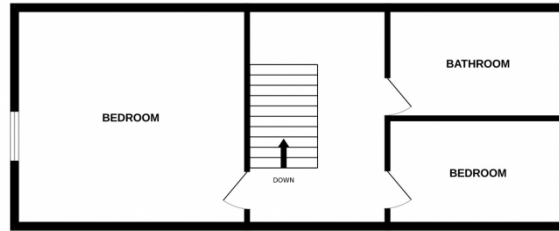

Whilst every attempt has been made to ensure the accuracy of the floorplan contained here, measurements of doors, windows, rooms and any other items are approximate and no responsibility is taken for any error, omission or mis-statement. This plan is for illustrative purposes only and should be used as such by any prospective purchaser. The services, systems and appliances shown have not been tested and no guarantee as to their operability or efficiency can be given.
Made with Metropix ©2023

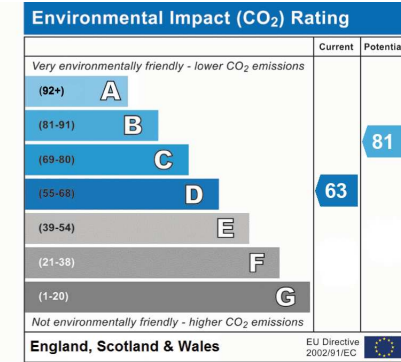
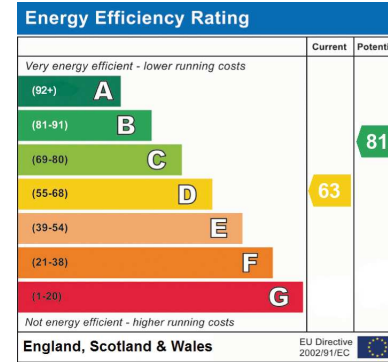

Address: Allerton Bywater, WF10

