

PROPOSED FIRST FLOOR PLAN

33-35 MURRAY STREET, LLANELLI

Ramp Access To Car park

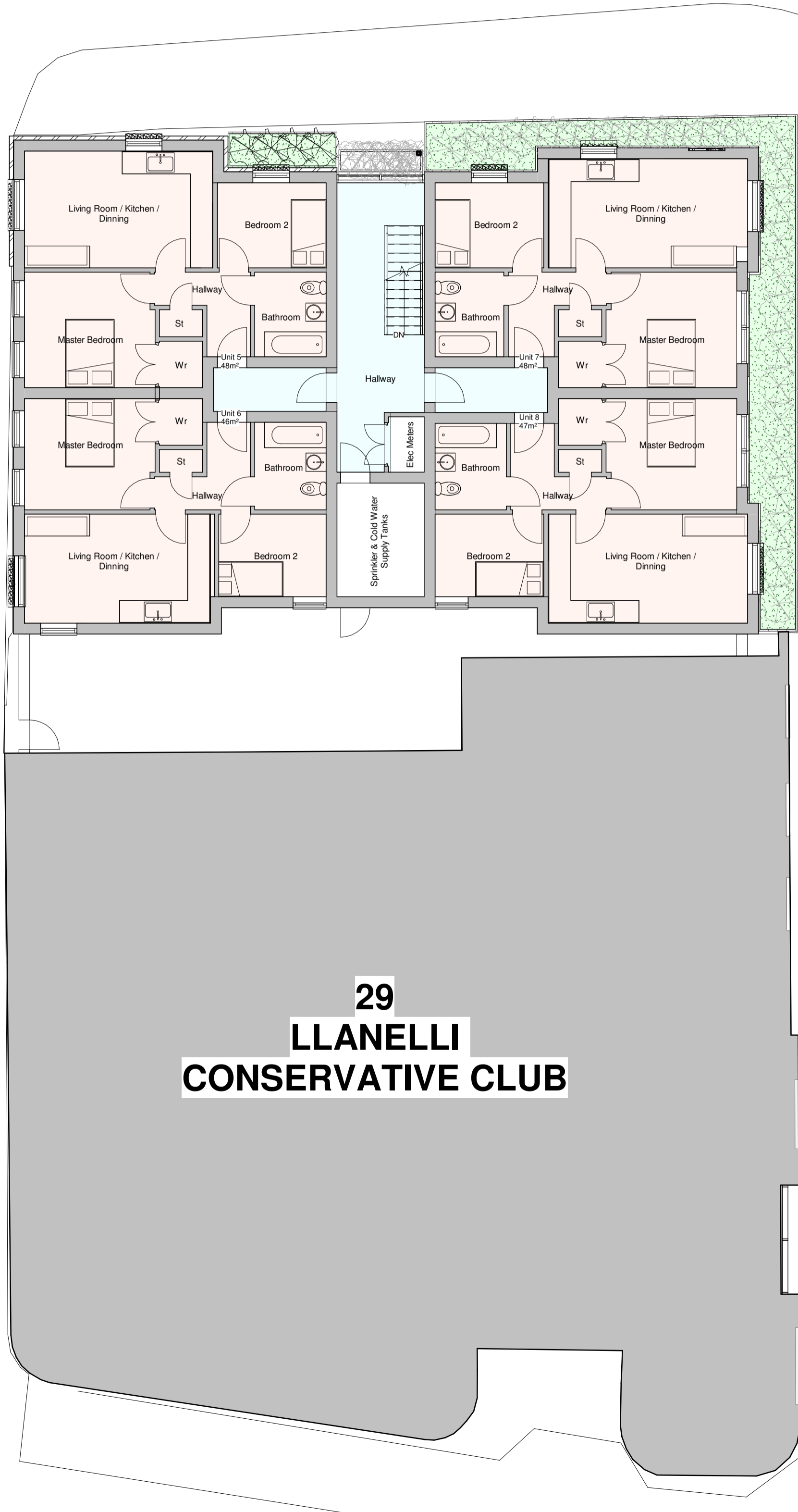
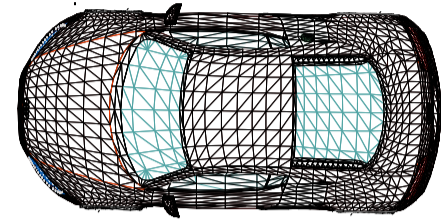

**29
LLANELLI
CONSERVATIVE CLUB**

**MURRAY
'STREET'**

Key:

- Proposed Maintenance Spaces
- Proposed Green Spaces
- Proposed Shared Spaces
- Proposed 2 Bed Apartments

Unit Schedule:

Unit 1	2 Bed Apartment	48m ²
Unit 2	2 Bed Apartment	46m ²
Unit 3	2 Bed Apartment	48m ²
Unit 4	2 Bed Apartment	47m ²
Unit 5	2 Bed Apartment	48m ²
Unit 6	2 Bed Apartment	46m ²
Unit 7	2 Bed Apartment	48m ²
Unit 8	2 Bed Apartment	47m ²
Unit 9	2 Bed Apartment	48m ²
Unit 10	2 Bed Apartment	46m ²
Unit 11	2 Bed Apartment	48m ²
Unit 12	2 Bed Apartment	47m ²
Total:		567m ²

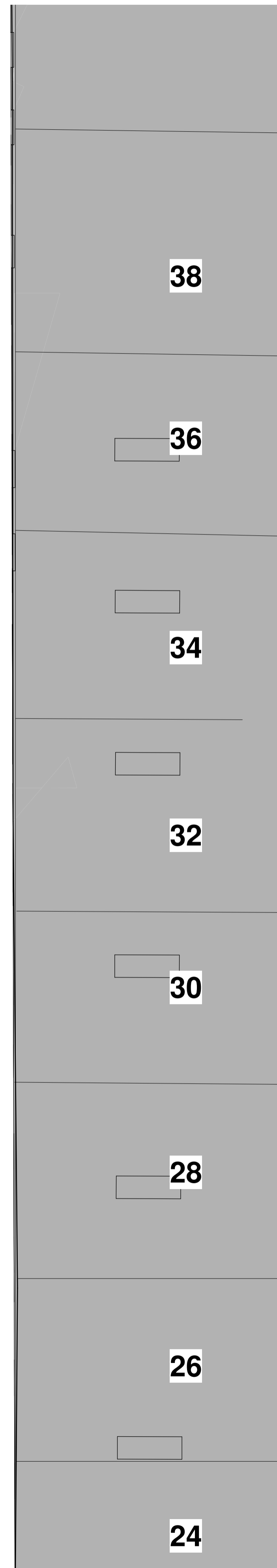

Notes
 This drawing is copyrighted and must not be reproduced or disclosed to third parties without the prior written permission of Prime Architecture Limited.
 Do not scale from this drawing. Responsibility will not be accepted by Prime Architecture Limited for errors made by others scaling from the drawing. Use written dimensions only. Contractor to verify all dimensions before commencing work on site.
 Prime Architecture Limited are to be notified immediately in writing of any discrepancies. All survey information incorporated within the drawings cannot be guaranteed as accurate unless confirmed by a fixed dimension.
 All dimensions are in millimeters unless otherwise noted.
 This drawing is to be read in conjunction with all relevant project drawings and specification prepared by Prime Architecture Limited and other relevant consultants, specialists, etc.
 CDM notes are provided to assist the contractor in managing residual hazards identified during the design stage. Any such notes do not relieve the contractor of their duties and they must provide a safe system of work based on method statements, risk assessments, etc.

Revision:	Description:	Date:

Drawing Status:
PLANNING



Prime Architecture Limited, 3 Llandeilo Road,
 Cross Hands, Llanelli, SA14 6NA
 01269 842 575
 info@prime-arch.co.uk
 www.prim-arch.co.uk
© Prime Architecture Limited

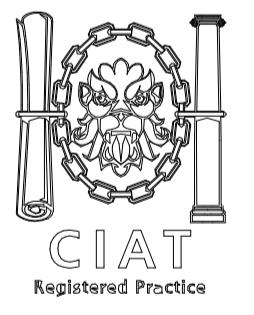

Client:
 Tony Rees

Project Title:
 Proposed Development at 33-35 Murray Street, Llanelli

Drawing Title:
 Proposed First Floor Plan

Scale:
 1:100

Date:
 May 2020

Job No:
 681

Drawing No:
 03

Rev:

First Floor
 1 : 100