

SUMMER ROAD

Lowestoft NR32 2LJ

Energy Efficiency Rating : D

To arrange an accompanied viewing please pop in or call us on 01603 336226

PROPERTY
TO LET

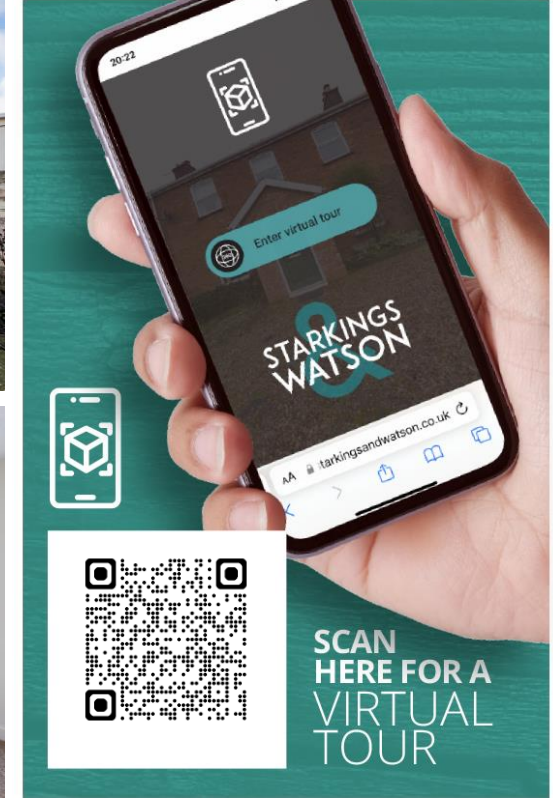

arla | propertymark
PROTECTED

naea | propertymark
PROTECTED

The Property
Ombudsman

For our full list of available properties, or
for a FREE INSTANT online valuation visit

starkingsandwatson.co.uk

BEST
ESTATE AGENT GUIDE
AWARDS 2023
WINNER
(HONOURS)
AWARDED FOR
MARKETING | SERVICE | RESULTS

BEST
ESTATE AGENT GUIDE
AWARDS 2023
WINNER
LETTINGS
AWARDED FOR
MARKETING | SERVICE | RESULTS

STARKINGS
WATSON

- Mid-Terrace Home
- Open Plan Living
- 19' Sitting/Dining Room
- Modern Fitted Kitchen
- Family Bathroom with Shower
- Two Double Bedrooms
- New Flooring & Decor
- Courtyard Gardens

IN SUMMARY

This MODERNISED mid-terrace home benefits from gas fired CENTRAL HEATING and uPVC double glazing, the property offers an OPEN PLAN LAYOUT for functional family living. The ground floor offers a 19' SITTING/DINING ROOM, modern fitted kitchen, rear lobby and family bathroom. The first floor offers TWO BEDROOMS off the landing. To the rear, a COURTYARD STYLE GARDEN can be found for ease of maintenance.

SETTING THE SCENE

Occupying a town centre terraced location, a courtyard frontage with a low level brick wall and wrought iron railings encloses the garden. On road residents parking can be found outside.

THE GRAND TOUR

Step in the uPVC double glazed entrance door, you walk straight into the open plan sitting/dining room with a feature fireplace. The room is finished with central heating and a uPVC double glazed dual aspect window to front and rear. Stairs lead upstairs, and an

opening leads to the modern fitted kitchen with space for appliances. Tiled splash backs can be found around the work surfaces, with a window to side and wall mounted gas fired central heating boiler. A further opening leads to a rear lobby, with a door to the partly tiled family bathroom, with a mixer shower tap over the bath. Upstairs, the stairs lead to a small landing, with doors to the two bedrooms and one with a built-in storage cupboard.

THE GREAT OUTDOORS

The hard standing courtyard is perfect for easy maintenance, and offers a timber storage shed and rear access gate.

OUT & ABOUT

Lowestoft is a seaside town located to the North-East of Suffolk. With sandy beaches and many enjoyable seaside and historical walks, Lowestoft offers something for everyone. Lowestoft seafront provides a traditional seaside experience including a vast variety of places to dine and shop. Lowestoft has a rich Maritime history and offers easy access to the Norfolk Broads network of waterways which can be found at Oulton Broad.

FIND US

Postcode : NR32 2LJ

What3Words : ///decent.squad.formal

VIRTUAL TOUR

View our virtual tour for a full 360 degree of the interior of the property.



To arrange an accompanied viewing please call our Centralised Hub on **01603 336116**



Disclaimer: Whilst every care has been taken to prepare these sales particulars, they are for guidance purposes only. All measurements are approximate and are for general guidance purposes only and whilst every care has been taken to ensure their accuracy, they should not be relied upon and potential buyers are advised to recheck the measurements.

Price:



For our full list of available properties, or for a FREE INSTANT online valuation visit

starkingsandwatson.co.uk



Ground Floor

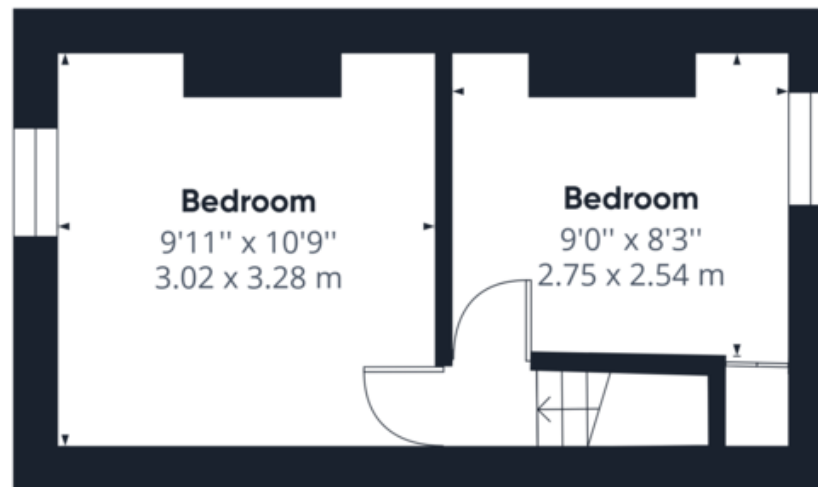

Floor 1

Approximate total area⁽¹⁾

502.89 ft²

46.72 m²

Reduced headroom

5.19 ft²

0.48 m²

(1) Excluding balconies and terraces

 Reduced headroom
(below 1.5m/4.92ft)

While every attempt has been made to ensure accuracy, all measurements are approximate, not to scale. This floor plan is for illustrative purposes only.

GIRAFFE 360