



38 Elstree Apartments 72 Grove Park, London, NW9 0FF

Asking Price £295,000

Benjamin Stevens are pleased to present this modern chain free studio in Elstree Apartments. This studio would make an ideal first time buy or investment, it is conveniently located 0.5 miles away from Colindale tube station and is also a short walk from local amenities such as, The Gym and Colindale Retail Park.

Accommodation comprises a spacious bedroom area with direct access to the open plan reception and modern kitchen. There is a luxury fitted bathroom plus the bonus of a utility cupboard housing the washing machine.

Lease- 995 years remaining
Ground Rent- £300
Service Charge- £1,200

To arrange a viewing please contact sole agents Benjamin Stevens.

Bedroom



Bathroom



Open Plan Reception Area



Side Aspect



Kitchen



Floor Plan

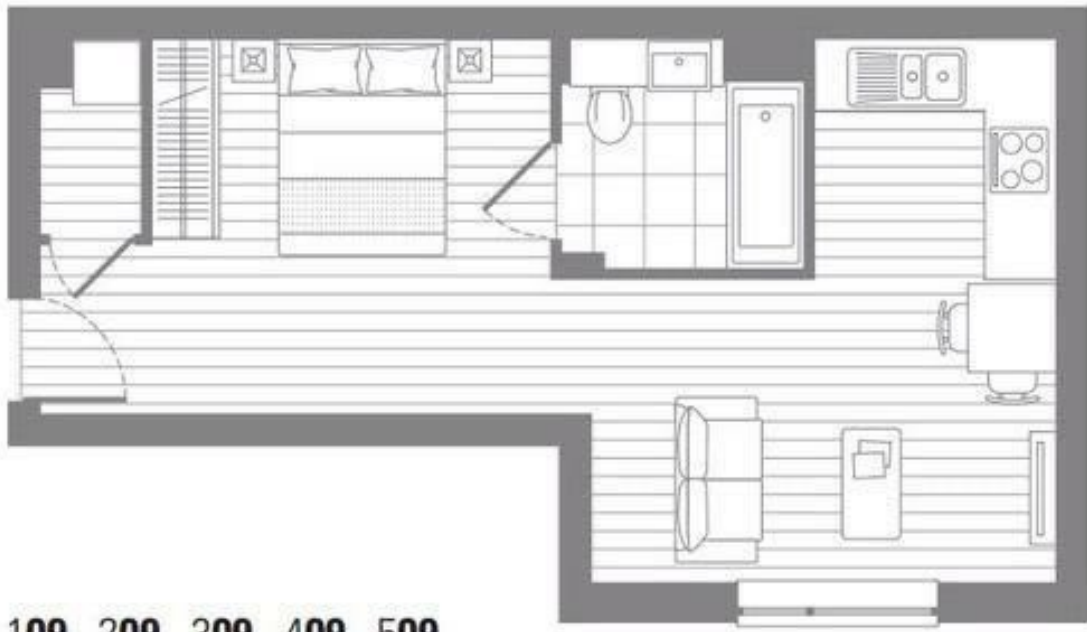

109 209 309 409 509

Suite

Living area	4.2 x 2.7m	13'8" x 8'10"
Kitchen area	3.6 x 3.3m	11'9" x 10'9"
Bedroom area	2.1 x 2.1m	6'10" x 6'10"

Internal area 37.3 sq.m. 401 sq.ft.

Area Map



Energy Efficiency Graph

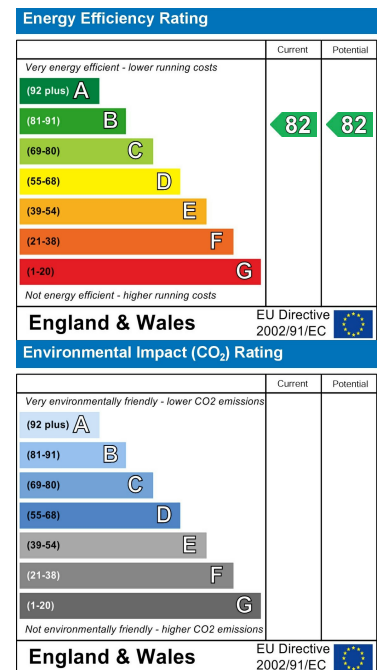

These particulars, whilst believed to be accurate are set out as a general outline only for guidance and do not constitute any part of an offer or contract. Intending purchasers should not rely on them as statements of representation of fact, but must satisfy themselves by inspection or otherwise as to their accuracy. No person in this firm's employment has the authority to make or give any representation or warranty in respect of the property.



Edgware Office- 194 Station Road, Edgware, HA8 7AT. Tel: 020 8958 1118
 Bushey Heath Office- 59 High Road, Bushey, WD23 1EE. Tel: 020 8950 7777
www.benjaminstevens.co.uk