

**TO LET**



## **The Globe, Guisborough**

2 Bedrooms, 1 Bathroom, Upper Floor Apartment

**£750 pcm**



## The Globe, Guisborough

2 Bedrooms, 1 Bathroom

**£750 pcm**

Date available: Available Now

Deposit: £750

Furnished

Council Tax band: A

- New Build First Floor Apartment
- Integrated Appliances
- Modern Kitchen
- Open Plan Living
- Fitted Wardrobes
- Great Location
- Parking Permit

FULL DESCRIPTION Martin and Co are pleased to welcome to the market this TWO Bedroom, FULLY FURNISHED apartment, located at the Globe. Recently renovated, this first floor apartment is within walking distance of the town centre. Briefly comprising; communal entrance, hallway, kitchen / lounge, two bedroom's and large bathroom. The property also benefits from having provided permit parking and a PRIVATE garden. Call now to book a viewing.

INTERNAL

FIRST FLOOR APARTMENT

HALLWAY 13'2 x 3'3 1 x Radiator, Storage Cupboard and Karndeem Flooring.

LIVING ROOM/KITCHEN 12'3 x 18'10 Open Plan, Window front elevation, carpet flooring and 1 x radiator.

KITCHEN Modern navy fitted kitchen wall & base units, integrated fridge/freezer and washing machine. Karndeem flooring, electric oven and hob, extractor fan, breakfast bar and gas combi boiler.





BEDROOM 9'7 x 10'10 Fitted robes, carpet flooring, 1 x side elevation window and 1 x radiator

BEDROOM 8'9 x 9'4 Fitted robes, carpet flooring, 1 x side elevation window, 1 x radiator and shelving

BATHROOM 7'0 x 8'4 Heated towel rail, w/c, wash hand basin, bath, shower, spot lights and 1 x side elevation window.

EXTERNAL Communal entrance, parking permit and patio/garden area to the rear.





%epcGraph\_c\_1\_441%





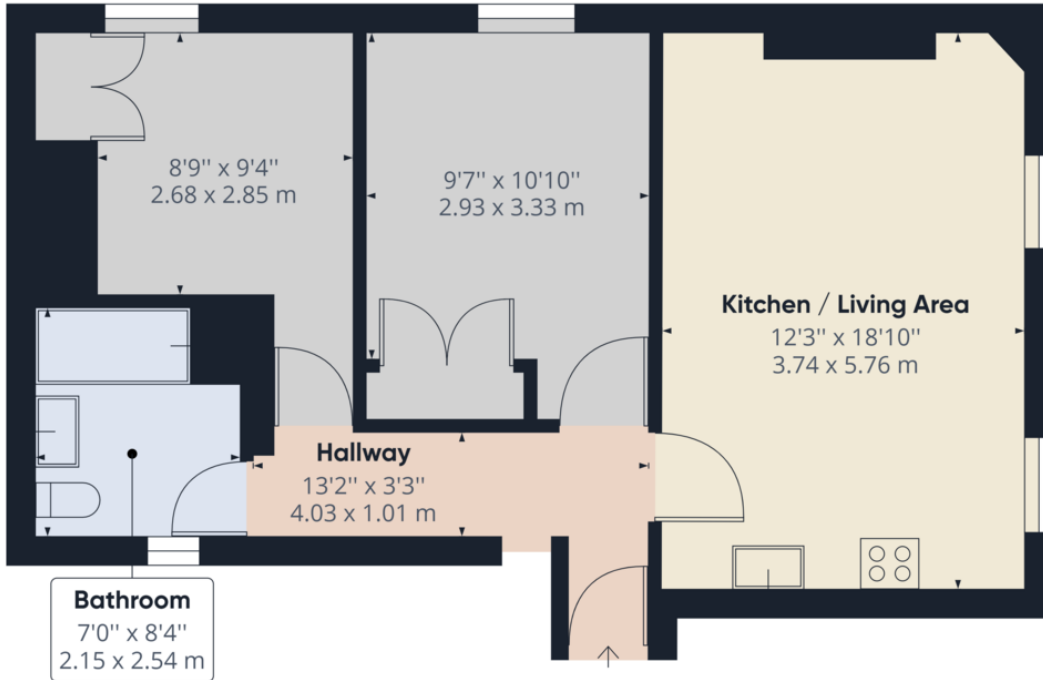

Approximate total area<sup>(1)</sup>  
 574.38 ft<sup>2</sup>  
 53.36 m<sup>2</sup>

(1) Excluding balconies and terraces

While every attempt has been made to ensure accuracy, all measurements are approximate, not to scale. This floor plan is for illustrative purposes only.

GIRAFFE360

## Martin & Co Guisborough

83 Westgate • Guisborough • TS14 6AF

T: 01287 631254 • E: [Guisborough@martinco.com](mailto:Guisborough@martinco.com) <http://www.martinco.com>

# 01287 631254



**Accuracy:** References to the Tenure of a Property are based on information supplied by the Seller. The Agent has not had sight of the title documents. A Buyer is advised to obtain verification from their Solicitor. Items shown in photographs including but not limited to carpets, fixtures and fittings are not included unless specifically mentioned within the sales particulars. They may however be available by separate negotiation. Buyers must check the availability of any property and make an appointment to view before embarking on any journey to see a property. No person in the employment of the agent has any authority to make any representation about the property, and accordingly any information given is entirely without responsibility on the part of the agents, sellers(s) or lessors(s). Any property particulars are not an offer or contract, nor for part of one. **Sonic / laser Tape:** Measurements taken using a sonic / laser tape measure may be subject to a small margin of error. **All Measurements:** All Measurements are Approximate. **Services Not tested:** The Agent has not tested any apparatus, equipment, fixtures and fittings or services and so cannot verify that they are in working order or fit for the purpose. A Buyer is advised to obtain verification from their Solicitor or Surveyor.

