

32 Abbott Way, Holbrook, Ipswich, IP9 2FF



Freehold

Guide Price

£325,000

Subject to contract

Parking

3 bedrooms
Sitting room, kitchen/dining room
En-suite and bathroom



This three bedroom semi-detached family home offers a spacious kitchen/ dining room along with an en-suite and family bathroom

Some details

General information

Built in 2018 within the desirable village of Holbrook is this ideal family home offering a sitting room along with a spacious kitchen/dining area to the rear. It offers parking, en-suite shower room, bathroom and a ground floor WC.

The reception hall has stairs to the first floor and a door to the sitting room which has a window to the front and doors to the kitchen/dining area and the cloakroom with WC and basin. The kitchen/dining room has a window and door to the rear garden and a cupboard under the stairs. The kitchen area comprises matching base and eye level units, work tops, sink and integrated appliances include dishwasher, washing machine, fridge/freezer, electric double oven, hob and extractor hood over. There is decorative kick-board lighting and tiled floor.

The landing provides access to all bedrooms and the family bathroom. Bedrooms two and three are located to the rear. Bedroom one is located to the front and has a door to an en-suite with shower, basin, WC, heated towel rail and a window to the front. The family bathroom comprises a bath with shower over, WC, basin, heated towel and part-tiled surround.

Reception hall

Sitting room

13' 11" x 12' 1" (4.24m x 3.68m)

Kitchen/dining room

15' 6" x 9' 5" (4.72m x 2.87m)

Cloakroom

6' 1" x 3' 4" (1.85m x 1.02m)

Landing

Bedroom one

9' 8" x 9' 3" (2.95m x 2.82m)

Ensuite

5' 9" x 5' 6" (1.75m x 1.68m)

Bedroom two

10' 10" x 8' 7" (3.3m x 2.62m)

Bedroom three

11' 8" x 6' 7" (3.56m x 2.01m)

Bathroom

6' 7" x 5' 6" (2.01m x 1.68m)

Outside

To the front there is a hard standing area providing parking and a path leading to the front door along with side access.

The rear garden is predominantly laid to lawn with shingled borders with patio area. The garden is enclosed by fencing.

Location

Holbrook is on the Shotley Peninsular to the south of Ipswich with easy access to the Rivers Orwell and Stour where there a number of sailing facilities in addition to Alton Water. Holbrook village has a range of amenities including public houses, shops and a doctors surgery along with a bus service into Ipswich.

For the commuter Ipswich and Manningtree Mainline railway stations are easily accessible offering a service to London Liverpool Street.

Important information

Council Tax Band - C

Services - We understand that mains water, drainage and electricity are connected to the property.

Tenure - Freehold

EPC rating - C

Our ref - RMB

Directions

From Ipswich town centre proceed out in a southerly direction along Wherstead Road and turn left at the Bourne Bridge roundabout onto the B1456 towards Shotley. Continue along The Strand with the River Orwell on your left and through Freston village, take the right hand fork signposted for Holbrook and continue along. Just as you enter the village, the development known as Admirals Quarter will be seen on the left, take a left on Abbott Way and continue along. After a short distance take the first right, still into Abbott Way, where the property can be found on the right hand side identified by a Fenn Wright board.

Further information

If you would like more information on this property and its surrounding location (schools, transport etc) please get in touch.

fennwright.co.uk

Viewing

To make an appointment to view this property please call us on 01473 232 700



GROUND FLOOR
414 sq.ft. (38.4 sq.m.) approx.

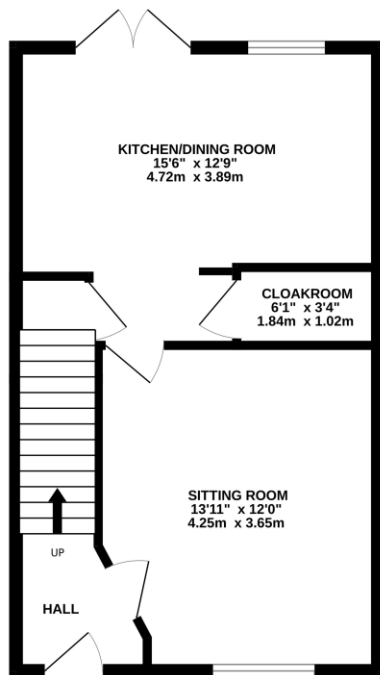

1ST FLOOR
414 sq.ft. (38.5 sq.m.) approx.

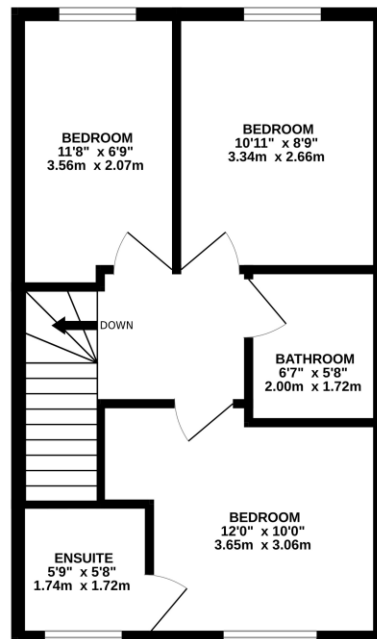

To find out more or book a viewing

01473 232 700

fennwright.co.uk

Fenn Wright is East Anglia's leading, independently owned firm of chartered surveyors, estate agents and property consultants.

- Residential and Commercial Sales and Lettings
- Development, Planning and New Homes
- Farms & Estates Agency and Professional Services
- Water & Leisure Agency and Professional Services
- Mortgage valuations

Consumer Protection Regulations 2008

Fenn Wright has not tested any electrical items, appliances, plumbing or heating systems and therefore cannot testify that they are operational. These particulars are set out as a general outline only for the guidance of potential purchasers or tenants and do not constitute an offer or contract. Photographs are not necessarily comprehensive or current and all descriptions, dimensions, references to condition necessary permissions for use and occupation and other details are given in good faith and believed to be correct but should not be relied upon as statements of, or representations of, fact. Intending purchasers or tenants must satisfy themselves by inspection or otherwise as to the correctness of each of them. We have taken steps to comply with Consumer Protection Regulations 2008, which require both the seller and their agent to disclose anything, within their knowledge, that would affect the buying decision of the average consumer. If there are any aspects of this property that you wish to clarify before arranging an appointment to view or considering an offer to purchase please contact us and we will make every effort to be of assistance.

Fenn Wright, as part of their service to both vendor and purchaser, offer assistance to arrange mortgage and insurance policies, legal services, energy performance certificates, and the valuation and sale of any property relating to any purchaser connected to this transaction. Fenn Wright confirms they will not prefer one purchaser above another solely because he/she has agreed to accept the offer of any other service from Fenn Wright. Referral commission (where received) is in the range of £15 to £750.

Fenn Wright is a Limited Liability Partnership, trading as Fenn Wright. Registered in England under no. OC431458. Registered office: 1 Tollgate East, Stanway, Colchester, Essex, CO3 8RQ. A list of members is open to inspection at our offices.

