



ASHLEY ROAD, WESTCOTT RH4 3QJ  
**OFFERS IN EXCESS OF £450,000**





**Ashley Road, RH4**

Approximate Gross Internal Area = 72.9 sq m / 785 sq ft  
 Summer House = 7.0 sq m / 75 sq ft  
 Shed / Workshop = 4.1 sq m / 44 sq ft  
 Total = 84 sq m / 904 sq ft

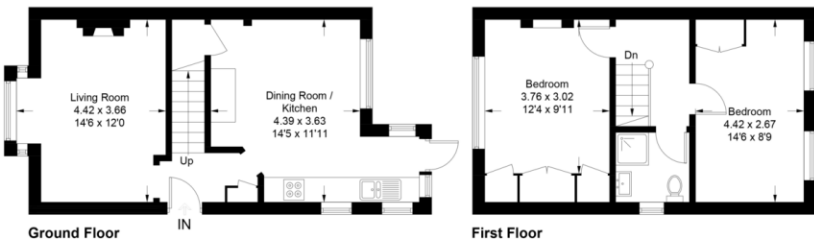
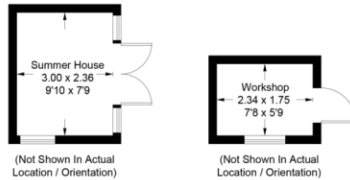

This plan is for layout guidance only. Not drawn to scale unless stated. Windows and door openings are approximate. Whilst every care is taken in the preparation of this plan, please check all dimensions, shapes and compass bearings before making any decisions reliant upon them. (ID948332)

Score	Energy rating	Current	Potential
92+	A		
81-91	B		81   B
69-80	C		
55-68	D	55   D	
39-54	E		
21-38	F		
1-20	G		

**CONTACT**

Cummins House, 62  
 South Street, Dorking,  
 Surrey, RH4 2HD

[www.seymours-estates.co.uk](http://www.seymours-estates.co.uk)  
[sales@seymours-dorking.co.uk](mailto:sales@seymours-dorking.co.uk)  
 01306 776674

Agents Note: Whilst every care has been taken to prepare these sales particulars, they are for guidance purposes only. All measurements are approximate and for general guidance only and whilst every care has been taken to ensure their accuracy, they should not be relied upon and potential buyers are advised to recheck the measurements.

