



First-floor Modern Apartment

£2,000 per calendar month

This stunning one-bedroom flat with a private terrace is a short walk from Whitechapel Elizabeth Line. Comprising a double bedroom, open-plan kitchen/living room, three-piece bathroom suite, private terrace, and entrance currently being used as a home office.

- Private Terrace
- Modern Apartment
- Fully Fitted Kitchen
- Three Piece Bathroom Suite
- Space for a Home Office
- Short walk to Whitechapel Elizabeth Line & Shadwell DLR

Council Tax Band B

EPC Rating C (78)

Borough: Tower Hamlets

Viewings by appointment only

info@netlettings.com

0208 981 5551



APPROXIMATE FLOOR AREA = 495 SQ FT / 46.0 SQ M
INCLUDING LIMITED USE AREA (19 SQ FT / 1.8 SQ M)



 = REDUCED HEAD HEIGHT BELOW 1.5M

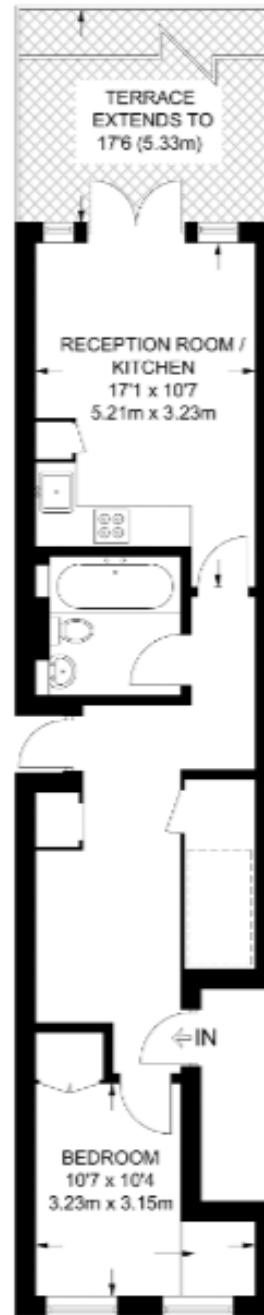

FIRST FLOOR

Location & Transport



36 mins walk to Canary Wharf



27 mins walk to Liverpool Street



31 mins walk to Bank



Aldgate East Underground 0.8 miles | 17 mins walk



Whitechapel Underground -0.5 miles | 11 mins walk



Shadwell DLR -0.3 miles | 7 mins walk



13 mins to Liverpool Street - Watney Market (Stop E)



16 mins to Bank - Watney Market (Stop E)



15 mins to Canary Wharf - Watney Market (Stop F)

