



Bassenthwaite

Offers in the region of £325,000

1 Low Kiln Court, Bassenthwaite, Keswick, Cumbria, CA12 4RG

A modern two bedroom cottage style end terrace house enjoying a delightful rural setting with views to the fells. Located one mile from Bassenthwaite village and seven miles from Keswick, this most appealing house is equally suitable as a primary home, second home or for lucrative holiday letting.

Quick Overview

Most appealing modern cottage style
end terrace house
Delightful rural setting
Front view to the fells
One mile from Bassenthwaite village
Seven miles from Keswick
Two double bedrooms
Shared communal grounds, courtyard
and parking space
Equally suitable as a primary home,
second home or lucrative holiday let



2



1



1



F



Superfast
80 Mbps



1

Property Reference: KW0245



Living / Dining Room



Living / Dining Room



Kitchen



Bedroom One

Bassenthwaite village provides a wide range of amenities include a primary school, church, shop and public houses. Nearby facilities include Bassenthwaite Lake and sailing club, a first class leisure complex and spa at Armathwaite Hall Hotel, Lakes Distillery, Lake District Wildlife Park, Mirehouse country house and gardens and Honister Slate Mine. Numerous fell walks are close by including Skiddaw and Ullock Pike.

Located sixteen miles from the M6 Penrith junction 40, Keswick provides an extensive range of local amenities and services including a variety of shops, supermarkets, cafes and public houses together with hotels, banks, schools, library, theatre and medical and dental surgeries. Penrith railway station includes a west coast mail line direct service to London.

Accommodation

Ground Floor:

Open Plan Living / Dining Room 20' 1" max x 14' 2" max (6.12m x 4.32m)

With delightful fell views, two electric heaters, feature brick fireplace with electric fire.

Kitchen 8' 9" x 7' 6" (2.67m x 2.29m)

With fitted base and wall units, sink unit, ceramic wall tiling, integrated oven, hob and extractor unit, plumbing for washing machine, electric heater.

First Floor:

Landing

With electric heater.

Bedroom One 15' max x 10' 10" max (4.57m x 3.3m)
Front bedroom with delightful fell views, electric heater.

Bedroom Two 18' 5" max x 8' 10" max (5.61m x 2.69m)
Rear bedroom with electric heater.

Bathroom

With WC, wash hand basin, bath with shower over, ceramic wall tiling, electric heater, fan heater, built in airing cupboard.

Outside:

Shared surrounding communal grounds, courtyard and car parking. Shared external store.

Tenure

Leasehold.

Council Tax.

Band D.

Services

Mains water and electricity. Electric storage heating. Klargester treatment plant drainage.

Directions

From the Keswick Crosthwaite roundabout proceed to the A591 towards Bassenthwaite and continue for approximately seven miles. The entrance to Low Kiln Court is situated on the right before reaching the cross roads at the Castle Inn.

Viewings

By appointment with Hackney & Leigh's Keswick office.

Price

£325,000 region.



Bedroom Two



Bedroom Two



Bathroom



View

1 Low Kiln Court, Bassenthwaite, Keswick

Approximate Area = 844 sq ft / 78.4 sq m

For identification only - Not to scale

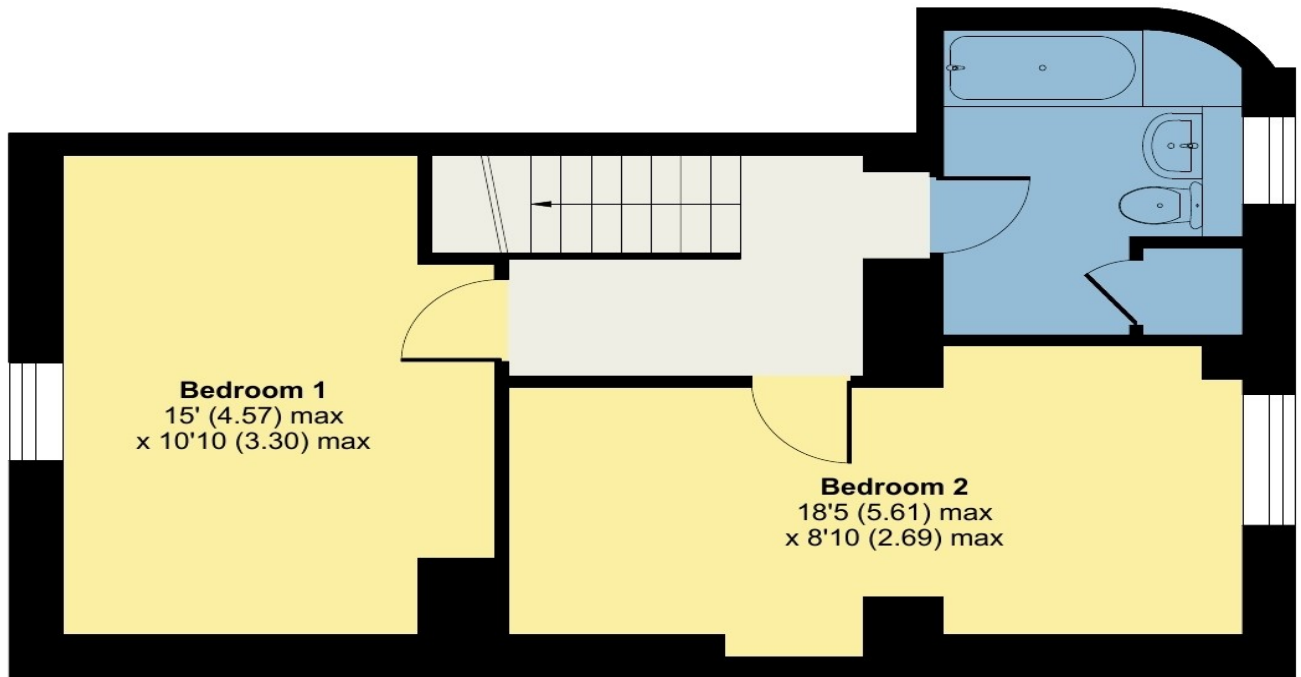

FIRST FLOOR



GROUND FLOOR



Floor plan produced in accordance with RICS Property Measurement Standards incorporating International Property Measurement Standards (IPMS2 Residential). © nīchecom 2023. Produced for Hackney & Leigh. REF: 965391

All permits to view and particulars are issued on the understanding that negotiations are conducted through the agency of Messrs. Hackney & Leigh Ltd. Properties for sale by private treaty are offered subject to contract. No responsibility can be accepted for any loss or expense incurred in viewing or in the event of a property being sold, let, or withdrawn. Please contact us to confirm availability prior to travel. These particulars have been prepared for the guidance of intending buyers. No guarantee of their accuracy is given, nor do they form part of a contract. Broadband speeds estimated and checked by <https://checker.ofcom.org.uk/en-gb/broadband-coverage> on 03/04/2023.

Request a Viewing Online or Call 01768 741741