



Property Summary

Offered with no upward chain. This versatile three bedroom semi detached family home has undergone complete refurbishment by the current owner and is situated on arguably the largest street plot and nestled in the highly sought after village location of Queniborough. The accommodation comprises of entrance hall, lounge and diner, conservatory, recently fitted kitchen, ground floor bedroom three, refurbished ground floor bathroom, landing to two bedrooms, front and rear landscaped gardens, ample car standing space with carport.



GROUND FLOOR
605 sq.ft. (56.2 sq.m.) approx.

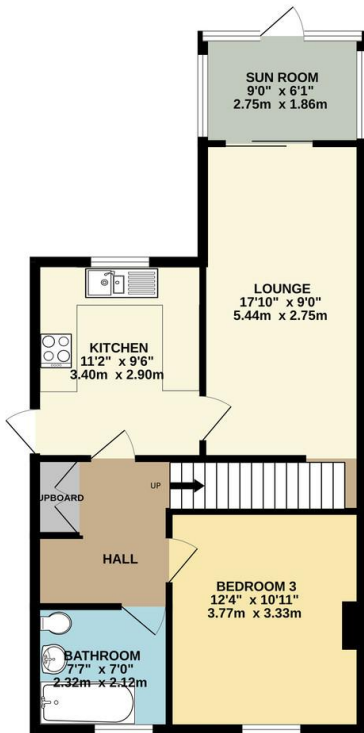

1ST FLOOR
435 sq.ft. (40.4 sq.m.) approx.

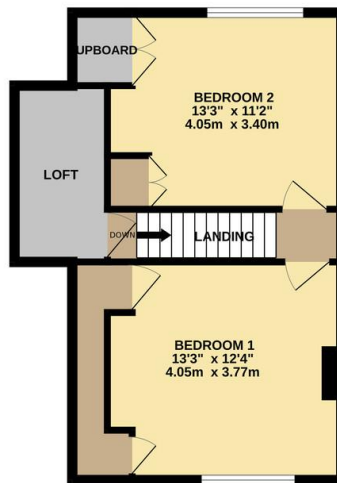

TOTAL FLOOR AREA: 1040 sq.ft. (96.6 sq.m.) approx.
Whilst every attempt has been made to ensure the accuracy of the floorplan contained here, measurements of doors, windows, rooms and any other items are approximate and no responsibility is taken for any error, omission or mis-statement. This plan is for illustrative purposes only and should be used as such by any prospective purchaser. The services, systems and appliances shown have not been tested and no guarantee as to their operability or efficiency can be given.
Made with Metropix ©2023

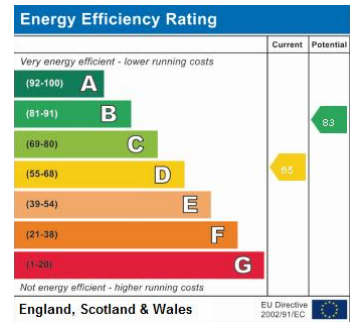

- Semi Detached
- Three Bedrooms
- Versatile Accommodation
- Highly Desirable Village Location
- Refurbished
- New Kitchen
- New Bathroom
- Substantial Rear Garden

phillips george | sales & lettings

Agents Note: Whilst every care has been taken to prepare these sales particulars, they are for guidance purposes only. All measurements are approximate and for general guidance purposes only and whilst every care has been taken to ensure their accuracy, they should not be relied upon and potential buyers are advised to recheck the measurements

46 Long Street, Wigston, Leicestershire, LE18 2AH

info@phillipsgeorge.co.uk
0116 216 8178

